



819727

Open End Interchangeable Head For Torque Wrench, 1-1/2"





PRODUCT DETAILS

• Heads 1 1/4" and less: 1 7/16" Common Centerline / 36.5 mm Common Centerline

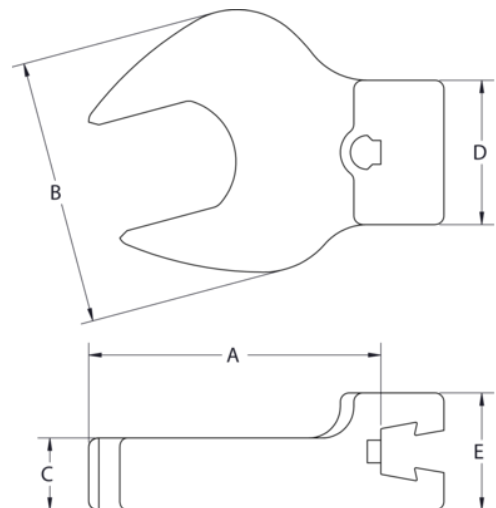
• Heads 1 5/16" and more: 3 7/8" Common Centerline / 98.4mm Common Centerline



PRODUCT ATTRIBUTES

| Product | MODEL    |  |  | <b>A</b>   | <b>B</b>   | <b>C</b> | <b>D</b> | <b>E</b> |
|---------|----------|---|---|------------|------------|----------|----------|----------|
| 819727  | OE 1 1/2 | 4800 lbf-in   | 1-1/2 in  | 4-19/32 in | 2-15/16 in | 5/8 in   | 1-1/2 in | 1 in     |