



819357
ROE 11/16 Head - V Series



PRODUCT DETAILS

- 1 7/16" Common Centerline / 36.5 mm Common Centerline
- Slight disengagement from the fastener allows operator to rapidly rotate wrench

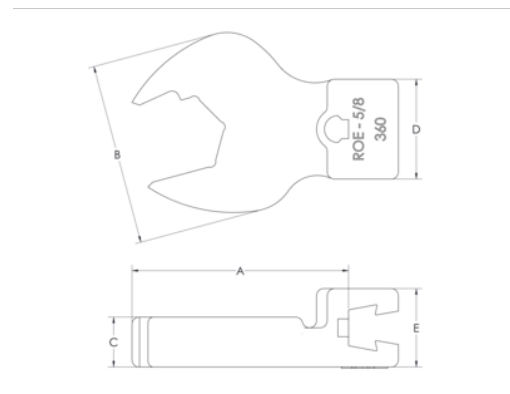

PRODUCT ATTRIBUTES

Product	MODEL		A	B	C	D	E	
819357	ROE 11/16 Head - V Series	11/16 in	1.875 in	1.5938 in	.4375 in	.75	.6875	480 lbf-in