

## So-PowerPoint PP-VIP10-3,5t-M24X1,5 with variable length

Artikel-Nr: 8600323



Thread reach from  $F = 24-95$  mm is available. (with through thread)

When ordering implicitly indicate the required length.

Connection only with RUD approved components e.g; VCÖH-10, oval link, PP 3,5t or the 10 mm VIP chain.

Hint : The VIP chain connection is fool proof. When assembling the components, pay attention to the correct WLL allocation.

- **Can be combined with most commercial lifting means without additional connecting element.**
- **Lifting points pivots 360°.**
- **Large distance between bolt-on surface and load to avoid damage.**
- **Rotatable at nominal WLL, 90° to the bolt-on direction**Lowest kinking possibility due to cardan joint.
- **Suspension ring with enlarged pivoting area.**
- Clear marking of the minimum WLL for all loading directions.
- Variable thread lengths are available for use of threaded holes and through hole fixtures.
- Non removable special bolt (this reduces the risk of non standard bolts).
- Component according to the test criterias of BG/DGUV "GS-HM 36".
- Quick and easy installation with just one bolt connection.
- Hand tightening with appropriate wrench is sufficient for a singular lift.
- Please observe torque instructions when lifting point is permanently installed resp. at constant swivelling operations and tilting/ turning actions.

Other important RUD specific information and specialities to our RUD lifting points can be found in the specific user instruction.

## So-PowerPoint PP-VIP10-3,5t-M24X1,5 with variable length

Artikel-Nr: 8600323

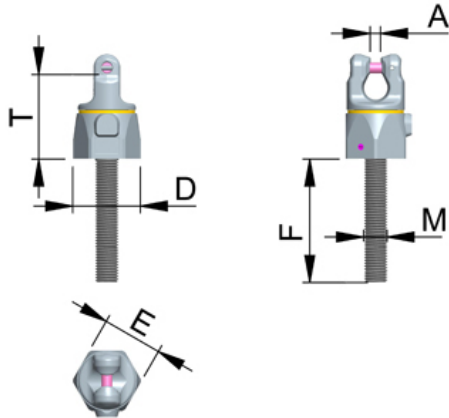

<b>A</b>	10 mm	13/32"
<b>D</b>	81 mm	3-3/16"
<b>E</b>	70 mm	2-3/4"
<b>F</b>	24-95 mm	1" to 3-3/4"
<b>M</b>	M24X1,5 mm	M24x1,5
<b>weight</b>	0.00 kg	null
<b>Nominal WLL</b>	3500 kg	7700 lbs
<b>T</b>	94 mm	3-11/16"