

Eye Plate for bolting RBG-3 with variable length

Artikel-Nr: 8600318



Load ring threaded with full working load in all directions and split force introduction. Thread lengths of $L = 25\text{-}205\text{mm}$ are available. When ordering implicitly indicate the required length.

- Split force introduction due to multiple point fixing.
- Suspension ring pivots 180° .
- 100% WLL at 90 degrees in the load ring plane possible.
- Clear marking of the minimum WLL for all loading directions.
- Original RUD bolt available as spare part.
- Component according to the test criterias of BG/DGUV "GS-HM 36".
- Assembly with flat / ring wrench or allen key possible.
- Hand tightening with appropriate wrench is sufficient for a singular lift.
- Please observe torque instructions when lifting point is permanently installed resp. at constant swivelling operations and tilting/ turning actions.

Other important RUD specific information and specialities to our RUD lifting points can be found in the specific user instruction.

Eye Plate for bolting RBG-3 with variable length

Artikel-Nr: 8600318

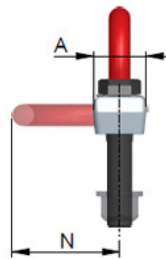
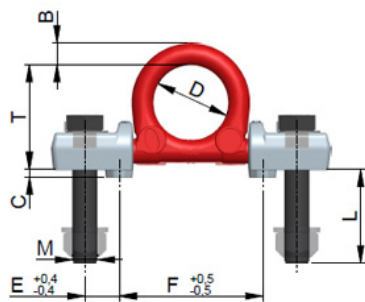

Nominal WLL	3000 kg	6610 lbs
T	67 mm	2-5/8"
A	34 mm	1-11/32"
B	16 mm	5/8"
C	5 mm	13/64"
D	48 mm	1-7/8"
E	22 mm	7/8"
F	92 mm	3-5/8"
G	6 mm	15/64"
H	18 mm	23/32"
I	30 mm	1-3/16"
K	1 mm	3/64"
L	25-205 mm	1"-8"
N	71 mm	2-13/16"