

STARPOINT VRS-1,5t-G1"

Artikel-Nr: 7999163



Vario-Starpoint VRS with adapter to pipe thread G1" DIN ISO 228-1.

- Lifting points pivots 360°. Easy adjustment in load direction.
- Not exchangeable RUD-Bolt (this reduces the usage of improper standard bolts).
- Clear marking of the minimum WLL for all loading directions. Higher WLL possible when location and installation is optimised (compare WLL chart / product information).
- Clear marking at the bolt head: RUD, thread size, batch-no.
- Variable bolt lengths available for tapped or through holes.
- Available as: - Standard Metric Thread (DIN EN 13) - Metric Fine Thread (DIN EN 13) - Coarse Pitch Thread UNC (ANSI B1.1) - Fine Thread 8UN (ANSI B1.1) - Inch Pipe Thread (DIN 228)
- Significant product characteristics of the VRS are subject to property right claims.
- Component according to the test criterias of BG/DGUV "GS-HM 36".
- Complying with the US-Standard (ASME B30.26). Quick and easy installation with just one bolt connection.
- Installation and disassembly without any further tools than the exchangeable Easy-Fit star profile key for singular lifts (Version VRS-F).
- For permanent installation and recurrend lifts we can offer a special socket wrench to apply the requested torque (fits to a common Inch torque wrench).

Other important RUD specific information and specialities to our RUD lifting points can be found in the specific user instruction.

STARPOINT VRS-1,5t-G1"

Artikel-Nr: 7999163

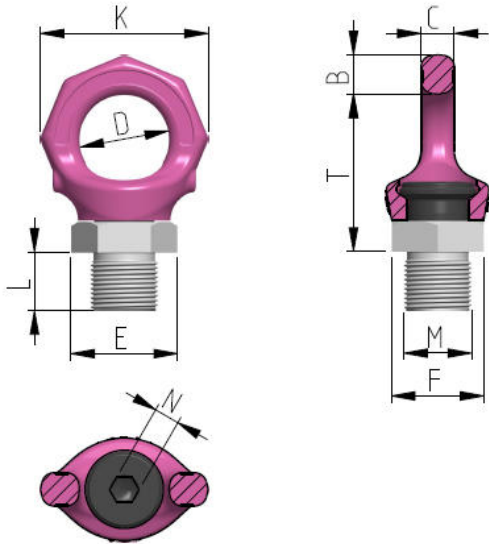

weight	0.63 kg	1.39 lbs
Nominal WLL	1500 kg	3300 lbs
T	61 mm	2-13/32"
B	15 mm	19/32"
C	13 mm	1/2"
D	35 mm	1-3/8"
E	47 mm	1-7/8"
F	41 mm	1-5/8"
I	41 mm	1-5/8"
K	65 mm	2-9/16"
L	32 mm	1-1/4"
M	G 1" mm	G 1"
N	10 mm	3/8"