

Eye nut RM - 5/8"-11BSW

Artikel-Nr: 7993985



For the RUD RM - eye nuts, the threaded connector component must be of at least quality grade 8.8

- Considerably higher WLL (in comparison to DIN 582) at vertical load.
- Large thread and WLL range (M6-M48, 0.1 t – 8 t).
- Clear marking of the minimum WLL for all loading directions.
- Quick and easy installation with just one bolt connection.

Other important RUD specific information and specialities to our RUD lifting points can be found in the specific user instruction.

Eye nut RM - 5/8"-11BSW

Artikel-Nr: 7993985

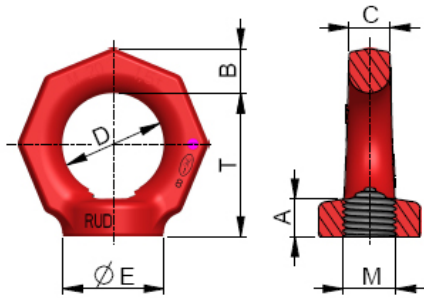

weight	0.26 kg	0.66 lbs
Nominal WLL	750 kg	1650 lbs
T	48 mm	1-7/8"
A	16 mm	5/8"
B	15 mm	19/32"
C	14 mm	9/16"
D	35 mm	1-3/8"
E	35 mm	1-3/8"
M	5/8" mm	5/8"