

L-ABA 6400 daN - Lashing point for welding, loadable from any direction

Artikel-Nr: 7902668



- Lashing point that can be loaded on all sides.
- Ideal for pile drivers, drilling equipment, rollers and earthmoving machinery.
- Clear indication of the minimum lashing capacity in daN.
- Forged from a single piece, no rattling noise or shaking.
- The weld arrangement (circular fillet weld) fulfils the requirements of EN 1090, i.e. the endless weld seam prevents the formation of contact/crevice corrosion (thus suitable for outdoor constructions).

Welding should only be carried out by qualified persons according to ISO 9606-1. Other important RUD specific information and specialities to our RUD lashing points can be found in the specific user instruction.

L-ABA 6400 daN - Lashing point for welding, loadable from any direction

Artikel-Nr: 7902668

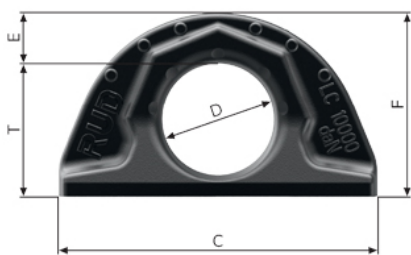

weight	1.15 kg	2.54 lbs
T	59 mm	2-15/16"
A	41 mm	1-5/8"
B	23 mm	29/32"
C	137 mm	5-3/8"
D	50 mm	1-31/32"
E	21 mm	13/16"
F	80 mm	3-1/8"
Lashing capacity	6400 daN	null