

## L-ABA 3200 daN - Lashing point for welding, loadable from any direction

Artikel-Nr: 7902667



- Lashing point that can be loaded on all sides.
- Ideal for pile drivers, drilling equipment, rollers and earthmoving machinery.
- Clear indication of the minimum lashing capacity in daN.
- Forged from a single piece, no rattling noise or shaking.
- The weld arrangement (circular fillet weld) fulfils the requirements of EN 1090, i.e. the endless weld seam prevents the formation of contact/crevice corrosion (thus suitable for outdoor constructions).

Welding should only be carried out by qualified persons according to ISO 9606-1. Other important RUD specific information and specialities to our RUD lashing points can be found in the specific user instruction.

## L-ABA 3200 daN - Lashing point for welding, loadable from any direction

Artikel-Nr: 7902667

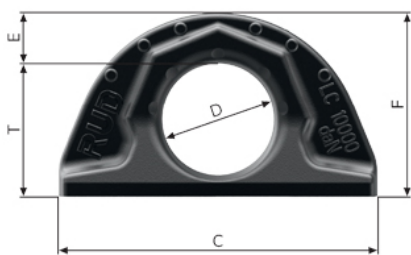

<b>weight</b>	0.45 kg	0.99 lbs
<b>T</b>	42 mm	1-21/32"
<b>A</b>	30 mm	1-3/16"
<b>B</b>	16 mm	5/8"
<b>C</b>	100 mm	3-15/16"
<b>D</b>	35 mm	1-3/8"
<b>E</b>	16 mm	5/8"
<b>F</b>	57 mm	2-1/4"
<b>Lashing capacity</b>	3200 daN	null