

T-COUPLER SLIMLINE M12-MALE 5P./ 2X M12-FEMALE 5P.

T-coupler (Slim Line)

Male straight – females straight

M12 – M12, 5-pole

Parallel circuit

Plastic housings with good resistance against chemicals and oils.

The resistance to aggressive media should be individually tested for your application. Further details on request.

Illustration

Product may differ from image

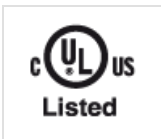
Approvals**Form**

Form 41151

Technical Data

Operating voltage max. 60 V AC/DC

Operating voltage (only UL listed) 30 V AC/DC

Rated surge voltage 1.5 kV

Operating current per contact max. 4 A

Locking of ports Screw thread (M12×1 mm) recommended torque 0.6 Nm, self-securing

Protection IP67 inserted and tightened (EN 60529)

General data

Temperature range -25...+85 °C

Commercial data

country of origin DE

customs tariff number 85366990

EAN 4048879144834

eClass 27143423

Packaging unit 1

Sketch

stay connected

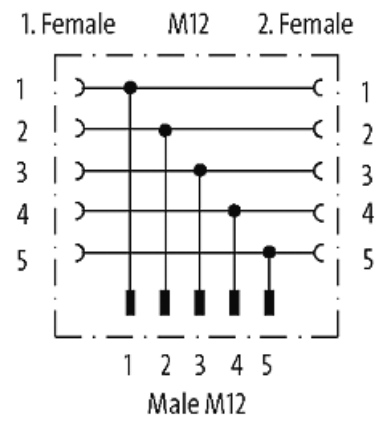
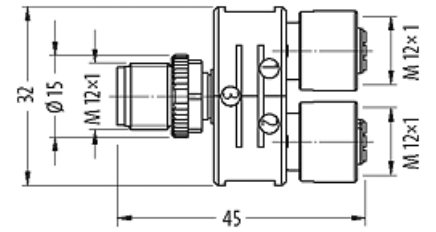
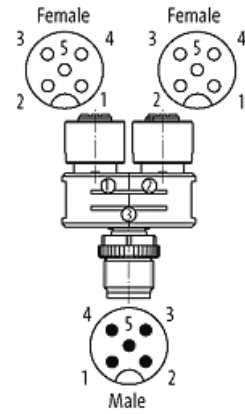

Product may differ from Image