

Vernier Caliper, Long Jaw, Fine Adjust.

Item number: 534-115

Images

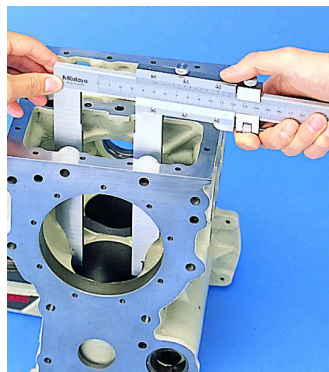

Description

These vernier calipers with long jaws come with or without fine adjustment and let you measure hard-to-reach features.

They offer you the following benefits:

- Long jaws enable you to measure hard-to-reach workpiece features.
- The top offset vernier scale allows you to directly read the inside dimensions without having to add the jaw blade width.

Features

Range:	0 - 750 mm
Graduation:	0,02 mm
Inside measuring from:	20.1 mm
Delivered:	In a box
Max. Permissible Error E MPE:	$\pm 0,08$ mm
Max. Permissible Error S MPE:	$\pm 0,08$ mm
Mass:	2900 g

Dimensions

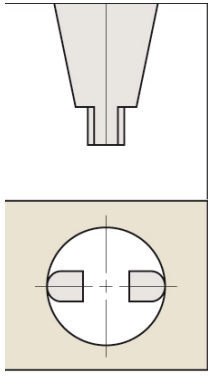

- L:** 995 mm
- D:** 200 mm
- E:** 150 mm
- F:** 62.5 mm
- H:** 32 mm
- R:** 10 mm
- M:** 12 mm
- S:** 18.5 mm
- t:** 6 mm

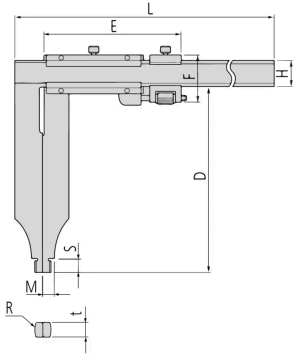

- L:** 995 mm
- D:** 200 mm
- E:** 150 mm
- F:** 62.5 mm
- H:** 32 mm
- R:** 10 mm
- M:** 12 mm
- S:** 18.5 mm
- t:** 6 mm