

Vernier Caliper, Long Jaw, Fine Adjust.

Item number: 534-113

Images

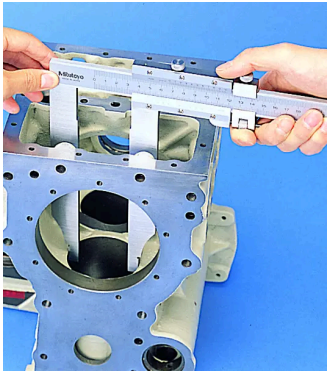

Description

These vernier calipers with long jaws come with or without fine adjustment and let you measure hard-to-reach features.

They offer you the following benefits:

- Long jaws enable you to measure hard-to-reach workpiece features.
- The top offset vernier scale allows you to directly read the inside dimensions without having to add the jaw blade width.

Features

Range:	0 - 300 mm
Graduation:	0,02 mm
Inside measuring from:	10.1 mm
Delivered:	In a box
Max. Permissible Error E MPE:	±0,04 mm
Max. Permissible Error S MPE:	±0,04 mm
Mass:	460 g

Dimensions

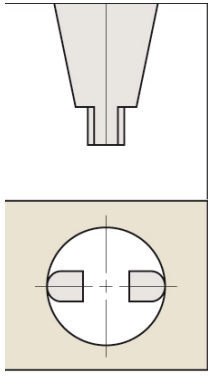

- L:** 445 mm
- D:** 90 mm
- E:** 76.6 mm
- F:** 38 mm
- H:** 20 mm
- R:** 5 mm
- M:** 7 mm
- S:** 12 mm
- t:** 3.8 mm

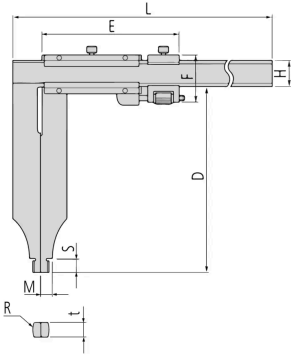

- L:** 445 mm
- D:** 90 mm
- E:** 76.6 mm
- F:** 38 mm
- H:** 20 mm
- R:** 5 mm
- M:** 7 mm
- S:** 12 mm
- t:** 3.8 mm

Accessories

Optional accessories:



Depth Base Attachment for Caliper

125mm width for 300mm Range
Art No. 050085-10
Suggested retail price: 74.00 €*