

## Vernier Caliper, Long Jaw

Item number: 534-110

### Images

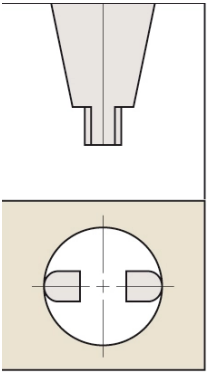
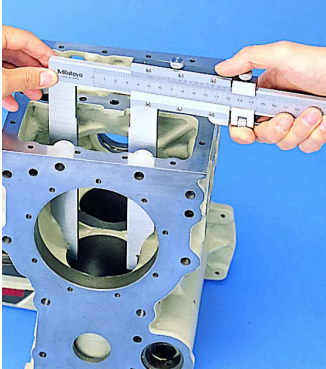

### Description

These vernier calipers with long jaws come with or without fine adjustment and let you measure hard-to-reach features.

They offer you the following benefits:

- Long jaws enable you to measure hard-to-reach workpiece features.
- The top offset vernier scale allows you to directly read the inside dimensions without having to add the jaw blade width.

### Features

<b>Range:</b>	0 - 500 mm
<b>Graduation:</b>	0,05 mm
<b>Inside measuring from:</b>	20.1 mm
<b>Delivered:</b>	In a box
<b>Max. Permissible Error E MPE:</b>	$\pm 0,13$ mm
<b>Max. Permissible Error S MPE:</b>	$\pm 0,13$ mm
<b>Mass:</b>	1400 g