

Vernier Caliper, Long Jaw

Item number: 534-109

Images

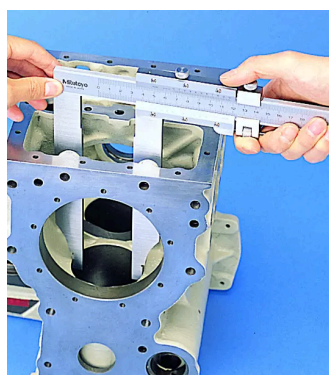
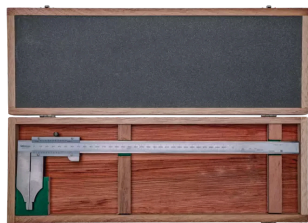

Description

These vernier calipers with long jaws come with or without fine adjustment and let you measure hard-to-reach features.

They offer you the following benefits:

- Long jaws enable you to measure hard-to-reach workpiece features.
- The top offset vernier scale allows you to directly read the inside dimensions without having to add the jaw blade width.

Features

Range:	0 - 300 mm
Graduation:	0,05 mm
Inside measuring from:	10.1 mm
Delivered:	In a box
Max. Permissible Error E MPE:	$\pm 0,07$ mm
Max. Permissible Error S MPE:	$\pm 0,07$ mm
Mass:	400 g

Dimensions

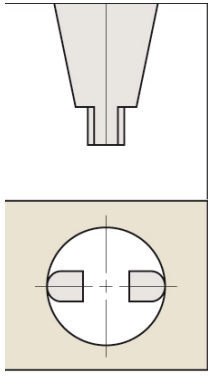

- L:** 445 mm
- D:** 90 mm
- E:** 76.5 mm
- H:** 20 mm
- R:** 5 mm
- M:** 7 mm
- S:** 12 mm
- t:** 3.8 mm

Accessories

Optional accessories:



Depth Base Attachment for Caliper

125mm width for 300mm Range

Art No. 050085-10

Suggested retail price: 74.00 €*