

Vernier Caliper, Long Jaw, Fine Adjust.

Item number: 534-102

Images

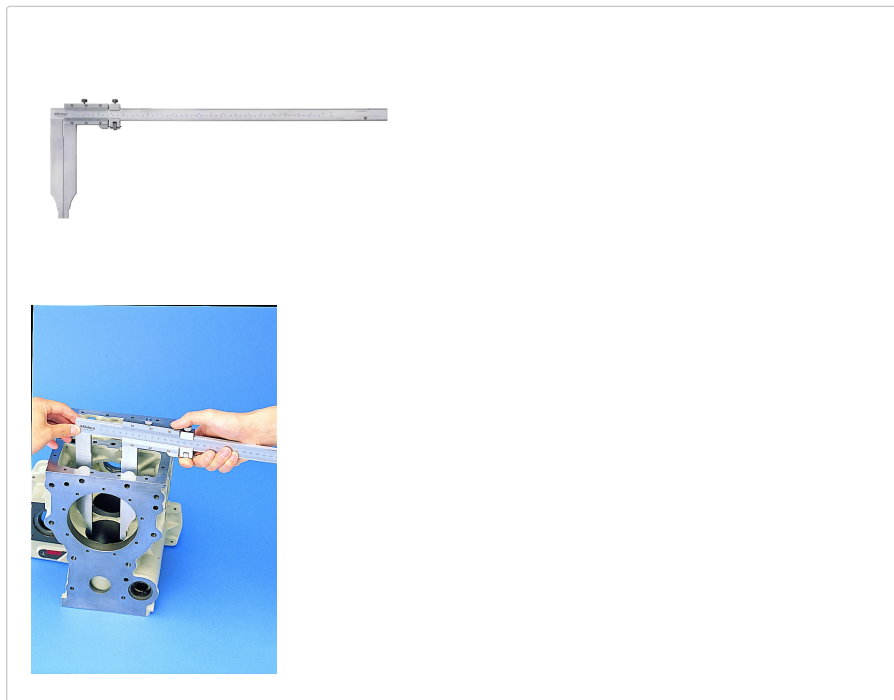

Description

These vernier calipers with long jaws come with or without fine adjustment and let you measure hard-to-reach features.

They offer you the following benefits:

- Long jaws enable you to measure hard-to-reach workpiece features.
- The top offset vernier scale allows you to directly read the inside dimensions without having to add the jaw blade width.

Features

Range:	0 - 20 "
Range:	0 - 500 mm
Graduation:	0,05 mm/ 1/128"
Inside measuring from:	20.1 mm
Delivered:	In a box
Max. Permissible Error E MPE:	±0,13 mm
Max. Permissible Error S MPE:	±0,13 mm
Mass:	1500 g

Dimensions

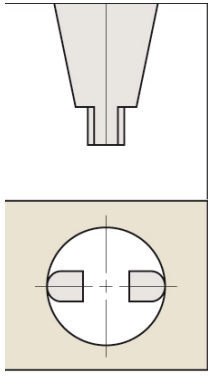

L: 682 mm

D: 200 mm

E: 112 mm

F: 51 mm

H: 25 mm

R: 10 mm

M: 12 mm

S: 18.5 mm

t: 6 mm

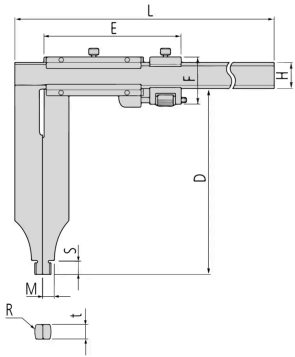

L: 682 mm

D: 200 mm

E: 112 mm

F: 51 mm

H: 25 mm

R: 10 mm

M: 12 mm

S: 18.5 mm

t: 6 mm