

Dial Test Indicator, Pocket Type

Item number: 513-512-10E

Images

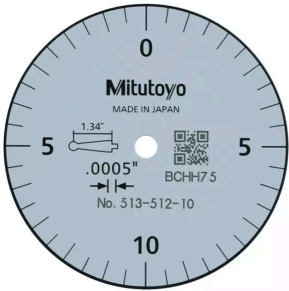

Description

This is a small type Dial Test Indicator (Lever Type) which offers you the following benefits:

- Reversible measuring direction (clutch type)
- Jeweled bearings assure higher sensitivity and accuracy.

Features

Digital/Analog:	Analog
Inch-Metric:	Inch
Delivered:	In a box with stem $\varnothing 9,52$ mm, stylus $\varnothing 0,079$ "
Range:	0,02 "
Dial reading:	0-10-0
Graduation:	0.0005"
H MPE (Hysteresis):	0,0002"
R MPE (Repeatability):	$\pm 0,0002$ "
MPE first one revolution:	± 0.0005 "
Measuring force:	0,01-0,3 N
Carbide stylus tip $\varnothing 2$ mm No.:	131324
Mass:	51 g
Contact point:	Thread M 1.7 x 0.35
Remarks:	Basic set

Dimensions

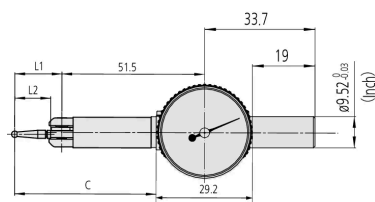

L1: 37.4 mm

L2: 33.9 mm mm

C: 74.1 mm

D \varnothing : 29.2 mm

Accessories

Optional accessories:



Limit Hands (Green) 2 pcs.

Dial Indicator Series 1, Test Indicator

Art No. 21AAB363

Price on application

Standard accessories:



Stem

Ø 9,5mm

Art No. 102081

Price on application

Stylus for Series 513

D= 2mm, 33,9mm Length, Carbide

Art No. 131324

Suggested retail price: 12.00 €*

Spanner R=7,3/4,5mm

Micrometer

Art No. 301336

Suggested retail price: 7.00 €*
