

## Dial Test Indicator, Horiz., Ruby Sty.

Item number: 513-474-10E

### Images

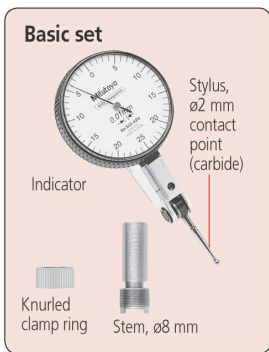
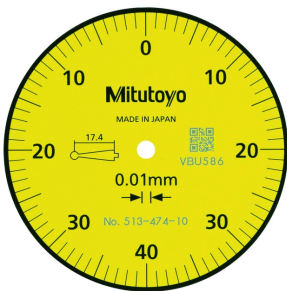

### Description

A Mitutoyo versatile anti-magnetic type lever indicator (or dial test indicator, DTI) suited to alignment operations on machine tools and similar applications. This indicator automatically adapts to the required measuring direction on contact, and the jewelled movement provides lowest friction and stiction for smooth and precise operation. Supplied with a basic set of mounting accessories and a ruby contact-point stylus.

### Features

<b>Digital/Analog:</b>	Analog
<b>Inch-Metric:</b>	Metric
<b>Delivered:</b>	In a box with stem $\varnothing 8$ mm, stylus $\varnothing 2$ mm
<b>Range:</b>	0.8 mm
<b>Dial reading:</b>	0-40-0
<b>Graduation:</b>	0.01 mm
<b>MPE any 10 scale divisions:</b>	5 $\mu\text{m}$

<b>MPE any 1/2 revolution:</b>	6 μm
<b>MPE measuring range:</b>	8 μm
<b>H MPE (Hysteresis):</b>	3 μm
<b>R MPE (Repeatability):</b>	3 μm
<b>Measuring force:</b>	0.01-0.3 N
<b>Ruby stylus tip ø2 mm No.:</b>	21CZA201
<b>Mass:</b>	45 g
<b>Contact point:</b>	Thread M 1.7 x 0.35
<b>Remarks:</b>	Basic set - Ruby contact point

## Dimensions

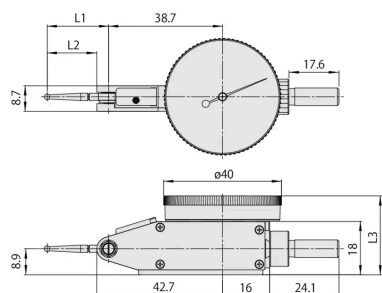

**L1:** 20.9 mm

**L2:** 17.4 mm

**L3:** 26.8 mm

## Accessories

### Optional accessories:



### Limit Hands (Green) 2 pcs.

Dial Indicator Series 1, Test Indicator

Art No. 21AAB363

Price on application

### Standard accessories:



### Stem for Standard Type Series 513

D=8mm

Art No. 21CAB104

Suggested retail price: 15.00 €\*

### **Stylus for Serie 513**

D= 2mm, 17,4mm Length, Ruby  
Art No. 21CZA201  
Suggested retail price: 33.00 €\*  

---



### **Knurled Clamp Ring for Stem**

Lever Indicator Serie 513  
Art No. 190322  
Suggested retail price: 12.00 €\*  

---

