

# Dial Test Indicator, Horizontal Type

Item number: 513-425-10E

## Images

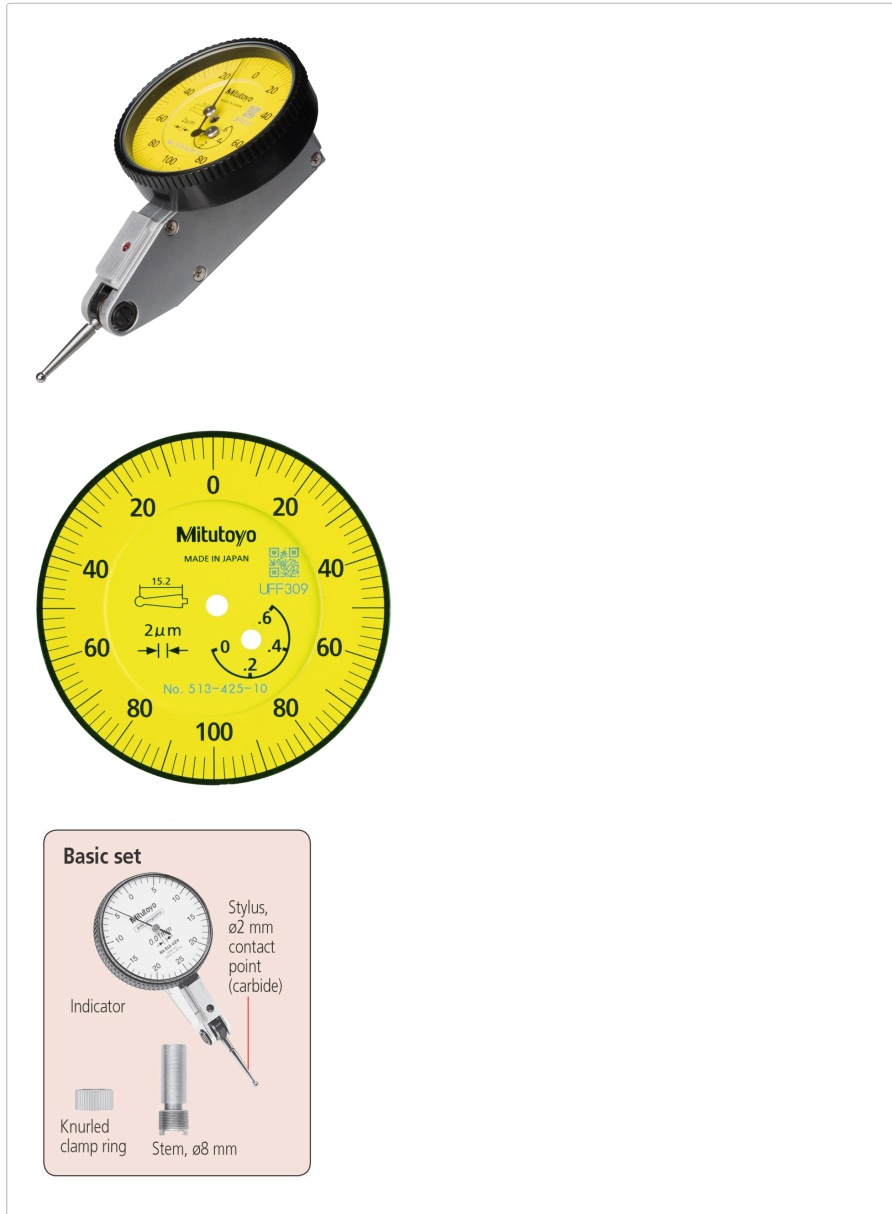

## Description

A versatile anti-magnetic type Mitutoyo lever indicator (or dial test indicator, DTI) suited to alignment operations on machine tools and similar applications. This indicator automatically adapts to the required measuring direction on contact, and the jewelled movement provides lowest friction and stiction for smooth and precise operation. Supplied with a basic set of mounting accessories.

## Features

<b>Digital/Analog:</b>	Analog
<b>Inch-Metric:</b>	Metric
<b>Delivered:</b>	In a box with stem ø8 mm, stylus ø2 mm
<b>Range:</b>	0.6 mm
<b>Dial reading:</b>	0-100-0
<b>Graduation:</b>	0.002 mm
<b>MPE any 10 scale divisions:</b>	2 μm

<b>MPE any 1/2 revolution:</b>	3 µm
<b>MPE any 1 revolution:</b>	5 µm
<b>MPE measuring range:</b>	7 µm
<b>H MPE (Hysteresis):</b>	4 µm
<b>R MPE (Repeatability):</b>	1 µm
<b>Measuring force:</b>	0,01 - 0,4 N
<b>Carbide stylus tip ø2 mm No.:</b>	103011
<b>Mass:</b>	45 g
<b>Contact point:</b>	Thread M 1.7 x 0.35
<b>Remarks:</b>	Basic set

### Dimensions

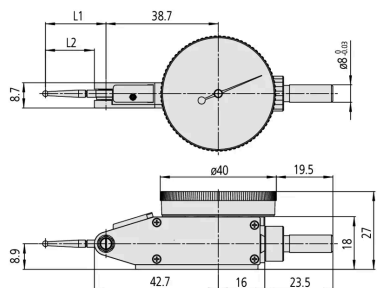

**L1:** 18.7 mm

**L2:** 15.2 mm

**L3:** 27.5 mm

### Accessories

#### Optional accessories:



#### **Limit Hands (Green) 2 pcs.**

Dial Indicator Series 1, Test Indicator  
Art No. 21AAB363

**Price on application**

#### Standard accessories:



#### **Stem for Standard Type Series 513**

D=8mm

Art No. 21CAB104

Suggested retail price: 15.00 €\*



### **Stylus for Serie 513**

D= 2mm, 15,2mm Length, Carbide  
Art No. 103011  
Suggested retail price: 21.00 €\*

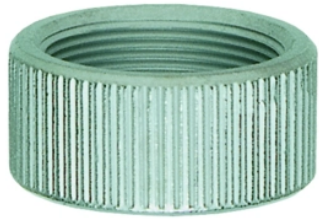

### **Knurled Clamp Ring for Stem**

Lever Indicator Serie 513  
Art No. 190322  
Suggested retail price: 12.00 €\*