

Dial Test Indicator, Horizontal Type

Item number: 513-424-10E

Images

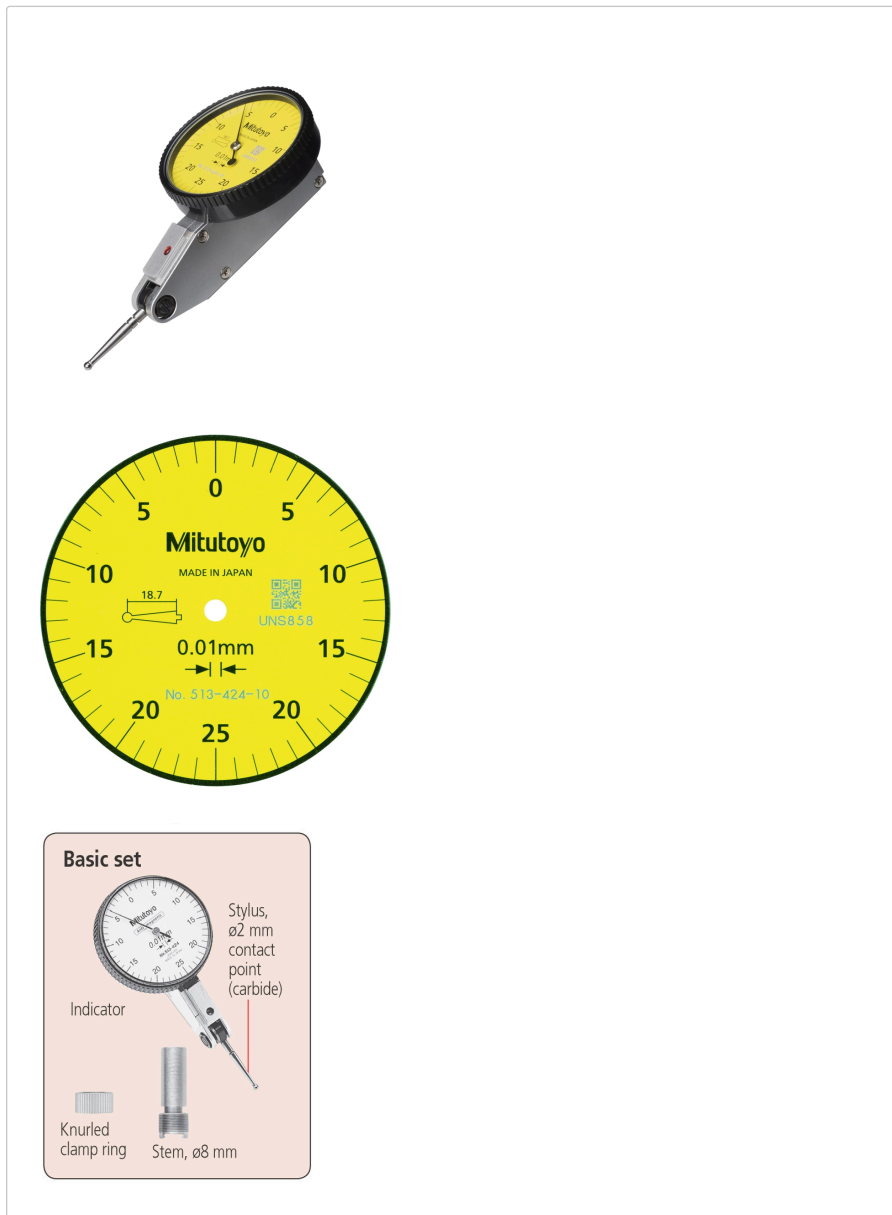

Description

A Mitutoyo versatile anti-magnetic type lever indicator (or dial test indicator, DTI) suited to alignment operations on machine tools and similar applications. This indicator automatically adapts to the required measuring direction on contact, and the jewelled movement provides lowest friction and stiction for smooth and precise operation. Supplied with a basic set of mounting accessories.

Features

Digital/Analog:	Analog
Inch-Metric:	Metric
Delivered:	In a box with stem ø8 mm, stylus ø2 mm
Range:	0.5 mm
Dial reading:	0-25-0
Graduation:	0.01 mm
MPE any 10 scale divisions:	5 µm

MPE measuring range:	5 μm
H MPE (Hysteresis):	3 μm
R MPE (Repeatability):	3 μm
Measuring force:	0.01-0.3 N
Carbide stylus tip $\varnothing 2$ mm No.:	137557
Mass:	45 g
Contact point:	Thread M 1.7 x 0.35
Remarks:	Basic set

Dimensions

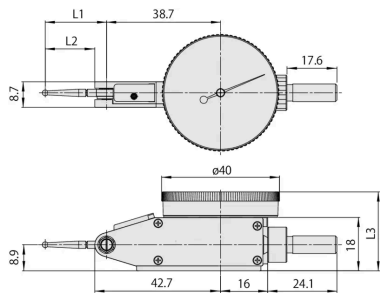

L1: 22.2 mm

L2: 18.7 mm

L3: 26.8 mm

Accessories

Optional accessories:



Limit Hands (Green) 2 pcs.

Dial Indicator Series 1, Test Indicator
Art No. 21AAB363

Price on application

Standard accessories:



Stem for Standard Type Series 513

D=8mm

Art No. 21CAB104

Suggested retail price: 15.00 €*

Stylus for Serie 513

D= 2mm, 18,7mm Length, Carbide
Art No. 137557
Suggested retail price: 21.00 €*



Knurled Clamp Ring for Stem

Lever Indicator Serie 513
Art No. 190322
Suggested retail price: 12.00 €*

