

Dial Test Indicator, Horizontal Type

Item number: 513-403-10E

Images

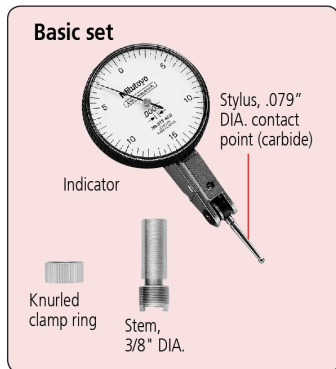

Description

A Mitutoyo versatile anti-magnetic type lever indicator (or dial test indicator, DTI) suited to alignment operations on machine tools and similar applications. This indicator automatically adapts to the required measuring direction on contact, and the jewelled movement provides lowest friction and stiction for smooth and precise operation. Supplied with a basic set of mounting accessories.

Features

Digital/Analog:	Analog
Inch-Metric:	Inch
Range:	0,008 "
Dial reading:	0-4-0
Delivered:	In a box with stem $\varnothing 3/8$ " (9.52 mm), stylus $\varnothing 0.079$ "
Graduation:	0.0001"
H MPE (Hysteresis):	0.0001"
R MPE (Repeatability):	± 0.00004 "

MPE first one revolution: ±0.0001"

Measuring force: 0,01-0,3 N

Contact point: Thread M 1.7 x 0.35

Remarks: Basic set

Mass: 58 g

Dimensions

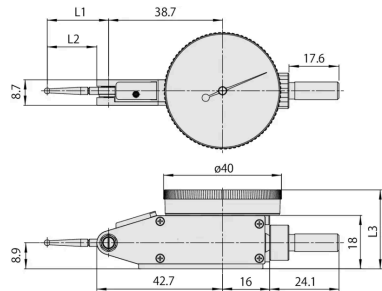

L1: 19 mm

L2: 15.5 mm

L3: 26.8 mm

Accessories

Optional accessories:



Limit Hands (Green) 2 pcs.

Dial Indicator Series 1, Test Indicator

Art No. 21AAB363

Price on application

Standard accessories:



Art No. 21CAB105

Suggested retail price: 10.50 €*

Knurled Clamp Ring for Stem

Lever Indicator Serie 513

Art No. 190322

Suggested retail price: **5.80 €***



Art No. 21CZB064

Suggested retail price: **8.40 €***

