

## Dial Gauge, Lug Back, ISO Type

Item number: 3062A-19

### Images

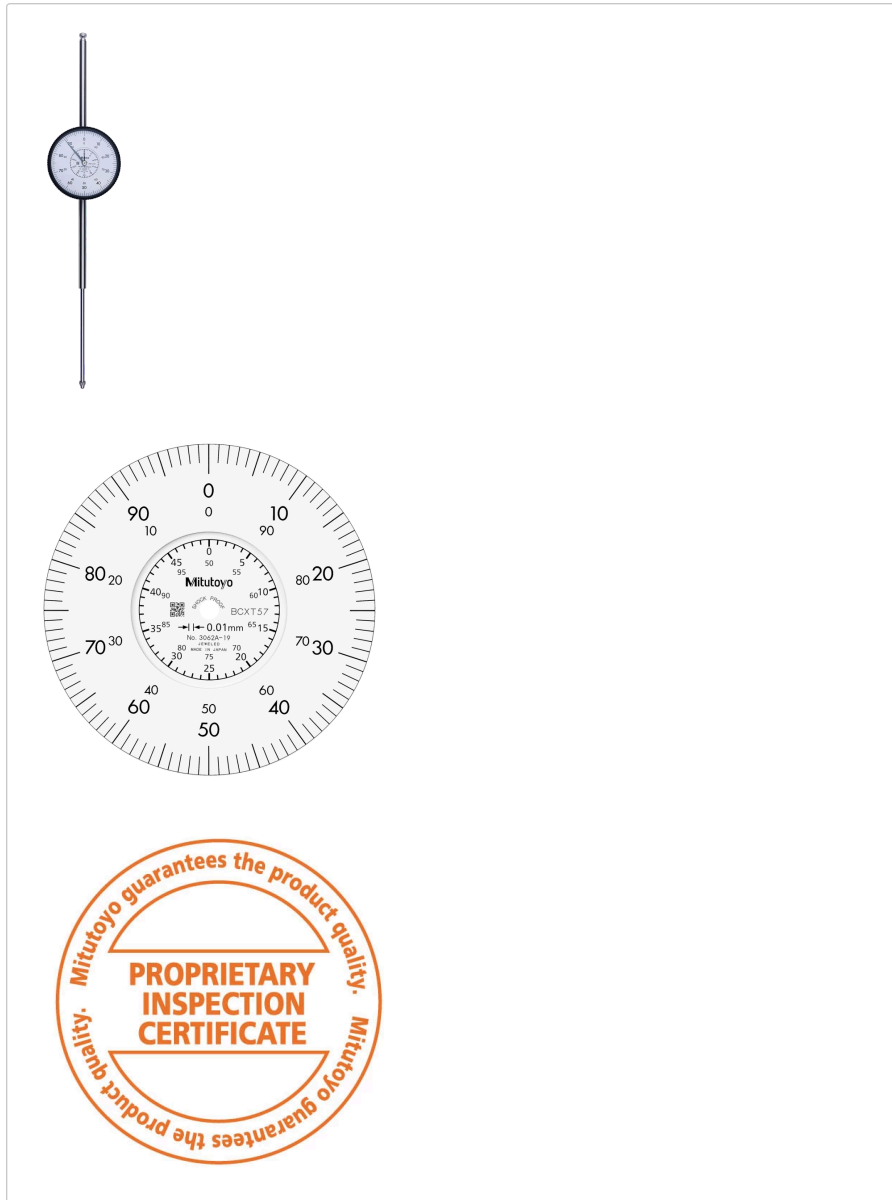

### Description

A Mitutoyo shockproof, multi-revolution dial indicator suited to general measurement applications in a vertical orientation. The jewelled movement provides lowest friction and stiction for smooth and precise operation.

### Features

<b>Digital/Analog:</b>	Analog
<b>Inch-Metric:</b>	Metric
<b>Type:</b>	EN ISO Standard
<b>Range:</b>	100 mm
<b>Range per rev.:</b>	1 mm
<b>Dial reading:</b>	±0-100
<b>Delivered:</b>	With certificate of inspection
<b>Graduation:</b>	0.01 mm

<b>MPE any 1/10 revolution:</b>	12 $\mu\text{m}$
<b>MPE any 1/2 revolution:</b>	17 $\mu\text{m}$
<b>MPE any 1 revolution:</b>	20 $\mu\text{m}$
<b>MPE measuring range:</b>	50 $\mu\text{m}$
<b>H MPE (Hysteresis):</b>	9 $\mu\text{m}$
<b>R MPE (Repeatability):</b>	3 $\mu\text{m}$
<b>Measuring force:</b>	0,4-3,5 N
<b>Stem:</b>	8 mm
<b>Contact point:</b>	Carbide tipped, thread: M 2.5 x 0.45 mm
<b>Continuous dial:</b>	Yes
<b>Coaxial revolution counter:</b>	Yes
<b>Shockproof:</b>	Yes
<b>Mass:</b>	332 g

## Dimensions

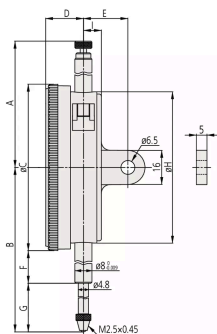

**A:** 141.9 mm

**B:** 243.3 mm

**C:** 78 mm

**D:** 17.7 mm

**E:** 21 mm

**F:** 94.9 mm

**G:** 109.4 mm

**H:** 71 mm

**I:** 9 mm

## Accessories

Optional accessories:



### Limit Hands (green) 2pcs

Dial Indicator Series 2/3/4

Art No. 21AZB195

Price on application



## Bezel Clamp for Dial Gauge

Metric, Series 2/3/4

Art No. 21AZB148

Price on application

## Spare parts

### Consumable spares:



## Contact Element Ball Point, M2,5x0,45

8,3mm Length, Metric

Art No. 21AZA319

Suggested retail price: 6.30 €\*