

Dial Gauge, Lug Back, ISO Type

Item number: 3060A-19

Images

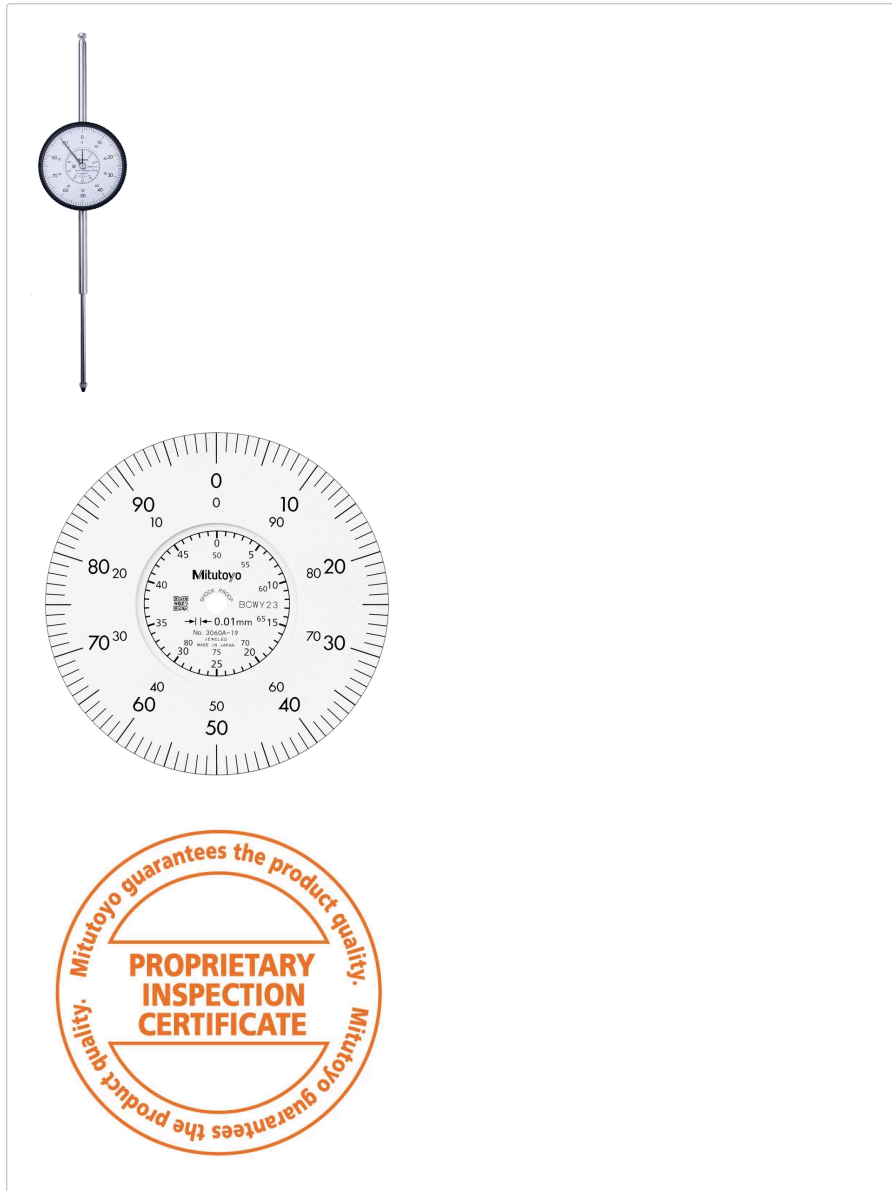

Description

A Mitutoyo shockproof, multi-revolution dial indicator suited to general measurement applications in a vertical orientation. The jewelled movement provides lowest friction and stiction for smooth and precise operation.

Features

Digital/Analog:	Analog
Inch-Metric:	Metric
Type:	EN ISO Standard
Range:	80 mm
Range per rev.:	1 mm
Dial reading:	±0-100
Delivered:	With certificate of inspection
Graduation:	0.01 mm

MPE any 1/10 revolution:	10 µm
MPE any 1/2 revolution:	14 µm
MPE any 1 revolution:	15 µm
MPE measuring range:	45 µm
H MPE (Hysteresis):	9 µm
R MPE (Repeatability):	3 µm
Measuring force:	0,4-3 N
Stem:	8 mm
Contact point:	Carbide tipped, thread: M 2.5 x 0.45 mm
Continuous dial:	Yes
Coaxial revolution counter:	Yes
Shockproof:	Yes
Mass:	314 g

Dimensions

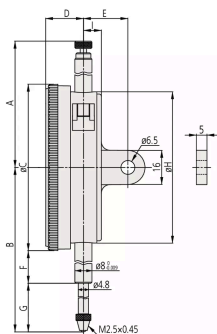

A: 120.9 mm

B: 202.3 mm

C: 78 mm

D: 17.7 mm

E: 21 mm

F: 73.9 mm

G: 89.4 mm

H: 71 mm

I: 9 mm

Accessories

Optional accessories:



Limit Hands (green) 2pcs

Dial Indicator Series 2/3/4

Art No. 21AZB195

Price on application



Bezel Clamp for Dial Gauge

Metric, Series 2/3/4

Art No. 21AZB148

Price on application

Spare parts

Consumable spares:



Contact Element Ball Point, M2,5x0,45

8,3mm Length, Metric

Art No. 21AZA319

Suggested retail price: 6.30 €*