

## Dial Gauge, Lug Back, ANSI/AGD Type

Item number: 2910A-72

### Images



### Description

#### One Revolution Type for Error-free Reading

- Light weight type / standard type
- Limiting pointer rotation to one revolution eliminates the reading errors that can occur with dial indicators featuring more than one revolution of the pointer for full stroke.

### Features

<b>Digital/Analog:</b>	Analog
<b>Inch-Metric:</b>	Inch
<b>Delivered:</b>	With certificate of inspection, bezel clamp
<b>Range:</b>	0,008 "
<b>Plunger Stroke:</b>	2.2 mm
<b>Range per rev.:</b>	0.01"
<b>Dial reading:</b>	4-0-4
<b>Graduation:</b>	0.0001"
<b>H MPE (Hysteresis):</b>	0,0001"
<b>R MPE (Repeatability):</b>	±0,00003"
<b>MPE first one revolution:</b>	±0,0001"
<b>Type:</b>	ANSI/AGD Standard
<b>Measuring force:</b>	0,4-2,5 N
<b>Mass:</b>	163 g

**Stem:** 9.52 mm / 0.375"

**Contact point:** Carbide tipped, thread: 4-48UNF

**One revolution:** Yes

**Shockproof:** Yes

## Dimensions

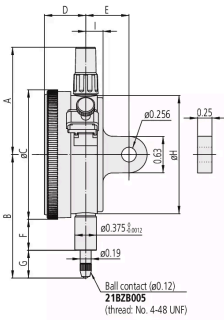

**A:** 1.86 inch

**B:** 2.02 inch

**C:** 2.24 inch

**D:** 0.71 inch

**E:** 3/4 inch

**F:** 0.54 inch

**G:** 0.36 inch

**H:** 2.05 inch

**I:** 0.3 inch

## Accessories

### Optional accessories:



### Limit Hands (green) 2pcs

Dial Indicator Series 2/3/4

Art No. 21AZB195

Price on application



### Spindle Lifting Lever

for Digital Indicator, A-Type Dial Indicator  
Serie 2/3/4

Art No. 21EZA198

Price on application



### Spindle Lifting Cable

for Indicator, L=500mm

Art No. 21JZA295

Price on application



## Spindle Lifting Cable with Auto Stop

for Indicator, L=300mm

Art No. 21JZA301

Price on application

### Standard accessories:



## Bezel Clamp for Dial Gauge

Inch, Series 2/3/4

Art No. 21RZA065

Suggested retail price: 2.10 €\*

### Spare parts

#### Consumable spares:



## Contact Element Ball Point, 4-48UNF

1/4" Length, Carbide, Inch

Art No. 21BZB005

Suggested retail price: 15.00 €\*