

Dial Gauge, Flat Back, ANSI/AGD Type

Item number: 2904AB

Images



Description

This is a standard, inch dial indicator. It offers you the following benefits:

- Bezel clamp and lifting lever (optional) can be attached to either right or left side. They can be easily installed and removed without tools.
- No through screw holes on the frame and secure adhesion between the bezel and the crystal as well as the use of an O-ring prevents water or oil penetration.

Features

Digital/Analog:	Analog
Inch-Metric:	Inch
Range:	1 "
Range per rev.:	0,1"
Dial reading:	100-0
Delivered:	With certificate of inspection, bezel clamp
Graduation:	0,001"
H MPE (Hysteresis):	0,0002"
R MPE (Repeatability):	±0,0002"
MPE first one revolution:	±0,001"
MPE first 2 1/2 revolutions:	±0,001"
MPE > 2 1/2-10 revolutions:	±0,002"
Type:	ANSI/AGD Standard

Measuring force:	0,4-1,8 N
Stem:	9.52 mm / 0.375"
Contact point:	Carbide tipped, thread: 4-48UNF
Continuous dial:	Yes
Reverse reading:	Yes 3
Mass:	139 g

Dimensions

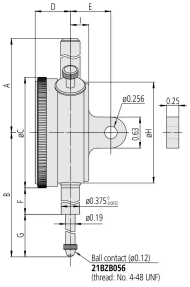

- A:** 1.53 inch
- B:** 3.02 inch
- C:** 2.24 inch
- D:** 0.71 inch
- E:** 3/4 inch
- F:** 0.54 inch
- G:** 1.37 inch
- H:** 2.05 inch
- I:** 0.3 inch

Accessories

Optional accessories:



Limit Hands (green) 2pcs

Dial Indicator Series 2/3/4
 Art No. 21AZB195
 Price on application

Standard accessories:



Bezel Clamp for Dial Gauge

Inch, Series 2/3/4
 Art No. 21RZA065
 Suggested retail price: 5.00 €*

Consumable spares:



Contact Element Ball Point, 4-48UNF

1/4" Length, Carbide, Inch

Art No. 21BZB005

Suggested retail price: 13.30 €*
