

Dial Gauge, Lug Back, ANSI/AGD Type

Item number: 2506A

Images

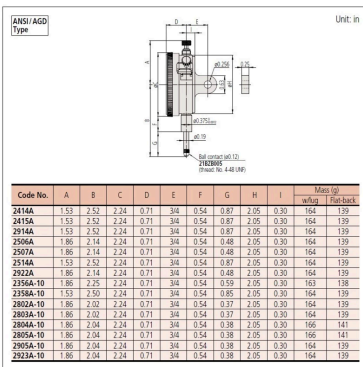

Description

Standard Type, 0,5" / 0,125" Range, 0,001" / 0,005" Graduation - Inch

This is a standard, inch dial indicator. It offers you the following benefits:

- Bezel clamp and lifting lever (optional) can be attached to either right or left side. They can be easily installed and removed without tools.
- No through screw holes on the frame and secure adhesion between the bezel and the crystal as well as the use of an O-ring prevents water or oil penetration.

Features

Digital/Analog:	Analog
Inch-Metric:	Inch
Range:	0,125 "
Range per rev.:	0.05"
Dial reading:	±0-50
Delivered:	With certificate of inspection, bezel clamp

Graduation:	0.0005"
H MPE (Hysteresis):	0,00016"
R MPE (Repeatability):	±0,0001"
MPE first one revolution:	±0,0005"
MPE first 2 1/2 revolutions:	±0,0005"
Type:	ANSI/AGD Standard
Measuring force:	0,4-1,8 N
Stem:	9.52 mm / 0.375"
Contact point:	Carbide tipped, thread: 4-48UNF
Continuous dial:	Yes
Mass:	164 g

Dimensions

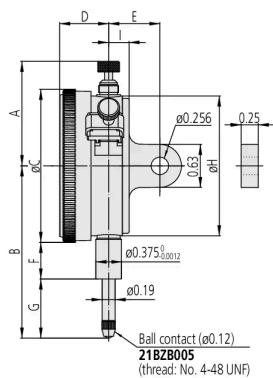

A: 1.86 inch

B: 2.14 inch

C: 2.24 inch

D: 0.71 inch

E: 3/4 inch

F: 0.54 inch

G: 0.48 inch

H: 2.05 inch

I: 0.3 inch

Accessories

Optional accessories:



Limit Hands (green) 2pcs

Dial Indicator Series 2/3/4

Art No. 21AZB195

Price on application



Spindle Lifting Lever

for Digital Indicator, A-Type Dial Indicator
Serie 2/3/4

Art No. 21EZA198

Price on application

Spindle Lifting Cable

for Indicator, L=500mm

Art No. 21JZA295

Price on application



Spindle Lifting Cable with Auto Stop

for Indicator, L=300mm

Art No. 21JZA301

Price on application



Standard accessories:

Bezel Clamp for Dial Gauge

Inch, Series 2/3/4

Art No. 21RZA065

Suggested retail price: 5.00 €*



Spare parts

Consumable spares:

Contact Element Ball Point, 4-48UNF

1/4" Length, Carbide, Inch

Art No. 21BZB005

Suggested retail price: 13.30 €*



