

Dial Gauge, Lug Back, ANSI/AGD Type

Item number: 1921A-10

Images



Description

Compact Type, Extra Small Diameter - Inch

This is a compact, inch dial indicator with a bezel \varnothing 31 / 36 mm. It offers you the following benefits:

- It is ideal for use in applications where space is limited.

Features

Digital/Analog:	Analog
Inch-Metric:	Inch
Range:	0.1 "
Range per rev.:	0,04"
Dial reading:	0-20-0
Delivered:	With certificate of inspection
Graduation:	0.001"
H MPE (Hysteresis):	0,0002"
R MPE (Repeatability):	\pm 0,0002"
MPE first one revolution:	\pm 0,001"
MPE first 2 1/2 revolutions:	\pm 0,001"
Type:	ANSI/AGD Standard
Measuring force:	0,3-1,8 N
Stem:	9.52 mm / 0.375"

Contact point:

Carbide tipped, thread: 4-48UNF

Mass:

56 g

Dimensions

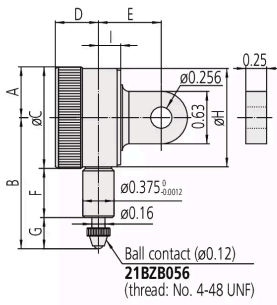

A: 0.61 inch

B: 1.58 inch

C: 1.22 inch

D: 0.52 inch

E: 3/4 inch

F: 0.59 inch

G: 0.37 inch

H: 1.18 inch

I: 0.27 inch

Spare parts

Consumable spares:



Contact Element Ball Point, 4-48UNF

1/4" Length, Carbide, Inch

Art No. 21BZB056

Suggested retail price: 8.30 €*