

## Dial Gauge, Flat Back, ANSI/AGD Type

Item number: 1781AB

### Images



### Description

#### Compact Type, Small Diameter - Inch

This is a compact, inch dial indicator with a bezel Ø 40 mm. It offers you the following benefits:

- It is ideal for use in applications where space is limited.
- Green limit markers are a standard accessory.

### Features

<b>Digital/Analog:</b>	Analog
<b>Inch-Metric:</b>	Inch
<b>Range:</b>	0,125 "
<b>Range per rev.:</b>	0.05"
<b>Dial reading:</b>	0-25-0
<b>Delivered:</b>	With certificate of inspection, bezel clamp
<b>Graduation:</b>	0,001"
<b>H MPE (Hysteresis):</b>	0,0002"
<b>R MPE (Repeatability):</b>	±0,0002"
<b>MPE first one revolution:</b>	±0,001"
<b>MPE first 2 1/2 revolutions:</b>	±0,001"
<b>Type:</b>	ANSI/AGD Standard
<b>Measuring force:</b>	0,4-1,4 N

**Stem:** 9.52 mm / 0.375"

**Contact point:** Carbide tipped, thread: 4-48UNF

**Balanced dial:** Yes

**Continuous dial:** Yes

**Double scale spacing:** Yes

**Mass:** 70 g

## Dimensions

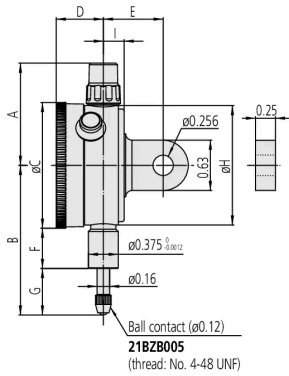

**A:** 1.28 inch

**B:** 1.74 inch

**C:** 1.57 inch

**D:** 0.59 inch

**E:** 3/4 inch

**F:** 0.50 inch

**G:** 0.44 inch

**H:** 1.50 inch

**I:** 0.26 inch

## Accessories

### Optional accessories:



### Limit Hands (Green) 2 pcs.

Dial Indicator Series 1, Test Indicator  
Art No. 21AAB363

Price on application

### Spindle Lifting Lever

for S-Type and A-Type Serie 1  
Art No. 902100

Price on application



## Spindle Lifting Cable

for Indicator, L=500mm

Art No. 21JZA295

[Price on application](#)



## Spindle Lifting Cable with Auto Stop

for Indicator, L=300mm

Art No. 21JZA301

[Price on application](#)



### Standard accessories:

## Bezel Clamp for Dial Gauge

Series 1

Art No. 21RZA149

[Price on application](#)



### Spare parts

#### Consumable spares:

## Contact Element Ball Point, 4-48UNF

1/4" Length, Carbide, Inch

Art No. 21BZB005

Suggested retail price: 13.30 €\*



