

## Dial Gauge, Flat Back, ANSI/AGD Type

Item number: 1780AB

### Images



### Description

#### Compact Type, Small Diameter - Inch

This is a compact, inch dial indicator with a bezel Ø 40 mm. It offers you the following benefits:

- It is ideal for use in applications where space is limited.
- Green limit markers are a standard accessory.

### Features

<b>Digital/Analog:</b>	Analog
<b>Inch-Metric:</b>	Inch
<b>Delivered:</b>	With certificate of inspection, bezel clamp
<b>Range:</b>	0,125 "
<b>Range per rev.:</b>	0.05"
<b>Dial reading:</b>	0-50
<b>Graduation:</b>	0,001"
<b>H MPE (Hysteresis):</b>	0,0002"
<b>R MPE (Repeatability):</b>	±0,0002"
<b>MPE first one revolution:</b>	±0,001"
<b>MPE first 2 1/2 revolutions:</b>	±0,001"
<b>Type:</b>	ANSI/AGD Standard
<b>Measuring force:</b>	0,4-1,4 N

<b>Mass:</b>	70 g
<b>Stem:</b>	9.52 mm / 0.375"
<b>Contact point:</b>	Carbide tipped, thread: 4-48UNF
<b>Continuous dial:</b>	Yes
<b>Double scale spacing:</b>	Yes

## Dimensions

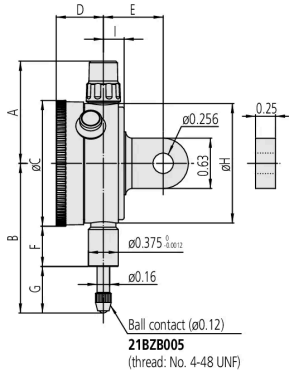

<b>A:</b>	1.28 inch
<b>B:</b>	1.74 inch
<b>C:</b>	1.57 inch
<b>D:</b>	0.59 inch
<b>E:</b>	3/4 inch
<b>F:</b>	0.50 inch
<b>G:</b>	0.44 inch
<b>H:</b>	1.50 inch
<b>I:</b>	0.26 inch

## Accessories

### Optional accessories:



### Limit Hands (Green) 2 pcs.

Dial Indicator Series 1, Test Indicator  
Art No. 21AAB363

Price on application



### Spindle Lifting Lever

for S-Type and A-Type Serie 1

Art No. 902100

Price on application

## Spindle Lifting Cable

for Indicator, L=500mm

Art No. 21JZA295

[Price on application](#)



## Spindle Lifting Cable with Auto Stop

for Indicator, L=300mm

Art No. 21JZA301

[Price on application](#)



### Standard accessories:

## Bezel Clamp for Dial Gauge

Series 1

Art No. 21RZA149

[Price on application](#)



### Spare parts

#### Consumable spares:

## Contact Element Ball Point, 4-48UNF

1/4" Length, Carbide, Inch

Art No. 21BZB005

Suggested retail price: 15.00 €\*



