

## Contact Point for Serie 526

Item number: 102470

### Images

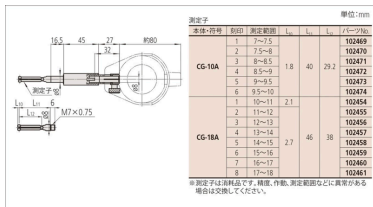

### Description

Split-ball probes 0,95-1,15 mm up to 6,7-7,3 mm range are protected by a diamond-like DLC coating.

Split-ball probes 7-18 mm are hard chrome plated

DLC Black Diamond:

- Extremely high wear protection, due to low frictional resistance
- Safety due to high hardness and resistance
- Safety due to sustained accuracy and precision

### Features

**Range:** 7.5 - 8 mm

**Marking on the measuring head (engraved):** 2

Remarks:

for 526-124-20, 526-126-20

### Dimensions

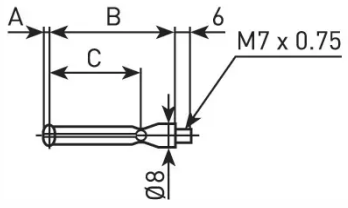

**A:** 1.8 mm

**B:** 40 mm

**C:** 29.2 mm