

Contact Point for Serie 526

Item number: 102455

Images



Description

Split-ball probes 0,95-1,15 mm up to 6,7-7,3 mm range are protected by a diamond-like DLC coating.

Split-ball probes 7-18 mm are hard chrome plated

DLC Black Diamond:

- Extremely high wear protection, due to low frictional resistance
- Safety due to high hardness and resistance
- Safety due to sustained accuracy and precision

Features

Range:	11 - 12 mm
Marking on the measuring head (engraved):	2

Remarks:

for 526-125-20, 526-127-20

Dimensions

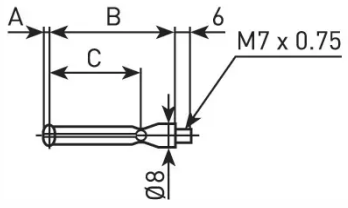

A: 2.7 mm

B: 46 mm

C: 38 mm