

## Contact Point for Serie 526

Item number: 102454

### Images

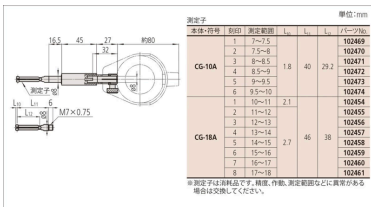

### Description

Split-ball probes 0,95-1,15 mm up to 6,7-7,3 mm range are protected by a diamond-like DLC coating.

Split-ball probes 7-18 mm are hard chrome plated

DLC Black Diamond:

- Extremely high wear protection, due to low frictional resistance
- Safety due to high hardness and resistance
- Safety due to sustained accuracy and precision

### Features

**Range:** 10 - 11 mm

**Marking on the measuring head (engraved):** 1

Remarks:

for 526-125-20, 526-127-20

**Dimensions**

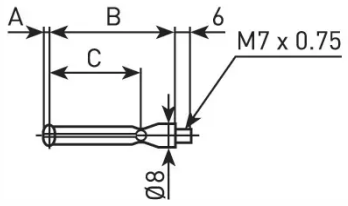

**A:** 2.1 mm

**B:** 46 mm

**C:** 38 mm