

PRODUCT INFORMATION PACKET

Model No: 213THFS8028
Catalog No: Y595
7 1/2, 1800, TEFC, 213TC, 3/60/230/460
2000:1 With Encoder Provision



Regal and Marathon are trademarks of Regal Beloit Corporation or one of its affiliated companies.
©2018 Regal Beloit Corporation, All Rights Reserved. MC017097E





Nameplate Specifications

Output HP	7.5 Hp	Output KW	5.6 kW
Frequency	60 Hz	Voltage	230/460 V
Current	19.4/9.7 A	Speed	1765 rpm
Service Factor	1	Phase	3
Efficiency	88.5 %	Duty	CONTINUOUS
Insulation Class	H	Design Code	INV
KVA Code	L	Frame	213TC
Enclosure	TEFC	Overload Protector	NOT
Ambient Temperature	40 °C	Drive End Bearing Size	6309
Opp Drive End Bearing Size	6207	UL	Recognized
CSA	Y	CE	Y
IP Code	43		

Technical Specifications

Electrical Type	SQ CAGE INV DUTY	Starting Method	INVERTER ONLY
Poles	4	Rotation	REV
Mounting	RIGID	Motor Orientation	HORIZONTAL
Drive End Bearing	BALL	Opp Drive End Bearing	BALL
Frame Material	CAST IRON	Shaft Type	T
Overall Length	21.03 in	Frame Length	7.25 in
Shaft Diameter	1.38 in	Shaft Extension	3.12 in
Assembly/Box Mounting	F1/F2 CAPABLE		
Outline Drawing	A-SS88574-725	Connection Diagram	A-EE7308T

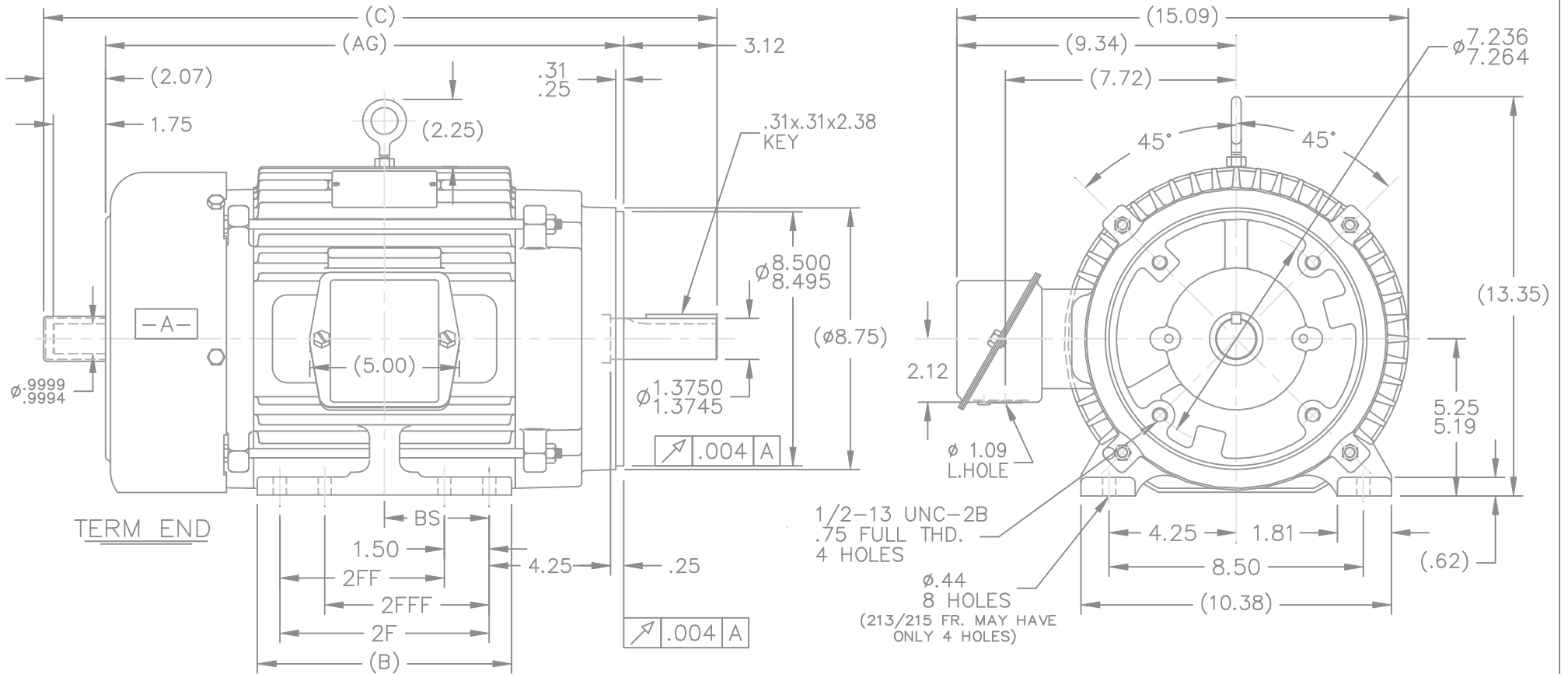

1/2-13 UNC-2B
.75 FULL THD.
4 HOLES

φ.44
8 HOLES
(213/215 FR. MAY HAVE ONLY 4 HOLES)

DASH	FRAME	C	AG	B	2F	2FF	2FFF	BS
725	213T	21.03	15.84	7.00	5.50	-	-	2.75
875	215T	22.53	17.34	8.50	7.00	-	-	3.50
875	213/5T	22.53	17.34	8.50	7.00	5.50	5.50	3.50
1000	213T	23.78	18.59	9.75	8.25	5.50	5.50	4.12
1000	215T	23.78	18.59	9.75	8.25	7.00	7.00	4.12

- NOTES:
1. BOX CAN BE ROTATED IN 90° STEPS.
 2. BOX CAN BE MOUNTED ON OPPOSITE SIDE BY REMOVING BRACKETS AND TURNING FRAME 180°.
 3. NAMEPLATE TO BE READ FROM CONDUIT BOX SIDE OF MOTOR.

NO.	REVISION	BY & DATE	CHK	TOLERANCES UNLESS SPECIFIED	
				DEC.	INCHES
4	UPDATED DRAWING	TJW 05/04/2007	.X	±.1	
3	REVISED FOOT HOLE NOTE CN 29200-2241	NJS 02-18-2002	DRS	.XX	±.03
2	UPDATED C'BOX GEOMETRY CN 28426	DRS 01-25-2002	ML	.XXX	±.005
1	NEW DRAWING CN 28945	DRS 10-09-2002		.XXXX	±.0005



TITLE OUTLINE	210 FR.	DRAWN	DRS 11-15-2001
MAT'L.		CHK	ML 01-09-2002
FINISH		APPD	TB 01-09-2002
		SCALE	1=5
		REF	
		FMF	
		PREV	

THIS DRAWING IN DESIGN AND DETAIL IS OUR PROPERTY AND MUST NOT BE USED EXCEPT IN CONNECTION WITH OUR WORK ALL RIGHTS OF DESIGN AND INVENTION ARE RESERVED THIS IS AN ELECTRONICALLY GENERATED DOCUMENT - DO NOT SCALE THIS PRINT		RFP	CAD FILE ss88574	SIZE	DRAWING NO.	PAGE	OF	REV.
		DIST LB		A	SS88574			4

HIGH VOLTAGE

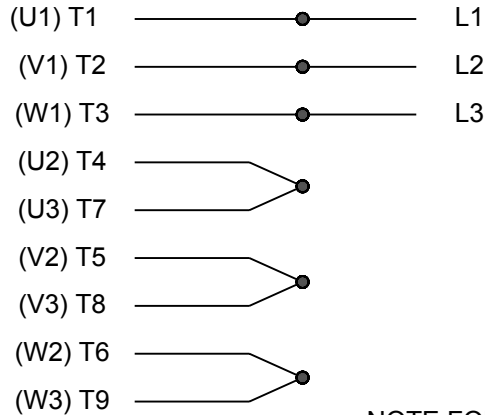

**NOTE FOR FACTORY USE ONLY:
 TO SURGE TEST FOR COMMON CONNECT:
 HIGH VOLT: CONNECT P1 TO T1
 THEN P2 TO L1
 LOW VOLT: CONNECT P1 TO T1 & T7,
 THEN P2 TO L1**

LOW VOLTAGE

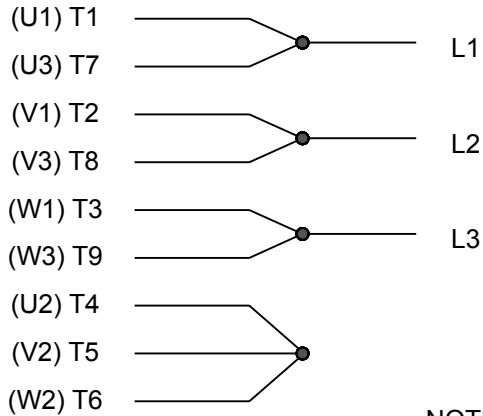

NOTE: LEAD'S COLOR CAN BE YELLOW OR WHITE FOR MT2 PLANT

THREE PHASE DUAL VOLTAGE MOTOR

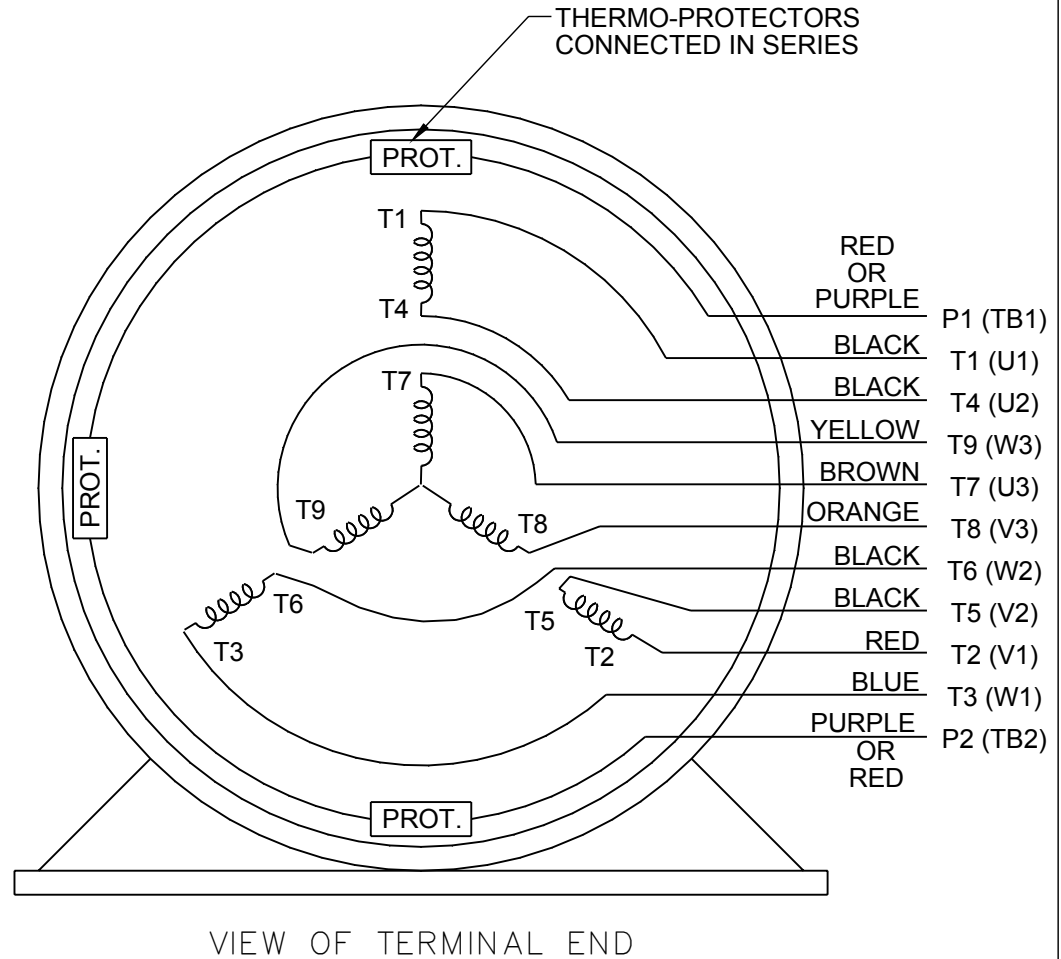

DRAWING REVISION R	REVISION BY AJW	DATE 07-17-2015		DRAWN BY SMC	Regal Beloit America, Inc.
ECO ECO-0081632	APPROVED BY T. VUE	DATE 07-17-2015		DATE 05-13-1992	
ECO DESCRIPTION REV'D IEC NOTATIONS PER IEC 60034-8				APPROVED BY TB	DESCRIPTION CONN DIAGRAM-INTERNAL
<small>COPYRIGHT REGAL BELOIT AMERICA, INC. ALL RIGHTS RESERVED. PROPRIETARY AND CONFIDENTIAL INFORMATION - THIS DOCUMENT IS THE PROPERTY OF REGAL BELOIT AMERICA, INC. ("OWNER") AND CONTAINS OWNER'S PROPRIETARY INFORMATION. ANY PERSON, CORPORATION OR OTHER FIRM RECEIVING IT IS DEEMED, BY RECEIVING IT, TO AGREE THAT IT, AND/OR ANY PART OF IT, SHALL NOT BE DISCLOSED TO ANY PERSON, CORPORATION OR OTHER ENTITY, DUPLICATED, AND/OR USED, EXCEPT AS EXPRESSLY APPROVED IN WRITING IN ADVANCE BY OWNER. THIS DOCUMENT SHALL BE RETURNED TO OWNER UPON REQUEST. IT MAY BE SUBJECT TO CERTAIN RESTRICTIONS UNDER APPLICABLE EXPORT CONTROL LAWS AND REGULATIONS.</small>				DATE 05-13-1992	3 PHASE - DUAL VOLTAGE MOTOR
			REFERENCE EE7308/EE7300	MATERIAL	PROCESS/FINISH
			THIRD ANGLE PROJECTION	SIZE A	DRAWING NUMBER EE7308T

NONE	NONE		
NONE FT-LB	NONE V	NONE Hz	

DATE: 06/22/2017 03:56:09 AM
FORM 3531 REV.3 02/07/99
** Subject to change without notice.

