

PRODUCT INFORMATION PACKET

marathon[®]
Motors

Model No: 324TTFPA14071
Catalog No: Y1618
40,1800,TEFC,324T,3/60/230/460YD
Fire Pump

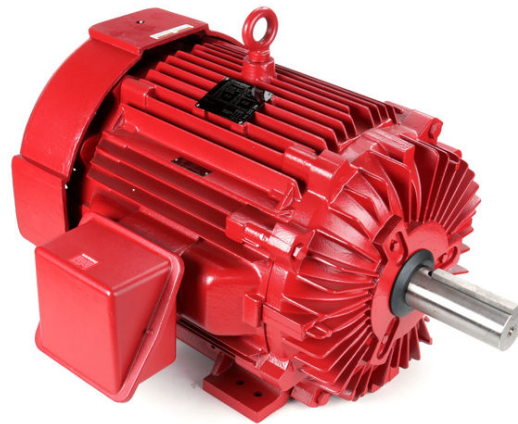

Regal and Marathon are trademarks of Regal Beloit Corporation or one of its affiliated companies.
©2018 Regal Beloit Corporation, All Rights Reserved. MC017097E

REGAL[®]



Nameplate Specifications

Output HP	40 Hp	Output KW	30.0 kW
Frequency	60 Hz	Voltage	230/460 V
Current	100.0/50.0 A	Speed	1762 rpm
Service Factor	1.15	Phase	3
Efficiency	93 %	Duty	Continuous
Insulation Class	F	Design Code	B
KVA Code	G	Frame	324T
Enclosure	Totally Enclosed Fan Cooled	Overload Protector	No
Ambient Temperature	40 °C	Drive End Bearing Size	6312
Opp Drive End Bearing Size	6311	UL	No
CSA	Y	CE	Y
IP Code	43		

Technical Specifications

Electrical Type	Squirrel Cage Induction Run	Starting Method	Part Wdg Start Low Volt Only & Wye Start Delta Run
Poles	4	Rotation	Reversible
Mounting	Rigid base	Motor Orientation	HORIZONTAL
Drive End Bearing	BALL	Opp Drive End Bearing	BALL
Frame Material	Cast Iron	Shaft Type	T
Overall Length	28.97 in	Frame Length	14.75 in
Shaft Diameter	2.125 in	Shaft Extension	5.44 in
Assembly/Box Mounting	F1/F2 CAPABLE		
Outline Drawing	B-SS311077-1475	Connection Diagram	A-EE7358

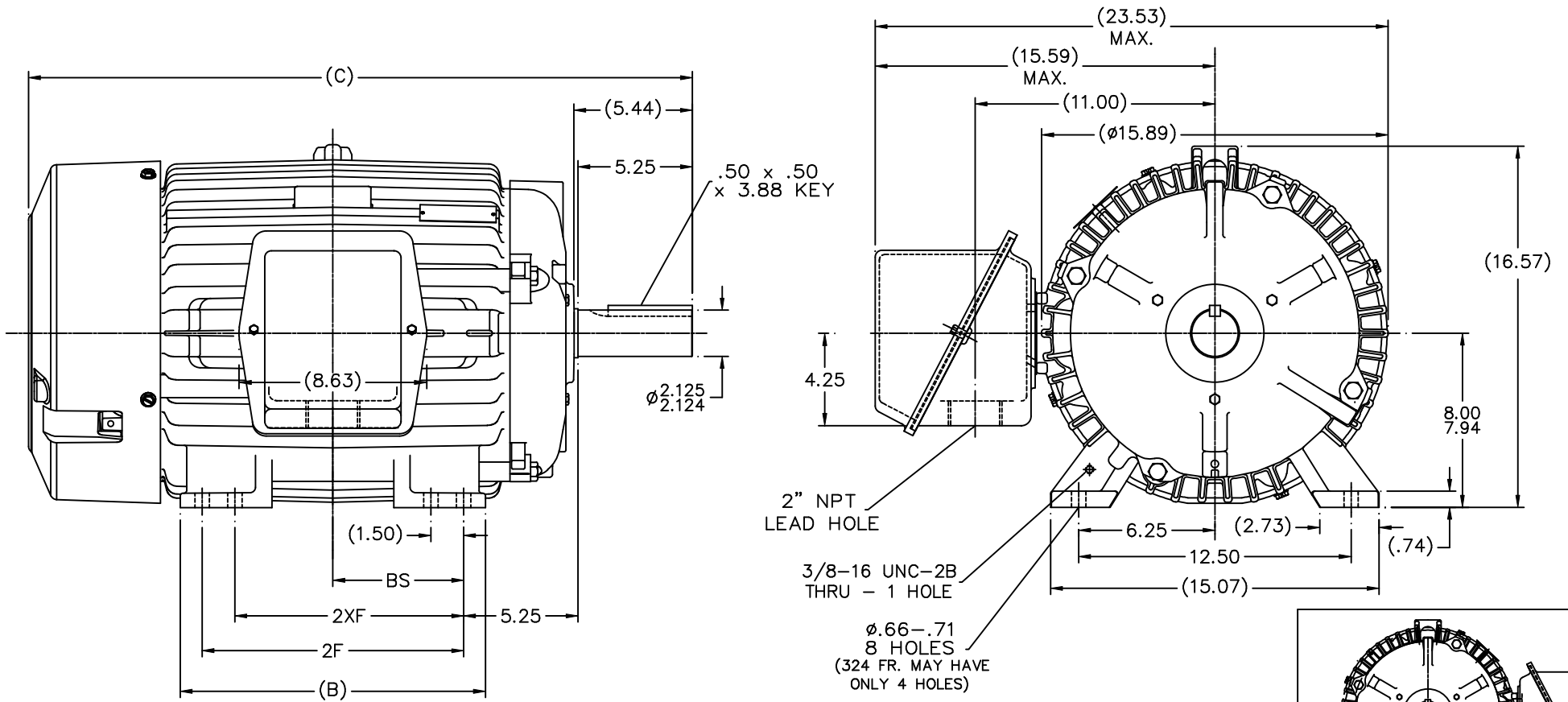

- NOTES:
 1. CONDUIT BOX BE ROTATED IN 90° STEPS.
 2. NAMEPLATE TO BE READ FROM CONDUIT BOX SIDE OF MOTOR.

DASH	FRAME	B	C	2F	2XF	BS
1475	324T	14.00	28.97	10.50	5.25	
1625	324/326T	14.00	30.47	12.00	10.50	6.00

		TOLERANCES UNLESS SPECIFIED		MARATHON ELECTRIC		DRAWN CAV 11-01-2000		
		DEC.	INCHES			CHK	DRS 11-04-2000	
03	DASH 1625 FRAME WAS 326T MU44821	KJC	01-09-2003	DD	.XX ±.03	TITLE OUTLINE - TFPA		
02	DASH 1475 (B) 14.00 WAS 12.50 CN29200-1468	HLB			.XXX ±.005	320 FR. - BB - STD - 12.50 LAM		
01	NEW DRAWING MU34249	CAV	11-06-2000	DRS	.XXXX ±.0005	SCALE 7-32		
NO.	REVISION	BY & DATE		CHK	ANG ±7°30"	APPD DD 11-06-2000		
THIS DRAWING IN DESIGN AND DETAIL IS OUR PROPERTY AND MUST NOT BE USED EXCEPT IN CONNECTION WITH OUR WORK ALL RIGHTS OF DESIGN AND INVENTION ARE RESERVED THIS IS AN ELECTRONICALLY GENERATED DOCUMENT - DO NOT SCALE THIS PRINT				RFP		REF		
				DIST WA		CAD FILE ss311077	PREV	
						SIZE B	DRAWING NO. SS311077	PAGE OF
								03

```
ERROR: syntaxerror  
OFFENDING COMMAND: --nostringval--  
STACK :  
-dictionary-
```

HIGH VOLTAGE

WYE START

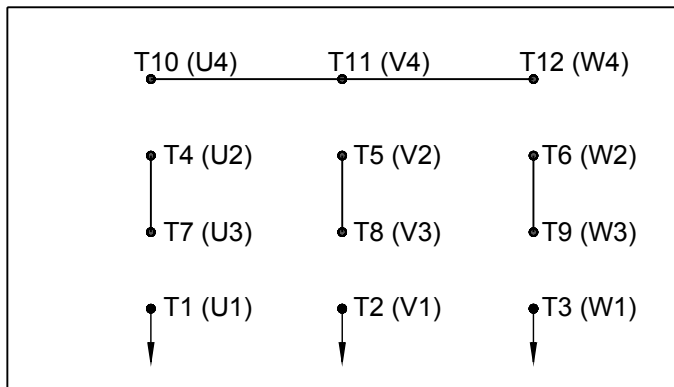

DELTA RUN

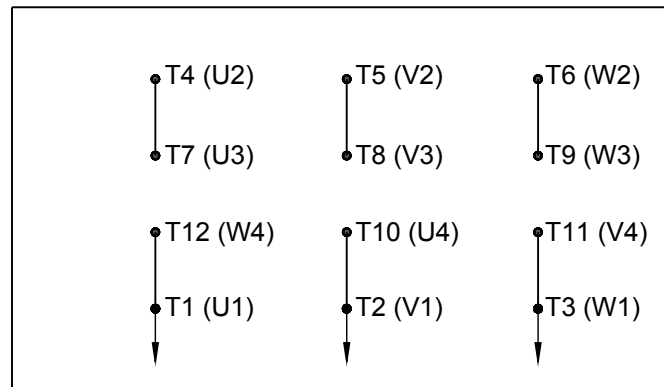

WYE START

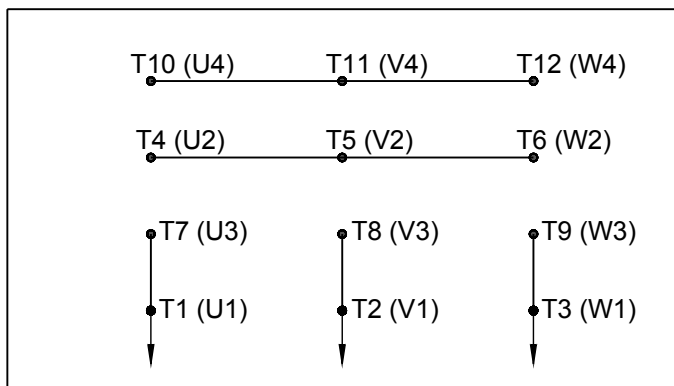

LOW VOLTAGE

DELTA RUN

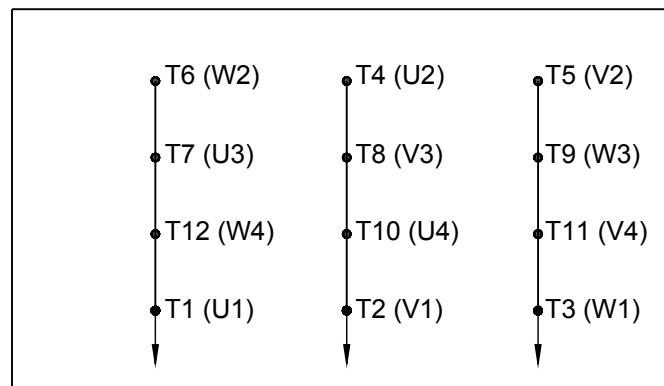

4/2 CKTY \triangle

DRAWING REVISION D	REVISION BY JWO	DATE 01-26-2016
ECO ECO-0092547	APPROVED BY TB	DATE 01-26-2016

ECO DESCRIPTION
ADDED IEC MARKINGS

COPYRIGHT REGAL BELOIT AMERICA, INC. ALL RIGHTS RESERVED. PROPRIETARY AND CONFIDENTIAL INFORMATION - THIS DOCUMENT IS THE PROPERTY OF REGAL BELOIT AMERICA, INC. ("OWNER") AND CONTAINS OWNER'S PROPRIETARY INFORMATION. ANY PERSON, CORPORATION OR OTHER FIRM RECEIVING IT IS DEEMED, BY RECEIVING IT, TO AGREE THAT IT, AND/OR ANY PART OF IT, SHALL NOT BE DISCLOSED TO ANY PERSON, CORPORATION OR OTHER ENTITY, DUPLICATED, AND/OR USED, EXCEPT AS EXPRESSLY APPROVED IN WRITING IN ADVANCE BY OWNER. THIS DOCUMENT SHALL BE RETURNED TO OWNER UPON REQUEST. IT MAY BE SUBJECT TO CERTAIN RESTRICTIONS UNDER APPLICABLE EXPORT CONTROL LAWS AND REGULATIONS.

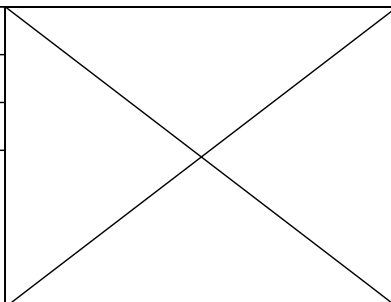

DRAWN BY BLR		Regal Beloit America, Inc.
DATE 03-09-1998		
APPROVED BY GK	DESCRIPTION CONN DIAGRAM-EXTERNAL	
DATE 03-23-1998	12 LEAD - DUAL VOLT. - WYE START - DELTA RUN	
REFERENCE	MATERIAL	PROCESS/FINISH
THIRD ANGLE PROJECTION	SIZE A	DRAWING NUMBER EE7358

SHEET 1 OF 1	
-----------------	--



P.O. BOX 8003
WAUSAU, WI 54401-8003
PH. 715-675-3311

DATA VOLTS: 460

CERTIFICATION DATA SHEET

CUSTOMER P.O. #:
 ORDER #: A-EE7358
 REFERENCE MODEL #: 324TTPA14071
 CONN. DIAGRAM: B-SS31077-1425
 CAT #: Y1618
 OUTLINE: K2864234
 CUSTOMER PART #:
 WINDING: NONE 6
 MOUNTING: F1/F2 CAPABLE
 SPEED:
 TYPICAL MOTOR PERFORMANCE DATA

HP	KW	SYNC RPM	FL RPM	FRAME	ENCLOSURE	TYPE	KVA CODE	DESIGN
40	30	1800	1782	324T	TEFC	TEP	G	B

PH	HZ	VOLTS	AMPS	START TYPE	DUTY	INSL	S.F.	AMB	ELEV.
3	60/50	230/460#190/380	100/50&91/45.5	WS(LV ONLY) & YDRU	CONT	F	1.15	40	3300
	F.L. EFF	93.0	3/4 LD EFF	93.6	1/2 LD EFF	93.6	GTD EFF	ELECT. TYPE	
	F.L. PF	81.0	3/4 LD PF	76.5	1/2 LD PF	66.5	91.7	SQ CAGE IND RUN	

F.L. TORQUE	LR AMPS @ 460 V	L.R. TORQUE	B.D. TORQUE	F.L. RISE (°C)
119 LB-FT	282	220 LB-FT	185%	315 LB-FT
@ 3 FT.	POWER	ROTOR WK ²	MAX. LOAD WK ²	SAFE STALL TIME
68 DBA	77 DBA	4.7 LB-FT ²	250 LB-FT ²	25 SEC.
				START/SHOUR
				2
				MOTOR WGT
				590 LB.

*** SUPPLEMENTAL INFORMATION ***

DE BRACKET TYPE	ODE BRACKET TYPE	MOUNT TYPE	MOTOR ORIENTATION	SEVERE DUTY	HAZARDOUS LOCATION	DRIP COVER	SCREENS	PAINT
STANDARD	STANDARD	RIGID	HORIZONTAL	NO	NONE	NO	NONE	RED (ENAMEL)
BEARINGS	GREASE	SHAFT TYPE	SPECIAL DE	SPECIAL ODE	SHAFT	MATERIAL	FRAME MATERIAL	
DE BALL 6312	BALL POLYREX EM	T	NONE	NONE	1045 HOT ROLLED (C-204)		CAST IRON	

THERMOSTATS	PROTECTORS	WDG RTD's	BRG RTD's	THERMISTORS	CONTROL	SPACE HEATERS
NONE	NOT	NONE	NONE	NONE	FALSE	NA
R1 (ohms/ph)	R2 (ohms/ph)	X1 (ohms/ph)	X2 (ohms/ph)	Xm (ohms/ph)	VIBRATION (in/sec)	FLOAT
0.104	0.106	0.557	0.674	11.628	0.150	ODE

N	INVERTER TORQUE: NONE
O	INV. HP SPEED RANGE: NONE
T	
E	ENCODER: NONE
S	NONE
	BRAKE: NONE
	FT-LB: NONE
	VOLTAGE: NONE
	UL: NONE
	NONE
	PPR

PREPARED BY: FAREEDA DUDEKULA
 DATE: 9/17/2018
 FORM: 3531 REV 4 2/27/06

Data Sheet

324TTFPA14071



Submital
Data @ 460 V

Date: 9/17/2018
 Customer: _____
 Attention: _____
 Submitted by: FAREEDA DUDEKULA

Load	Motor Load Data							LR
	0%	25%	50%	75%	100%	115%	125%	
Current (Amps)	21.0	23.2	30.0	39.0	50.0	57.0	61.5	282
Torque (ft-lb)	0.00	29.5	59.0	89.0	119	137	150	220
RPM	1800	1792	1782	1775	1762	1758	1750	0
Efficiency (%)		91.0	93.6	93.6	93.0	93.0	92.4	
P.F. (%)	4.0	44.0	66.5	76.5	81.0	82.0	82.5	36.0

Motor Speed Data					
	LR	Pull-Up	BD	Rated	Idle
Speed (RPM)	0	900	1650	1762	1800
Current (Amps)	282	250	170	50.0	21.0
Torque (ft-lb)	220	210	315	119	0.00

Information Block	
HP	40.0
Sync. RPM	1800
Frame	324182TTC6080
Enclosure	TEFC
Construction	TFF
Voltage	230/460#190/380 V
Frequency	60 Hz
Design	B
LR Code letter	G
Service Factor	1.15
Temp Rise @ FL	75 °C
Duty	CONT
Ambient	40 °C
Elevation	1,000 feet
Motor/Shaft Wk ²	4.7 Lb-Ft ²
Ret Wdg	K2864234 NONE
Sound Pressure @ 1M	68 dBA
VFD Rating	NONE
Outline Dwg	B-SS31077-1425
Conn. Diag	A-EE7358

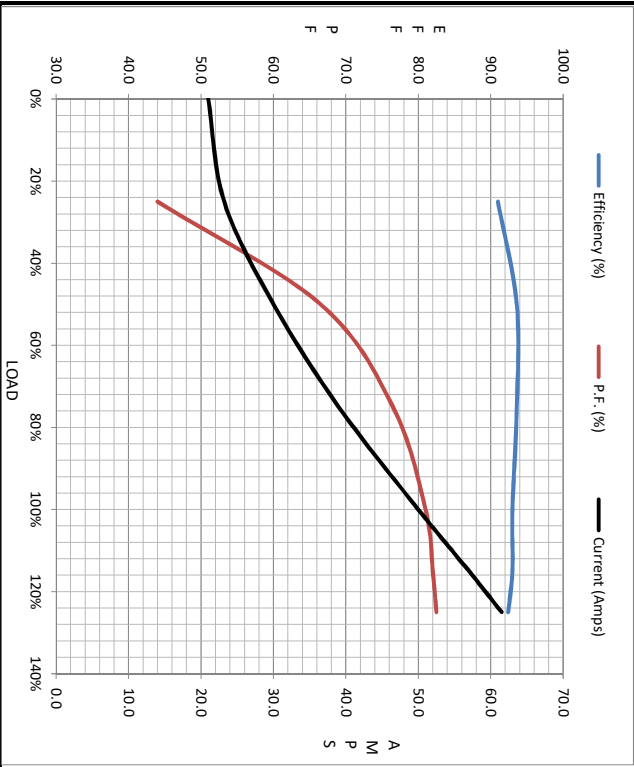

Additional Specifications:			
R1	R2	X1	X2
0.1040	0.1060	0.5570	0.6740
			Xm
			11.6280

