

PRODUCT INFORMATION PACKET

marathon[®]
Motors

Model No: 326TTDBD6082
Catalog No: GT0471
30,1200,DP,326JM,3/60/230/460
JM



Regal and Marathon are trademarks of Regal Beloit Corporation or one of its affiliated companies.
©2018 Regal Beloit Corporation, All Rights Reserved. MC017097E

REGAL[®]



Nameplate Specifications

| | | | |
|----------------------------|--------------------|------------------------|-------------------|
| Output HP | 30 Hp | Output KW | 22.4 kW |
| Frequency | 60 Hz | Voltage | 230/460 V |
| Current | 75.0/37.5 A | Speed | 1188 rpm |
| Service Factor | 1.15 | Phase | 3 |
| Efficiency | 93.6 % | Duty | Continuous |
| Insulation Class | F | Design Code | B |
| KVA Code | G | Frame | 326JM |
| Enclosure | Drip Proof | Overload Protector | No |
| Ambient Temperature | 40 °C | Drive End Bearing Size | 6312 |
| Opp Drive End Bearing Size | 6311 | UL | Recognized |
| CSA | Y | CE | Y |
| IP Code | 22 | | |

Technical Specifications

| | | | |
|-------------------|-------------------------------------|-----------------------|--|
| Electrical Type | Squirrel Cage Inverter Rated | Starting Method | Wye Start Delta Run Or Inverter |
| Poles | 6 | Rotation | Reversible |
| Mounting | Rigid base | Motor Orientation | Horizontal |
| Drive End Bearing | Ball | Opp Drive End Bearing | Ball |
| Frame Material | Rolled Steel | Shaft Type | JM |
| Frame Length | 15.74 in | Shaft Diameter | 1.249 in |
| Shaft Extension | 5.5 in | Assembly/Box Mounting | F1/F2 Capable |
| Outline Drawing | SS620798-326T | Connection Diagram | EE7308AA |

This is an uncontrolled document once printed or downloaded and is subject to change without notice. Date Created: 07/02/2018

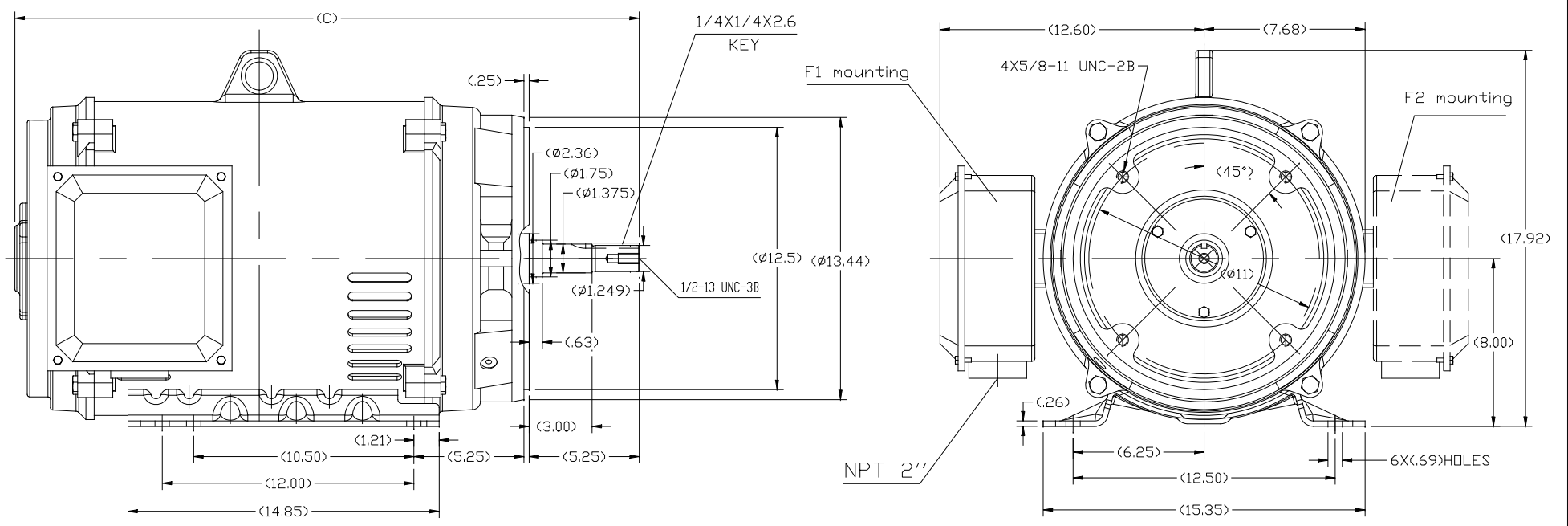

| | |
|-------|-------|
| 324T | 28.94 |
| 326T | 30.12 |
| FRAME | C |

| TOLERANCES UNLESS SPECIFIED | | REGAL REGAL-BELOIT CORPORATION | | DRAWN Xlaowei Zhu | |
|--|----------|--------------------------------|------------------------------|-------------------|-------------|
| DEC. | INCHES | | | CHK | Yan Wang |
| X | ±.1 | | | APPD | Yunhai Zou |
| .XX | ±.03 | TITLE | OUTLINE | SCALE | 1:1 |
| .XXX | ±.005 | | 324/326T-ODP-JM-ROLLED STEEL | REF | |
| .XXXX | ±.0005 | MAT'L. | | FMF | REGAL-WUXI |
| NO. | REVISION | BY & DATE | | PREV | |
| THIS DRAWING IN DESIGN AND DETAIL IS OUR PROPERTY AND MUST NOT BE USED EXCEPT IN CONNECTION WITH OUR WORK ALL RIGHTS OF DESIGN AND INVENTION ARE RESERVED THIS IS AN ELECTRONICALLY GENERATED DOCUMENT - DO NOT SCALE THIS PRINT | | CHK | ANG ±1/2" | FINISH | |
| | | RFP | CAD FILE SS620798 | SIZE | DRAWING NO. |
| | | DIST | | B | SS620798 |
| | | | | | REV. |



LOW VOLTAGE



HIGH VOLTAGE



VIEW OF TERMINAL END

| | | |
|---|------------------------------|---------------------------|
| DRAWING REVISION K | REVISION BY AJW | DATE 07-17-2015 |
| ECO ECO-0081632 | APPROVED BY T. VUE | DATE 07-17-2015 |
| ECO DESCRIPTION REV'D IEC MARKINGS PER IEC 60034-8 | | |
| <small> COPYRIGHT REGAL BELOIT AMERICA, INC. ALL RIGHTS RESERVED. PROPRIETARY AND CONFIDENTIAL INFORMATION - THIS DOCUMENT IS THE PROPERTY OF REGAL BELOIT AMERICA, INC. ("OWNER") AND CONTAINS OWNER'S PROPRIETARY INFORMATION. ANY PERSON, CORPORATION OR OTHER FIRM RECEIVING IT IS DEEMED, BY RECEIVING IT, TO AGREE THAT IT, AND/OR ANY PART OF IT, SHALL NOT BE DISCLOSED TO ANY PERSON, CORPORATION OR OTHER ENTITY, DUPLICATED, AND/OR USED, EXCEPT AS EXPRESSLY APPROVED IN WRITING IN ADVANCE BY OWNER. THIS DOCUMENT SHALL BE RETURNED TO OWNER UPON REQUEST. IT MAY BE SUBJECT TO CERTAIN RESTRICTIONS UNDER APPLICABLE EXPORT CONTROL LAWS AND REGULATIONS. </small> | | |

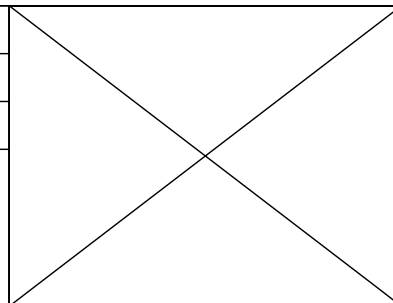

| | | |
|---------------------------|--|-----------------------------------|
| DRAWN BY LZ | Regal Beloit America, Inc. | |
| DATE 01-12-1994 | | |
| APPROVED BY GK | DESCRIPTION CONN DIAGRAM-EXTERNAL 3Ø-2/1 DELTA-12 LEADS | |
| DATE 01-14-1994 | | |
| REFERENCE | MATERIAL | PROCESS/FINISH |
| THIRD ANGLE PROJECTION | SIZE A | DRAWING NUMBER EE7308AA |
| | | SHEET 1 OF 1 |



**P.O. BOX 8003
WAUSAU, WI 54401-8003
PH. 715-675-3311**

CERTIFICATION DATA SHEET

CUSTOMER: CUSTOMER PO #:
ORDER #: MODEL #: 326TTDDBD6082 AA
CONN. DIAGRAM: EE7308AA CUSTOMER PART #:
OUTLINE: SS620798-326T MOUNTING: F1/F2 CAPABLE
WINDING #: HE32006007 2

TYPICAL MOTOR PERFORMANCE DATA

| HP | KW | SYNC. RPM | F.L. RPM | FRAME | ENCLOSURE | KVA CODE | DESIGN | |
|-------|-----------|-----------------|---------------|----------------------|------------|----------|-----------|-------|
| 30825 | 22.4&18.7 | 1200 | 1188&985 | 326JM | DP | G | B | |
| PH | Hz | VOLTS | AMPS | START TYPE | DUTY | INSL | S.F. | AMB°C |
| 3 | 60/50 | 230/460&190/380 | 75/37.5&74/37 | Y START D RUN OR INV | CONTINUOUS | F4 | 1.15/1.15 | 40 |

| | | | | | | | | |
|-----------------------|-----------|----------------------|------|----------------------|------|--------------------------|----|-------------------|
| FULL LOAD EFF: | 93.6&93.3 | 3/4 LOAD EFF: | 93.6 | 1/2 LOAD EFF: | 93.3 | GTD. EFF | 93 | ELEC. TYPE |
| FULL LOAD PF: | 79.5&80.5 | 3/4 LOAD PF: | 75 | 1/2 LOAD PF: | 64 | SQ CAGE INV RATED | | |

| | | | | |
|--------------------|--------------------------|--------------------|--------------------|--------------------|
| F.L. TORQUE | LOCKED ROTOR AMPS | L.R. TORQUE | B.D. TORQUE | F.L. RISE°C |
| 133 LB-FT | 420 / 210 | 239 LB-FT 180 % | 319 LB-FT 240 % | 40 |

| | | | | | | |
|-------------------------------|--------------------|-------------------|------------------|------------------------|----------------------|--------------------------|
| SOUND PRESSURE @ 3 FT. | SOUND POWER | ROTOR WK^2 | MAX. WK^2 | SAFE STALL TIME | STARTS / HOUR | APPROX. MOTOR WGT |
| 69 DBA | 79 DBA | 13.8 LB-FT^2 | 500 LB-FT^2 | 20 SEC. | 2 | 650 LBS. |

***** SUPPLEMENTAL INFORMATION *****

| DE BRACKET TYPE | ODE BRACKET TYPE | MOUNT TYPE | ORIENTATION | SEVERE DUTY | HAZARDOUS LOCATION | DRIP COVER | SCREENS | PAINT |
|-----------------|------------------|------------|-------------|-------------|--------------------|------------|---------|---------------|
| C-FACE | STANDARD | RIGID | HORIZONTAL | FALSE | NONE | FALSE | NONE | BLUE (ENAMEL) |

| BEARINGS | | GREASE | SHAFT TYPE | SPECIAL DE | SPECIAL ODE | SHAFT MATERIAL | FRAME MATERIAL |
|----------|----------|------------|------------|------------|-------------|-------------------------|----------------|
| DE BALL | ODE BALL | POLYREX EM | JM | NONE | NONE | 1045 HOT ROLLED (C-204) | ROLLED STEEL |
| 6312 | 6311 | | | | | | |

| THERMO-PROTECTORS | | | | THERMISTORS | | | SPACE HEATERS | |
|-------------------|------------|----------|----------|-------------|-------|------|---------------|-------|
| THERMOSTATS | PROTECTORS | WDG RTDS | BRG RTDS | NONE | FALSE | NONE | NONE | VOLTS |
| NONE | NOT | NONE | NONE | | | | | |

| | | |
|-------------------------------|------------------------------------|----------------|
| * INVERTER | TORQUE: CONSTANT 2:1/VARIABLE 20:1 | |
| N INV. HP SPEED RANGE: | NONE | |
| O ENCODER: | NONE | |
| T NONE | NONE | PPR |
| E NONE | NONE | P/N NONE |
| S NONE | FT-LB | NONE V NONE HZ |
| * NONE | | |

PREPARED BY: Anusha Muthyala
DATE: 05/04/2018 12:33:25 AM
FORM 3531 REV.3 02/07/99
**** Subject to change without notice.**

MARATHON ELECTRIC CORPORATION

TYPICAL PERFORMANCE CURVE for AC MOTOR

Customer _____ Curve at 460 Volts HP 30&25 PHASE 3
 Model No 326TTDBD6082 60 HZ
30 HP VOLTS 230/460&190/380
 Catalog No GT0471 HZ 60&50 RPM 1188&985

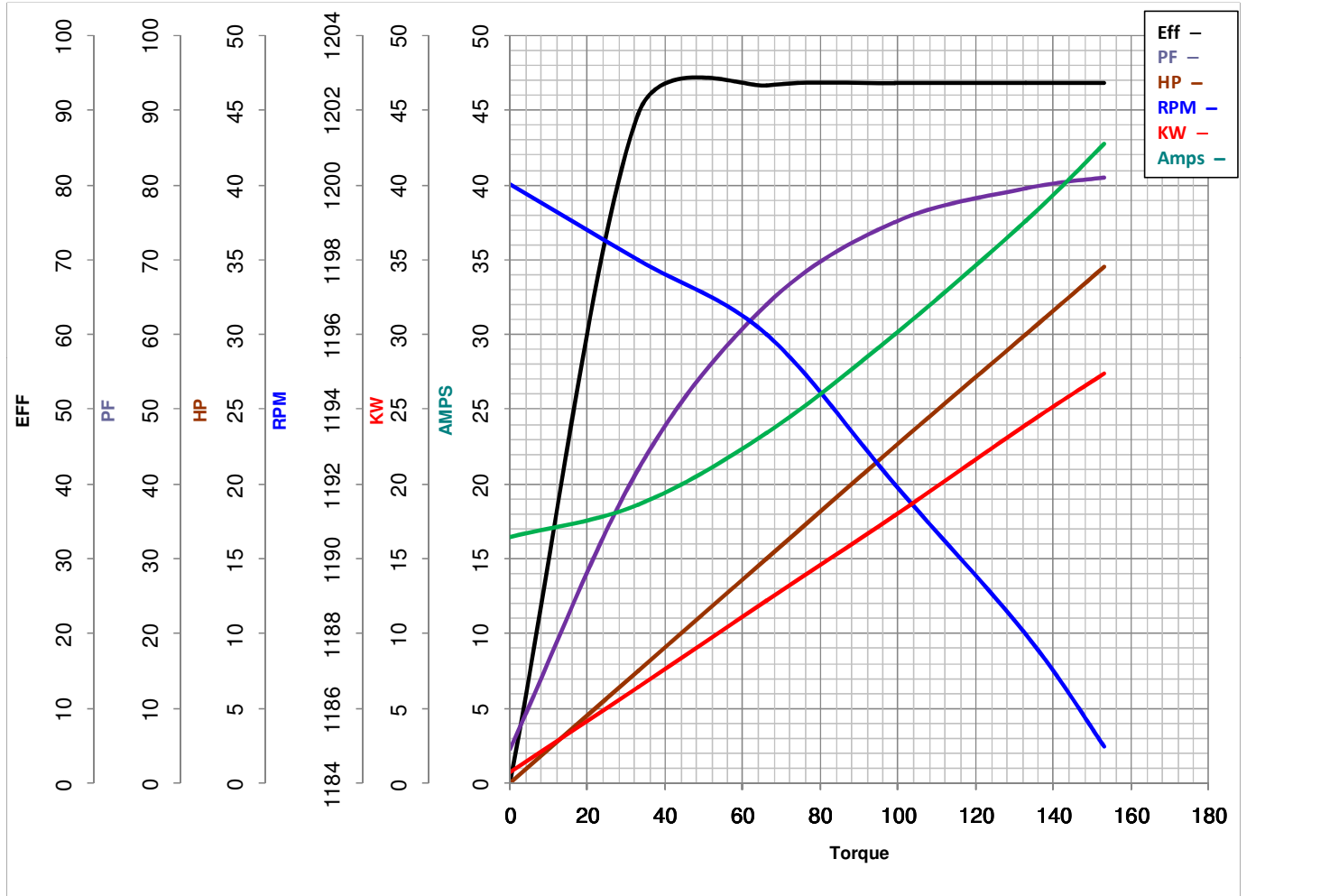

| | | | | |
|------------------|--------------|--------------------|------------------|----------------------|
| FL TORQUE | <u>133</u> | Lb.Ft | FL AMPS | <u>75/37.5</u> |
| BD TORQUE | <u>319.0</u> | Lb.Ft | PU TORQUE | <u>200.0</u> Lb.Ft |
| LR TORQUE | <u>239</u> | Lb.Ft | LR AMPS | <u>210</u> |
| WINDING | HE32006007-2 | Prepared By | ANUSHA M | Date 5/4/2018 |