

# PRODUCT INFORMATION PACKET



Model No: 5KC49MN6379

Catalog No: C1818

Explosion Proof Motor, 0.25 HP, 1 Ph, 60 Hz, 115 V, 1200 RPM, 56CZ Frame, EPFC

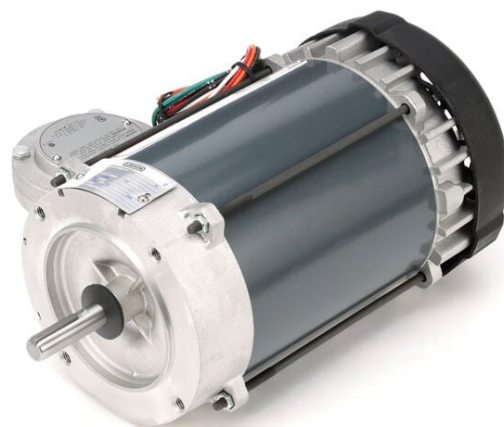

Regal and LEESON are trademarks of Regal Rexnord Corporation or one of its affiliated companies.  
©2025 Regal Rexnord Corporation, All Rights Reserved. MC017097E





**Nameplate Specifications**

Phase	1	Output HP	0.25 Hp
Output KW	0.19 kW	Voltage	115 V
Speed	1140 rpm	Service Factor	1.0
Frame	56CZ	Enclosure	Explosion Proof Fan cooled
Thermal Protection	Automatic	Efficiency	55 %
Ambient Temperature	40 °C	Frequency	60 Hz
Current	5.6 A	Power Factor	53
Duty	Continuous	Insulation Class	B
Design Code	NO DESIGN CODE	KVA Code	K
Drive End Bearing Size	6203	Opp Drive End Bearing Size	6203
UL	UL Listed And CSA Certified	CSA	Y
CE	N	IP Code	54
Number of Speeds	1	Hazardous Location	EXP PROOF CL I GR C&D CL II GR F&G T3B

**Technical Specifications**

Electrical Type	Capacitor Start Induction Run	Starting Method	Across The Line
Poles	6	Rotation	Selective Counterclockwise
Resistance Main	0 Ohms	Mounting	Round
Motor Orientation	Horizontal	Drive End Bearing	Ball
Opp Drive End Bearing	Ball	Frame Material	Rolled Steel
Shaft Type	Single Special Extension	Overall Length	14.30 in
Frame Length	6.81 in	Shaft Diameter	0.625 in
Shaft Extension	2.42 in	Assembly/Box Mounting	F1 ONLY
Connection Drawing	A-102005-110-GE	Outline Drawing	B-105902GE-681

4

3

2

1

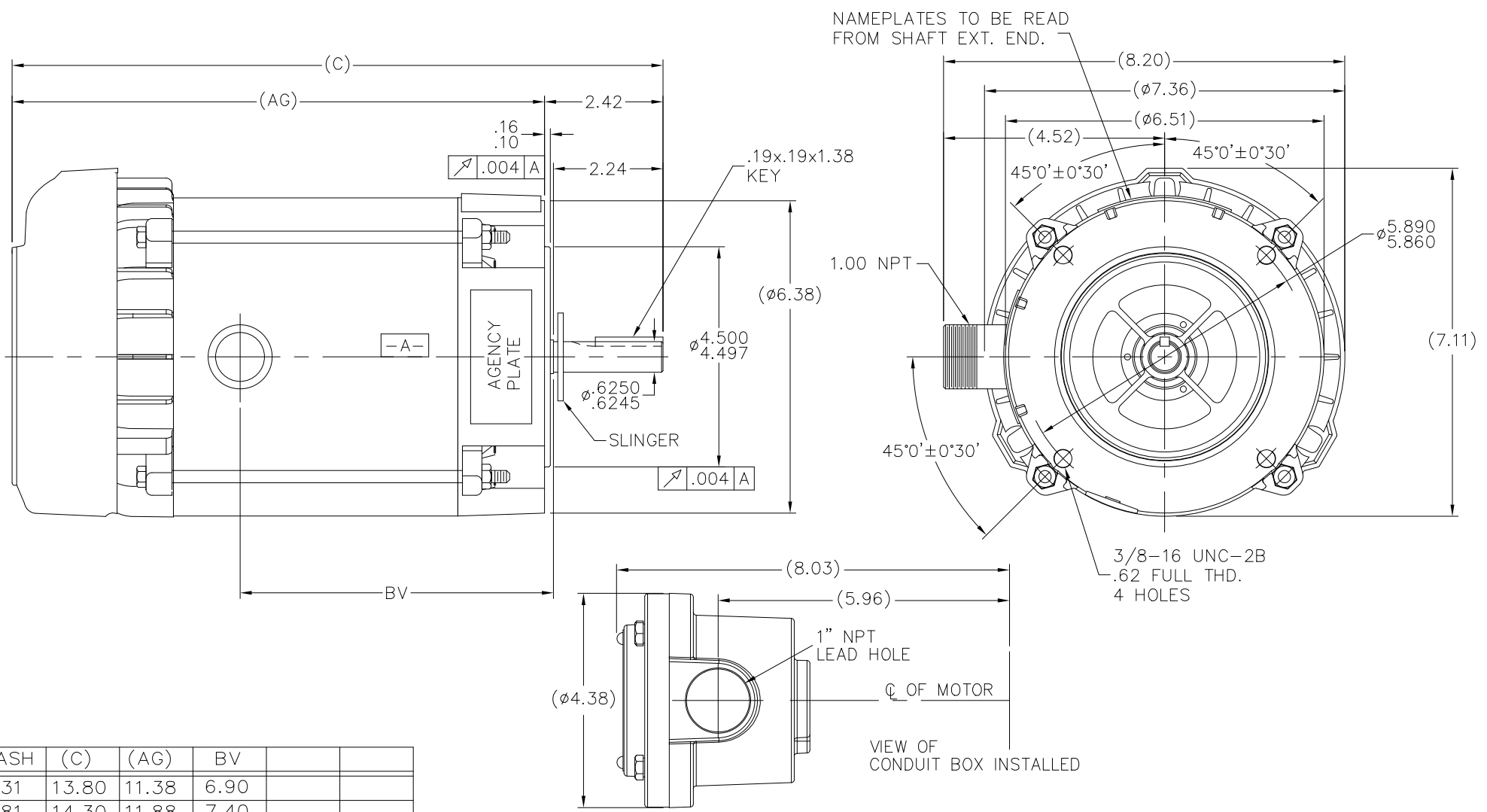

DASH	(C)	(AG)	BV		
631	13.80	11.38	6.90		
681	14.30	11.88	7.40		
731	14.80	12.38	7.90		
781	15.30	12.88	8.40		
831	15.80	13.38	8.90		
881	16.30	13.88	9.40		
931	16.80	14.38	9.90		
981	17.30	14.88	10.40		

DRAWING REVISION H	REVISION BY D. VALENCIANO	DATE 05/07/2022	TOLERANCES UNLESS OTHERWISE SPECIFIED DEC. INCH mm ANGLE .X ±0.1 [±2.5] ±0.5° .XX ±0.02 [±0.51] .XXX ±0.005 [±0.127] XXXX ±0.0005 [±0.0127]	DRAWN BY: WNMKLEIST	Regal Beloit America, Inc.
ECR-0217254	APPROVED BY M. DURAN	DATE 05/07/2022	REMOVE BURRS & BREAK SHARP EDGES .003/015 [076/381]X 45° CORNER FILLETS R.02 [51] MACHINED SURFACES 125/ INCH 32/ mm SHOWN IN BRACKETS	DATE: 12-10-04	
ECO DESCRIPTION SEE ECR			THIRD ANGLE PROJECTION	APPROVED BY: ML	DESCRIPTION OUTLINE 'C' FACE-56FR-EXP. PR.-SPL EXTENSION
COPYRIGHT REGAL BELOIT AMERICA, INC. ALL RIGHTS RESERVED. PROPRIETARY AND CONFIDENTIAL INFORMATION - THIS DOCUMENT IS THE PROPERTY OF REGAL BELOIT AMERICA, INC. ("OWNER") AND CONTAINS OWNER'S PROPRIETARY INFORMATION. ANY PERSON, CORPORATION OR OTHER ENTITY RECEIVING IT IS DEMAND BY RECEIVING IT, TO AGREE THAT IT, AND/OR ANY PART OF IT, SHALL NOT BE DISCLOSED TO ANY PERSON, CORPORATION OR OTHER ENTITY, DUPLICATED, AND/OR USED, EXCEPT AS EXPRESSLY APPROVED IN WRITING IN ADVANCE BY OWNER. THIS DOCUMENT SHALL BE RETURNED TO OWNER UPON REQUEST. IT MAY BE SUBJECT TO CERTAIN RESTRICTIONS UNDER APPLICABLE EXPORT CONTROL LAWS AND REGULATIONS.			REFERENCE	MATERIAL	PROCESS/FINISH
			SIZE DWG NO C 105902GE	SHEET 1	

4

3

2

1

SINGLE VOLTAGE  
CAPACITOR START  
OVERLOAD SELECT ROT.

LOW VOLTAGE - C.W.

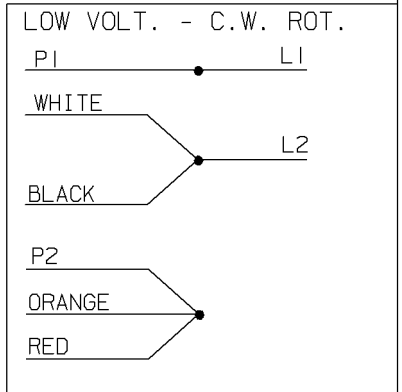
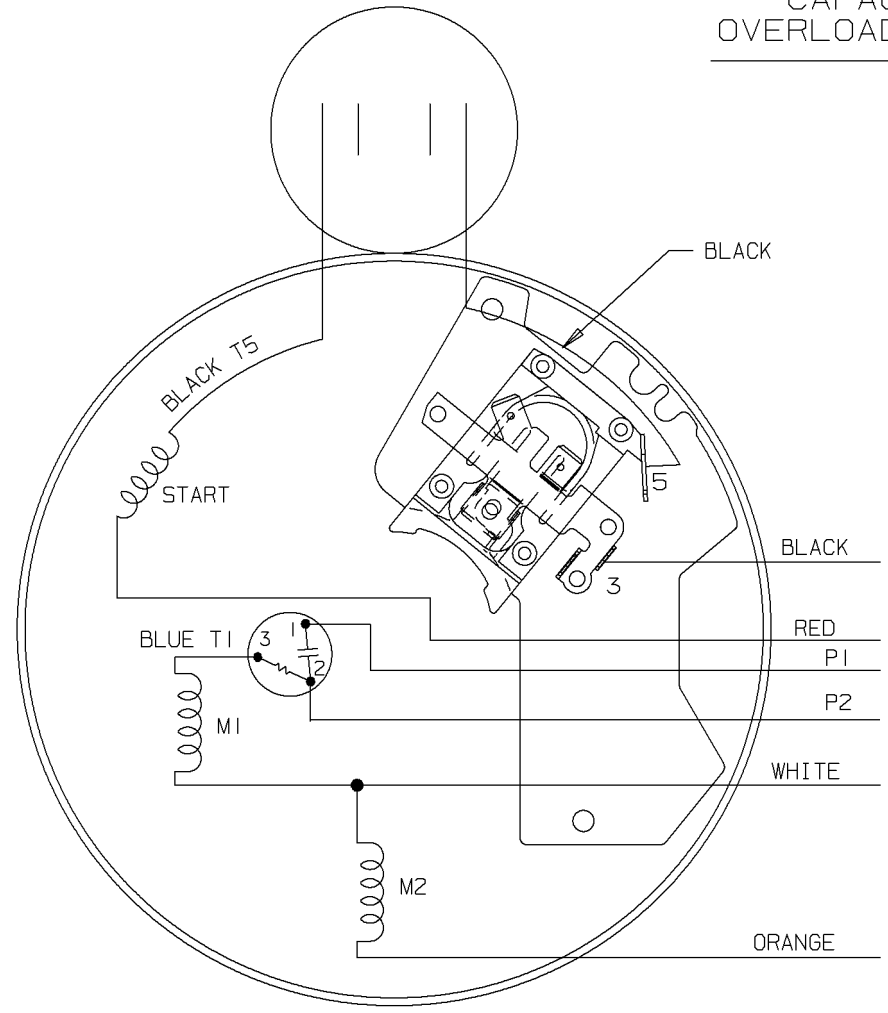
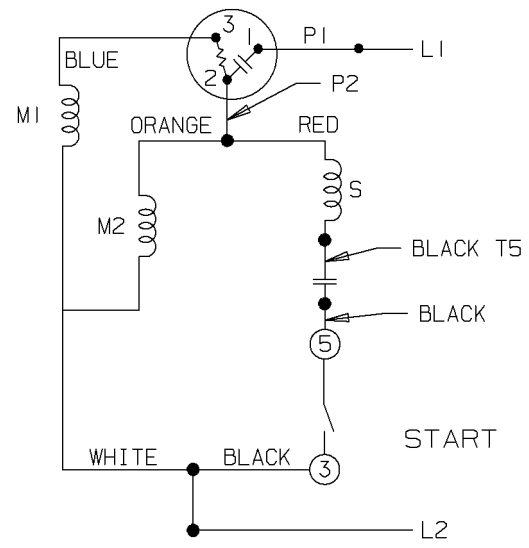

FOR C.C.W. ROTATION  
EITHER VOLTAGE  
INTERCHANGE RED  
WITH BLACK LEAD

A	07/31/2025	UPDATED FROM MARATHON TO RRX LOGO	KVDG	✓ MAX. SURFACE ROUGHNESS UNLESS NOTED OTHERWISE	UNLESS OTHERWISE SPECIFIED DIMENSIONS ARE IN INCHES TOL. ON XX± XXX±.005 XXXX±.0005 ANGLES±			
2	06-14-2001	ROTATION CW WAS CCW CCW WAS CW CN 31595	HLB	MATL SPEC	Regal Beloit America, Inc.			DRAWN BY MRB 04-09-1999
1	04-19-1999	NEW DRAWING CN 27714	MRB	FINISH				CHKD BY ML 04-12-1999
REV	DATE	CHANGE	NAME	REFERENCE DRW.				APPD BY ET 04-15-1999
				PART NAME CONNECTION DIAGRAM	DRWG NO A-102005-110			

SHOP BOOK | PURCHASED | DISTRIBUTION - WA - LB - WP - LM - BR | CADD FILE NO. | 102005-110







**REGAL REXNORD CORPORATION**  
TYPICAL PERFORMANCE CURVE for AC MOTOR

Customer

Curve at

115 Volts  
60 HZ  
0.25 HP

HP 0.25

PHASE 1

Model No 5KC49MN6379

VOLTS 115

Catalog No C1818

HZ 60

RPM 1140

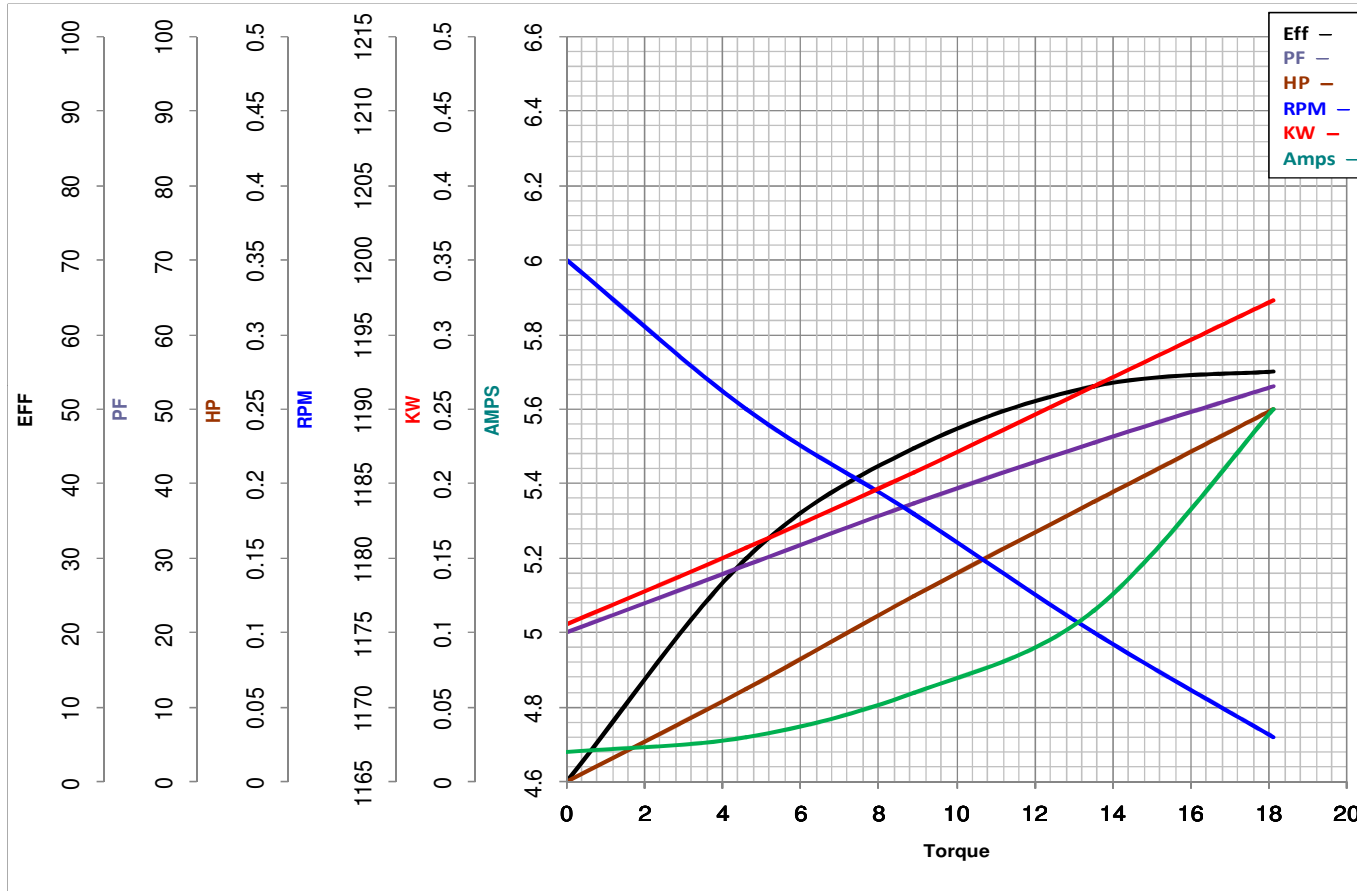

		Torque in Oz.Ft			
FL TORQUE	<u>18.1</u>	Oz.Ft	FL AMPS	<u>5.6</u>	
BD TORQUE	<u>44.4</u>	Oz.Ft	PU TORQUE	<u>31.8</u>	Oz.Ft
LR TORQUE	<u>43.5</u>	Oz.Ft	LR AMPS	<u>19.2</u>	
WINDING	ZC630-3		Date	1/11/2019	