

PRODUCT INFORMATION PACKET



Model No: C4T17DC52A

Catalog No: 103725.00

3/4HP..1725RPM.S56J.DP.230/460V.3PH.60HZ.CONT.40C.1.25SF.C-FACE.C4T17DC52.....JET
PUMP.NONE.....

Jet Pump



Regal and Leeson are trademarks of Regal Beloit Corporation or one of its affiliated companies.

©2018 Regal Beloit Corporation, All Rights Reserved. MC017097E





Nameplate Specifications

Output HP	0.75 Hp	Output KW	0.56 kW
Frequency	60 Hz	Voltage	230/460 V
Current	2.8/1.4 A	Speed	1725 rpm
Service Factor	1.25	Phase	3
Efficiency	75.5 %	Duty	Continuous
Insulation Class	B	Design Code	NO DESIGN CODE
KVA Code	L	Frame	S56J
Enclosure	Drip Proof	Overload Protector	No
Ambient Temperature	40 °C	Drive End Bearing Size	6203
Opp Drive End Bearing Size	6203	UL	Recognized
CSA	Y	CE	N
IP Code	12		

Technical Specifications

Electrical Type	Squirrel Cage Induction Run	Starting Method	Across The Line
Poles	4	Rotation	Reversible
Mounting	Round	Motor Orientation	HORIZONTAL
Drive End Bearing	BALL	Opp Drive End Bearing	BALL
Frame Material	Rolled Steel	Shaft Type	J
Overall Length	11.00 in	Frame Length	6.50 in
Shaft Diameter	0.625 in	Shaft Extension	2.44 in
Assembly/Box Mounting	F1 ONLY		
Outline Drawing	SS404006LE-650	Connection Diagram	005010.01

SS404006LE

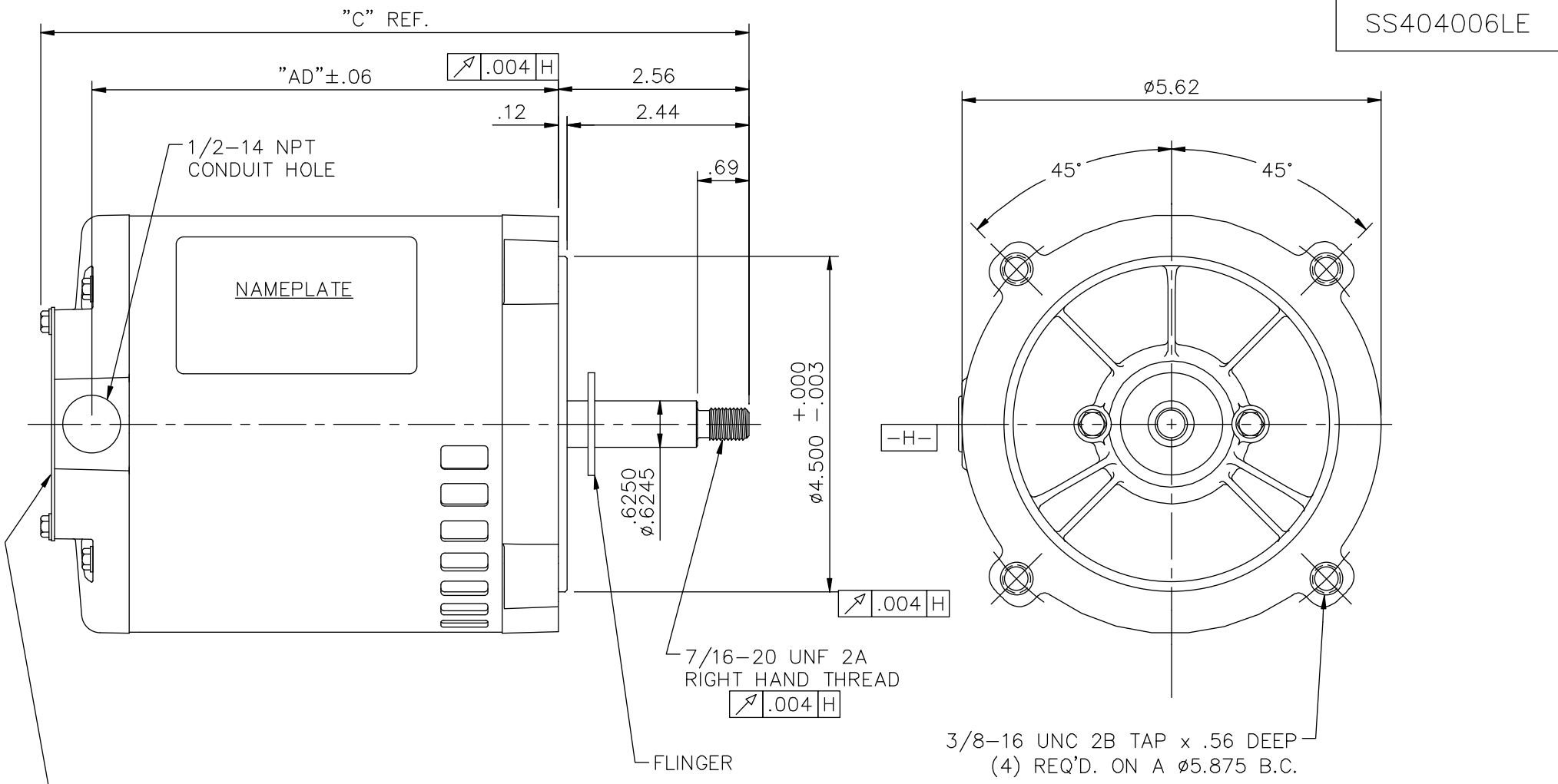

DASH NO.	"C"	"AD"	DASH NO.	"C"	"AD"
500	9.50	6.25	600	10.50	7.25
525	9.75	6.50	625	10.75	7.50
550	10.00	6.75	650	11.00	7.75
575	10.25	7.00	675	11.25	8.00

SCREWDRIVER SLOT IN SHAFT

TOLERANCES UNLESS SPECIFIED	
DEC.	INCHES
.X	±.1
.XX	±.03
.XXX	±.005
.XXXX	±.0005



ELECTRIC MOTORS
GEARMOTORS
AND DRIVES

DRAWN	SVL 3-20-13
CHK	
APPD	
SCALE	1=2
REF	031801
FMF	103725.00
PREV	

TITLE
OUTLINE - S56J FRAME
RIGID "C" FACE - DRIP PROOF

MAT'L.
3 PHASE

FINISH

NO.	REVISION	BY & DATE	CHK	ANG
			RFP	3-20-13
			DIST	

CAD FILE	SS404006LE	SIZE	DRAWING NO.	REV.
		A	SS404006LE	

THIS DRAWING IN DESIGN AND DETAIL IS OUR PROPERTY AND MUST NOT BE USED EXCEPT IN CONNECTION WITH OUR WORK ALL RIGHTS OF DESIGN AND INVENTION ARE RESERVED THIS IS AN ELECTRONICALLY GENERATED DOCUMENT - DO NOT SCALE THIS PRINT

005010-01

VIEW FROM OUTSIDE OF MOTOR AT SWITCH END.



VOLTAGE	L1	L2	L3	JOIN & INSULATE
HIGH	T1	T2	T3	(T4,T7) (T5,T8) (T6,T9)
LOW	T1,T7	T2,T8	T3,T9	T4,T5,T6

				TOLERANCES UNLESS SPECIFIED		REGAL ™ Regal Beloit America, Inc.		DRAWN RDW 04/12/02		
				DEC.	INCHES			CHK		
				.X	±.1			APPD		
				.XX	±.01	TITLE EXTERNAL WIRING DIAGRAM 3 PHASE W/O PROTECTOR		SCALE 1=1		
				.XXX	±.005			REF FIG.2-51		
A	UPDATED TO REGAL LOGO	SAJ 06/26/15	AJY	.XXXX	±.0005	MAT'L DECAL - 004014		FMF		
NO.	REVISION	BY & DATE	CHK	ANG	±1/2"	FINISH		PREV		
THIS DRAWING IN DESIGN AND DETAIL IS OUR PROPERTY AND MUST NOT BE USED EXCEPT IN CONNECTION WITH OUR WORK ALL RIGHTS OF DESIGN AND INVENTION ARE RESERVED THIS IS AN ELECTRONICALLY GENERATED DOCUMENT - DO NOT SCALE THIS PRINT				RFP	04/12/02	CAD FILE 00501001		SIZE	DRAWING NO.	REV.
				DIST BRF-NLV		A	005010-01	A		

Data Sheet

Date: 1/22/2018

103725.00



Data @ 460 V

Motor Load Data						
Load	0%	25%	50%	75%	100%	LR
Current (Amps)	0.97	1.00	1.10	1.20	1.40	9.0
Torque (ft-lb)	0.00	0.55	1.10	1.70	2.28	8.8
RPM	1800	1780	1765	1748	1725	0
Efficiency (%)		51.5	66.5	73.0	75.5	76.5
P.F. (%)	19.0	34.5	50.0	62.0	70.5	75.5

Motor Speed Data						Information Block										
LR	Pull-Up	BD	Rated	Idle		HP	0.8	1800	56	DP	TDR	230/460	V	60	Hz	
Speed (RPM)	0	600	995	1725	1800	Sync. RPM	1800	Frame	56	Enclosure	DP	Construction	TDR	Voltage	230/460	V
Current (Amps)	9.0	7.5	6.6	1.40	0.97	Frequency	60	Design	B	LR Code letter	L	Service Factor	1.15	Temp Rise @ FL	45	°C
Torque (ft-lb)	8.8	9.2	9.8	2.28	0.00	Duty	CONT	Ambient	40	Elevation	1,000	feet	Rotor/Shaft wk ²	0.06	LB-Ft ²	

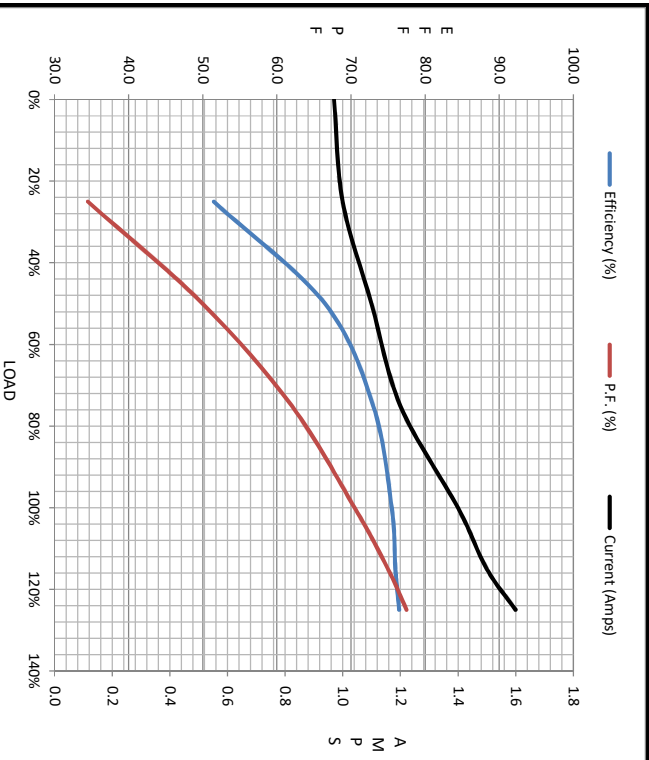

Outline Dwg	OL103725			
Conn. Diag	005010.01			
Additional Specifications:				
0				
EQUIV CKT (OHMS / PHASE)				
R1	R2	X1	X2	Xm
0.0000	0.0000	0.0000	0.0000	0.0000
VFD Rating	NONE	Sound Pressure @ 1M	56	dB(A)
Rel Wdg	TE48412 DR			

