

Hub City™ IndustriaLine™ Bearing Units

Series 100, 200 - Ratings

SHAFT SIZE (INCHES)	BASIC DYNAMIC RATING	BASIC STATIC RATING	BEARING RADIAL LOAD CAPACITY IN POUNDS BASED ON L-10 LIFE OF 500 HOURS AND STEADY LOAD CONDITIONS (2500 HOURS AVERAGE LIFE)							
			BEARING SPEED - REVOLUTIONS PER MINUTE (RPM)							
			100	500	1,000	1,500	2,000	2,500	3,000	3,500
1/2, 5/8	2,110	1,120	1,460	860	680	590	540	500	470	450
3/4	2,610	1,440	1,810	1,060	840	740	670	620	580	560
7/8, 15/16, 1	2,800	1,650	1,950	1,140	900	790	720	670	630	600
1-1/8, 1-3/16, 1-1/4S	4,380	2,570	3,040	1,780	1,410	1,230	1,120	1,040	980	930
1-1/4, 1-3/8, 1-7/16	5,780	3,490	4,010	2,350	1,860	1,630	1,480	1,360	1,290	—
1-1/2	7,340	4,470	5,100	2,980	2,370	2,070	1,880	1,750	1,650	—
1-5/8, 1-11/16, 1-3/4	7,900	5,140	5,480	3,210	2,540	2,220	2,020	1,880	—	—
1-15/16, 2S	7,890	5,220	5,480	3,200	2,540	2,220	2,020	1,870	—	—
2, 2-3/16	9,750	6,600	6,770	3,960	3,140	2,740	2,490	—	—	—
2-1/4, 2-7/16	11,790	8,150	8,190	4,790	3,800	3,320	3,020	—	—	—
2-15/16	14,840	11,220	10,300	6,020	4,780	4,170	—	—	—	—

Maximum Recommended Speeds:

1-7/16 and smaller	-	3,500 R.P.M.
1-1/2 – 1-3/4	-	3,000 R.P.M.
1-7/8 – 2-7/16	-	2,500 R.P.M.
2-15/16	-	1,800 R.P.M.

For ultimate life, snug fit or light press on shaft should be used.
Recommended operating temperature range: -25° to +225°F.

For Applications not covered in the table above, consult the factory.

TO MODIFY THE ABOVE RATINGS FOR OTHER L-10 LIFE REQUIREMENTS OR FOR SHOCK LOADS MULTIPLY THE ABOVE RATINGS BY THE FACTOR FROM THIS CHART														
LOAD CONDITIONS	MODIFICATION FACTORS FOR L-10 SERVICE LIFE AND LOAD CONDITIONS:													
	L-10 LIFE (HOURS)													
	500	700	1,000	1,500	2,000	3,000	4,000	5,000	7,000	10,000	15,000	20,000	30,000	50,000
Steady Load	1.00	.894	.794	.694	.630	.550	.500	.464	.415	.368	.322	.292	.255	.215
Light Shock	.90	.804	.715	.624	.567	.495	.450	.418	.373	.331	.290	.263	.230	.194
Moderate Shock	.70	.626	.556	.485	.441	.385	.350	.325	.290	.258	.225	.205	.179	.151

Dimensions shown are for reference only.

Hub City™ IndustriaLine™ Bearing Units

Take-Up Frames

Series TWS200

TWS200 Wide Slot Take-Up Frames

- Welded steel construction
- Plated adjusting screw

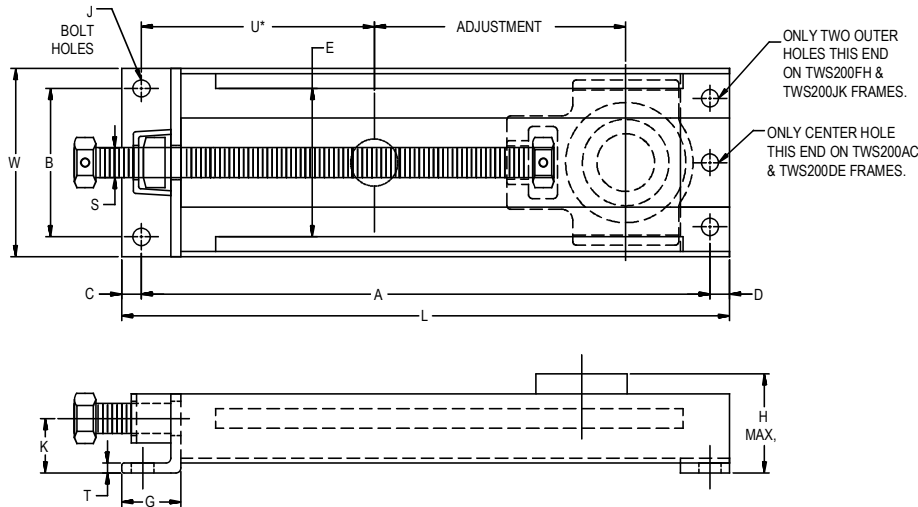

PART NUMBER	SHAFT SIZE RANGE			ADJUSTMENT	DIMENSIONS											(J) BOLT HOLES		WT. LBS.	
	FOR "200" SERIES UNITS	FOR "300" SERIES UNITS			L	W	A	B	C	D	E	G	H MAX.	K	S	T	NO.		SIZE
1TWS200AC	1/2 - 1			1-1/2	7.000	4.063	6.000	3.188	.500	.500	3.063	1.500	2.438	1.375	.625	.250	3	.563	3.3
3TWS200AC	1/2 - 1			3	8.500	4.063	7.500	3.188	.500	.500	3.063	1.500	2.438	1.375	.625	.250	3	.563	3.9
6TWS200AC	1/2 - 1			6	11.500	4.063	10.500	3.188	.500	.500	3.063	1.500	2.438	1.375	.625	.250	3	.563	5.1
9TWS200AC	1/2 - 1			9	14.500	4.063	13.500	3.188	.500	.500	3.063	1.500	2.438	1.375	.625	.250	3	.563	6.2
3TWS200DE	1-1/8 - 1-7/16	1 - 1-1/4		3	9.500	4.688	8.375	3.688	.500	.500	3.563	1.500	2.656	1.375	.750	.250	3	.563	5.4
6TWS200DE	1-1/8 - 1-7/16	1 - 1-1/4		6	12.500	4.688	11.375	3.688	.500	.500	3.563	1.500	2.656	1.375	.750	.250	3	.563	6.7
9TWS200DE	1-1/8 - 1-7/16	1 - 1-1/4		9	15.500	4.688	14.375	3.688	.500	.500	3.563	1.500	2.656	1.375	.750	.250	3	.563	8.1
12TWS200DE	1-1/8 - 1-7/16	1 - 1-1/4		12	18.500	4.688	17.375	3.688	.500	.500	3.563	1.500	2.656	1.375	.750	.250	3	.563	9.5
3TWS200FH	1-1/2 - 2S	1-7/16 - 1-3/4		3	11.500	5.063	9.875	3.063	1.00	.625	4.063	2.000	3.125	1.625	1.000	.250	4	.563	7.4
6TWS200FH	1-1/2 - 2S	1-7/16 - 1-3/4		6	14.500	5.063	12.875	3.063	1.00	.625	4.063	2.000	3.125	1.625	1.000	.250	4	.563	9.1
9TWS200FH	1-1/2 - 2S	1-7/16 - 1-3/4		9	17.500	5.063	15.875	3.063	1.00	.625	4.063	2.000	3.125	1.625	1.000	.250	4	.563	10.8
12TWS200FH	1-1/2 - 2S	1-7/16 - 1-3/4		12	20.500	5.063	18.875	3.063	1.00	.625	4.063	2.000	3.125	1.625	1.000	.250	4	.563	12.5
18TWS200FH	1-1/2 - 2S	1-7/16 - 1-3/4		18	24.500	5.063	24.875	3.063	1.00	.625	4.063	2.000	3.125	1.625	1.000	.250	4	.563	15.9
9TWS200JK	2 - 2-7/16	1-15/16 - 2-3/16		9	18.250	6.313	16.875	4.125	1.00	.750	5.188	2.000	3.719	1.875	1.250	.313	4	.688	20.0
12TWS200JK	2 - 2-7/16	1-15/16 - 2-3/16		12	21.250	6.313	19.875	4.125	1.00	.750	5.188	2.000	3.719	1.875	1.250	.313	4	.688	22.8
18TWS200JK	2 - 2-7/16	1-15/16 - 2-3/16		18	27.250	6.313	25.875	4.125	1.00	.750	5.188	2.000	3.719	1.875	1.250	.313	4	.688	28.2

These take-up frames are used with WSTU220, WSTU250, WSTU220W and WSTU250W take-up units shown on pages I-30 and I-31 and with WSTU350 take-up units shown on Page I-41.

*NOTE - "U" may have more than one value, depending on the take-up unit and frame combination used, therefore determine "U" from frame dimensions "G" minus "C" plus take-up unit dimensions "A", "C" and "F".

DIMENSIONS SHOWN ARE FOR REFERENCE ONLY.

DOWNLOAD AVAILABLE CAD MODELS AT: WWW.HUBCITYINC.COM

Certified prints are available upon request