

# STRONG THREADS MADE EASY

All solid construction E-Z LOK threaded inserts install with standard tools. No special drills...no special taps...no special installation tools.

E-Z LOK external threads are standard size and pitch to permit the use of standard drills and taps. E-Z LOKs can be installed with a screwdriver, bolt/jam nut (except IC series), or optional power drive tool.

E-Z LOKs will not back out or vibrate loose. Immediately upon installation, microencapsulated adhesive begins to set and the newly installed inserts are fastener-ready in 3-5 minutes.

The adhesive seals against liquids and gases to 6,000 psi when fully cured (72 hours).



Power drive tools are available for high volume installation... See insert tables for catalog numbers and sizes.

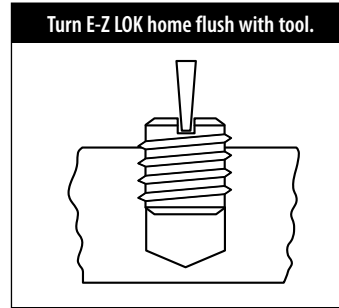
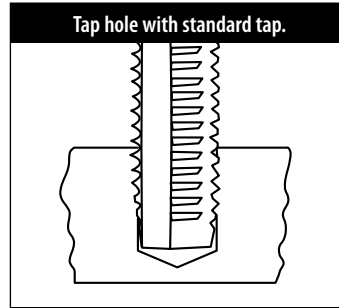
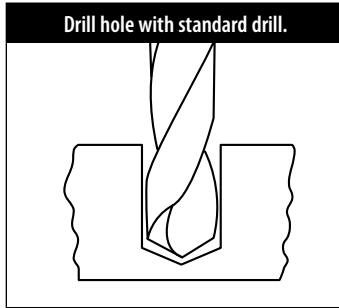

## E-Z LOK CARBON STEEL INSERTS FOR METAL



### COARSE THREAD SIZES

EZ-LOK Part No.	Internal Thread	External Thread	Length in.	Tap Drill Size	Tap Size	Minimum Full Thread Depth	Drive Tool Catalog No.
329-004	4-40	10-32	.250	5/32	10-32	9/32	500-004
329-006	6-32	1/4-20	.280	7	1/4-20	11/32	500-006
329-008	8-32	5/16-18	.290	F	5/16-18	7/16	500-1
329-3	10-24	3/8-16	.406	5/16	3/8-16	15/32	500-2
329-4	1/4-20	7/16-14	.437	U	7/16-14	1/2	500-3
329-401	1/4-20	7/16-14	1.000	U	7/16-14	1-1/8	500-3
329-5	5/16-18	1/2-13	.484	27/64	1/2-13	9/16	500-4
329-501	5/16-18	1/2-13	1.000	27/64	1/2-13	1-1/8	500-4
329-6	3/8-16	9/16-12	.515	31/64	9/16-12	19/32	500-5
329-601	3/8-16	9/16-12	1.000	31/64	9/16-12	1-1/8	500-5
329-7	7/16-14	5/8-11	.656	17/32	5/8-11	23/32	500-6
329-8	1/2-13	3/4-10	.656	21/32	3/4-10	3/4	500-7
329-801	1/2-13	3/4-10	1.000	21/32	3/4-10	1-1/8	500-7
329-9	9/16-12	3/4-10	.656	21/32	3/4-10	3/4	500-7
329-10	5/8-11	7/8-9	.687	49/64	7/8-9	13/16	500-8
329-1018	5/8-11	7/8-9	1.125	49/64	7/8-9	1-1/4	500-8
329-12	3/4-10	1-8	.781	7/8	1-8	7/8	500-9
329-14	7/8-9	1-1/4-7	1.125	1-7/64	1-1/4-7	1-1/4	500-10
329-16	1-8	1-3/8-12	1.250	1-9/32	1-3/8-12	1-3/8	500-11

### FINE THREAD SIZES

EZ-LOK Part No.	Internal Thread	External Thread	Length in.	Tap Drill Size	Tap Size	Minimum Full Thread Depth	Drive Tool Catalog No.
329-332	10-32	3/8-16	.406	5/16	3/8-16	15/32	500-2
329-428	1/4-28	7/16-14	.437	U	7/16-14	1/2	500-3
329-524	5/16-24	1/2-13	.484	27/64	1/2-13	9/16	500-4
329-624	3/8-24	9/16-12	.515	31/64	9/16-12	19/32	500-5
329-720	7/16-20	5/8-11	.656	17/32	5/8-11	23/32	500-6
329-820	1/2-20	3/4-10	.656	21/32	3/4-10	3/4	500-7
329-918	9/16-18	3/4-10	.656	21/32	3/4-10	3/4	500-7
329-10F	5/8-18	7/8-9	.687	49/64	7/8-9	13/16	500-8
329-1216	3/4-16	1-8	.781	7/8	1-8	7/8	500-9
329-1414	7/8-14	1-1/4-7	1.125	1-7/64	1-1/4-7	1-1/4	500-10
329-1614	1-14	1-3/8-12	1.250	1-9/32	1-3/8-12	1-3/8	500-11