

# GasAlertQuattro Multi-Gas (1-4) Detector (continued)

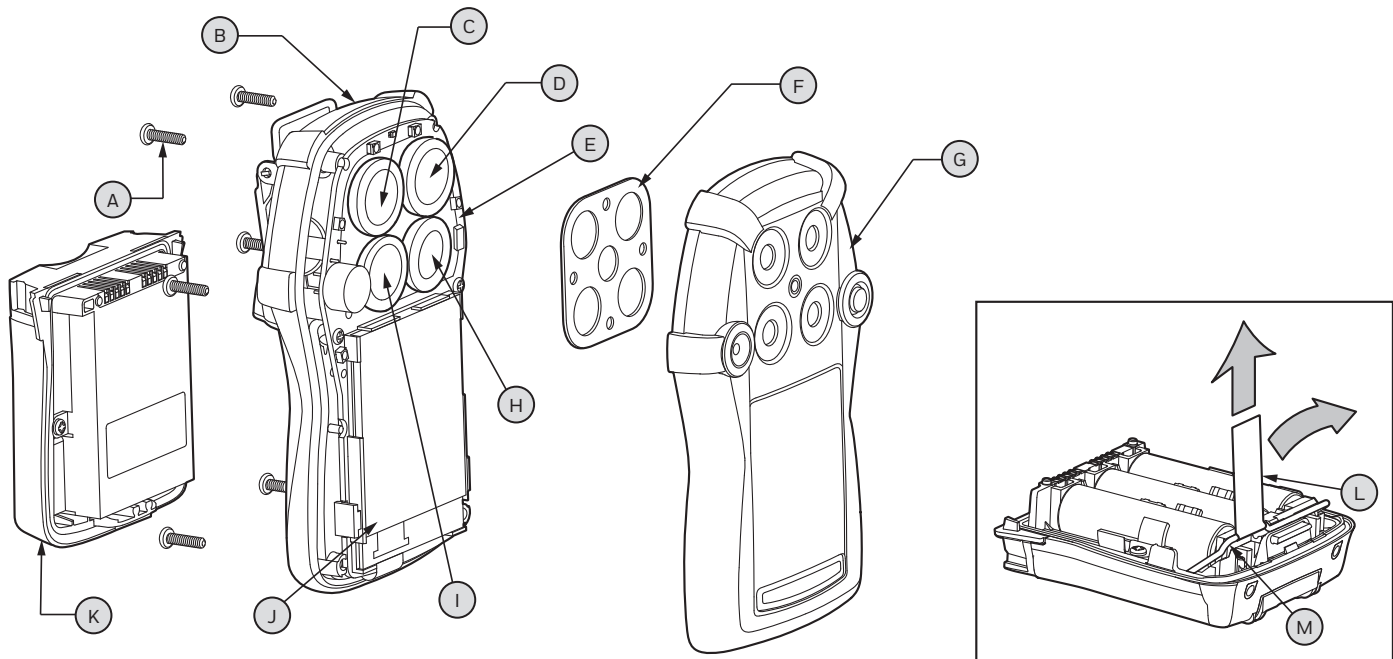

Legend	Service Parts	Order Number	Price (USD)
A	Replacement screw kit (kit of 40 screws)	QT-SCREW-K1	\$11.00
B	Replacement back enclosure (yellow) with screws	QT-BC1	\$29.00
	Replacement back enclosure (black) with screws	QT-BC1B	\$29.00
C, D	Replacement sensors, see page 27		
E	Replacement main PCB and sensor PCB kit	QT-PCB-K1	\$273.00
F	Replacement sensor screens, see page 27		
G	Replacement front enclosure (yellow)	QT-FC1	\$29.00
	Replacement front enclosure (black)	QT-FC1B	\$29.00
H, I	Replacement sensors, see page 27		
J	Replacement LCD kit	QT-LCD-K1	\$34.00
K	Replacement battery pack, see page 26		
	Replacement vibration motor	GA-VM-2	\$18.00
	Replacement alligator-style clip (stainless steel with screw)	XT-AG-1	\$30.00

## How to Replace a Sensor

1. With detector OFF, remove battery pack from back of instrument
2. Use No. 1 Phillips screwdriver to remove 6 screws from back enclosure (B)
3. Lift front enclosure (G) straight up
4. Remove sensor (C, D, H, I) from PCB (C) by pulling straight up
5. Insert new sensor (C, D, H, I) into socket
6. Replace front enclosure (G)
7. Replace 6 screws in back enclosure (B) and hand-tighten until firm

## How to Replace the Sensor Screen

1. With detector OFF, remove battery pack from back of instrument
2. Use No. 1 Phillips screwdriver to remove 6 screws from back enclosure (B)
3. Lift front enclosure (G) straight up
4. Remove sensor screen (F) from front enclosure (G) by pulling straight up
5. Insert new sensor screen (F) into front enclosure (G)
6. Replace front enclosure (G)
7. Replace 6 screws in back enclosure (B) and hand-tighten until firm

## How to Replace the Alkaline Batteries in the Battery Pack

1. With detector OFF, remove battery pack from back of instrument
2. On battery pack, pull on tab (L) until ejector bar (M) releases from the ejector bar holder
3. Pull ejector bar (M) straight up (on side opposite of tab) until batteries dislocate from battery pack
4. Insert new batteries, one by one, inserting positive (+) end first
5. Important: push the ejector bar (M) into the lever holder until fully secured\*
6. Insert battery pack into detector

\*Failure to perform step 5 properly could result in damage to the batteries, battery pack and/or detector

Note: Please refer to the instrument's documentation (shipped with the product or available at [www.honeywellanalytics.com](http://www.honeywellanalytics.com)) for complete instructions on common service procedures. Improper servicing or maintenance may affect warranty eligibility. Honeywell assumes no liability for damages resulting from improper servicing or maintenance.