

Contender™ Series Factory Sealed Front Operated Tumbler Switches

Explosionproof, Dust-Ignitionproof

Malleable Iron Body and Cover. Furnished with Internal Ground.

NEC/CEC:

Class I, Division 1, Groups C, D

Class I, Division 2, Group B♦, C, D

Class II, Division 1 and 2, Groups E, F, G

Class III

NEMA 3, 7CD, 9EFG

Applications

- Designed to prevent arcing of enclosed switches in ignitable atmospheres during connect and disconnect operation of lighting and light power loads.
- For use in classified areas where ignitable vapors, gases or highly combustible dusts are present.
- For installation in:
 - Chemical plants
 - Petrochemical plants
 - Refineries
 - Other process industries

Features

- Factory sealed switches are designed to a UL Standard so that any arcing devices are contained within an explosionproof labyrinth switch (standard switch and sealing chamber on select models). Tumbler switch devices are approved for installation without additional external sealing fittings.
- Enclosures have external mounting lugs for ease of mounting.
- Smooth, rounded integral bushing in each hub protects conductor insulation.
- Enclosures furnished with internal ground screw.
- 20 Amp and 30 Amp units available for use with 120-277 Vac.
- Smooth ground mating surfaces assure flame-tight joint between cover and mounting enclosure.
- Stainless steel hex head cap screws for attaching cover to mounting enclosure.
- Choice of front-operating or side rocker arm handle—each may be locked in ON or OFF position.
- Each handle has close-tolerance threaded stainless steel shaft to meet Explosionproof requirements.
- Enclosures furnished with internal ground screw.

Options

- 1- or 2-gang copperfree (4/10 of 1% max.) aluminum bodies and covers available. Add suffix – **SA**.
- NPBRKT nameplate mounting bracket to make circuit description/identification easy.
 - Pre-drilled holes in bottom of bracket allow direct mounting to control stations with existing cover bolts.
 - Pre-drilled holes in middle of bracket allow mounting of customer's circuit identification nameplate; epoxy glue may also be used for mounting (phenolic nameplate not included).
 - Bracket eliminates costly field installation of drilling and tapping to accommodate circuit identification nameplate.
 - Brackets fit side-by-side on 2-, 3- and 4-gang boxes and 3-devices.

Standard Materials

- Body and cover: malleable iron
- Handle: nylon 6/6
- Optional nameplate mounting bracket: corrosion resistant stainless steel

Standard Finishes

- Tumbler switches: triple-coat—(1) zinc electroplate, (2) chromate, and (3) epoxy powder coat

NEC/CEC Certifications and Compliances

- UL Standards: UL 894, UL 1203
- CSA Standards: C22.2 No. 14
- cULus Listed: E10523, E81751

♦ Indicates items which are suitable for Class I, Division 2, Group B. See product selection pages for suitable items.



Illustrated Features

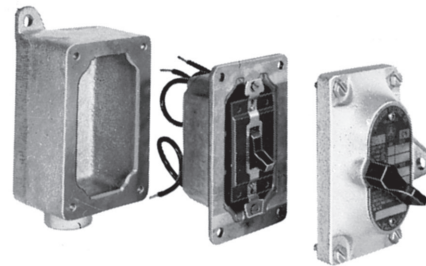

Separate sealing chamber and switch construction.
Used on 20 Amp 4-way and all 30 Amp models.

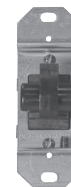

Explosionproof Labyrinth Switch
Used on all 20 Amp models excluding 4-way.

APPLETON™

CONTROLS: NEC/CEC EXPLOSIONPROOF CONTROL STATIONS AND SWITCHES

Contender™ Series Factory Sealed Front Operated Tumbler Switches

Explosionproof, Dust-Ignitionproof

Malleable Iron Body and Cover. Furnished with Internal Ground.

NEC/CEC:

Class I, Division 1, Groups C, D
Class I, Division 2, Group B♦, C, D
Class II, Division 1 and 2, Groups E, F, G
Class III
NEMA 3, 7CD, 9EFG

APPLETON™

CONTROLS: NEC/CEC EXPLOSIONPROOF CONTROL STATIONS AND SWITCHES



Dead-End



Feed-Thru

20 Amp — 120-277 Vac ②

Hub Size (Inches)	Switch	Dead-End	Feed-Thru
1/2	1-Pole	EDS1129 ♦	EDSC1129 ♦
1/2	2-Pole	EDS118 ♦	EDSC118 ♦
1/2	3-Way	EDS1130 ♦	EDSC1130 ♦
1/2	4-Way	EDS1140	EDSC1140
3/4	1-Pole	EDS2129 ♦	EDSC2129 ♦
3/4	2-Pole	EDS218 ♦	EDSC218 ♦
3/4	3-Way	EDS2130 ♦	EDSC2130 ♦
3/4	4-Way	EDS2140	EDSC2140
1	1-Pole	EDS3129 ♦	EDSC3129 ♦
1	2-Pole	EDS318 ♦	EDSC318 ♦
1	3-Way	EDS3130 ♦	EDSC3130 ♦
1	4-Way	EDS3140	EDSC3140

30 Amp — 120-277 Vac ③

1	1-Pole	EDS3591	EDSC3591
1	2-Pole	EDS3593	EDSC3593
1	3-Way	EDS3594	EDSC3594

2-Gang



Dead-End



Feed-Thru

20 Amp — 120-277 Vac ②

1/2	1-Pole	EDS1229 ♦	EDSC1229 ♦
1/2	2-Pole	EDS128 ♦	EDSC128 ♦
1/2	3-Way	EDS1230 ♦	EDSC1230 ♦
1/2	4-Way	EDS1240	EDSC1240
3/4	1-Pole	EDS2229 ♦	EDSC2229 ♦
3/4	2-Pole	EDS228 ♦	EDSC228 ♦
3/4	3-Way	EDS2230 ♦	EDSC2230 ♦
3/4	4-Way	EDS2240	EDSC2240
1	1-Pole	EDS3229 ♦	EDSC3229 ♦
1	2-Pole	EDS328 ♦	EDSC328 ♦
1	3-Way	EDS3230 ♦	EDSC3230 ♦
1	4-Way	EDS3240	EDSC3240

① For Aluminum body and cover, add suffix —SA.

② 20 Amp Switches 1 HP at 120 Vac and 2 HP at 240 Vac.

③ 30 Amp Switches 2 HP at 120 Vac or 240 Vac.

♦ Contains Factory Sealed Switch; no sealing chamber. Suitable for Class I, Division 2, Group B.

Contender™ Series Factory Sealed Front Operated Tumbler Switches

NEC/CEC:

Class I, Division 1, Groups C, D

Class I, Division 2, Group B♦, C, D

Class II, Division 1 and 2, Groups E, F, G

Class III

NEMA 3, 7CD, 9EFG

Dimensions in Millimeters (Inches)

Front Operated Tumbler Switches

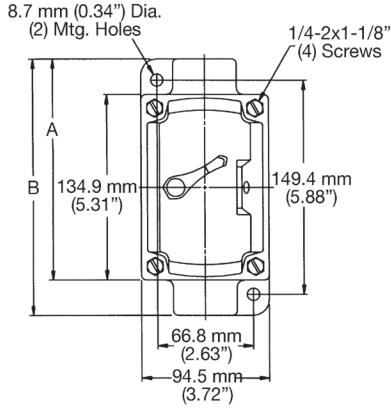

Front — 1-Gang

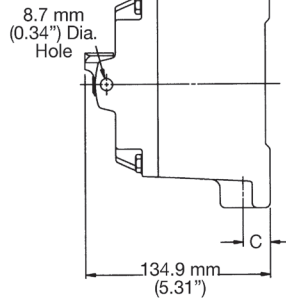

Side

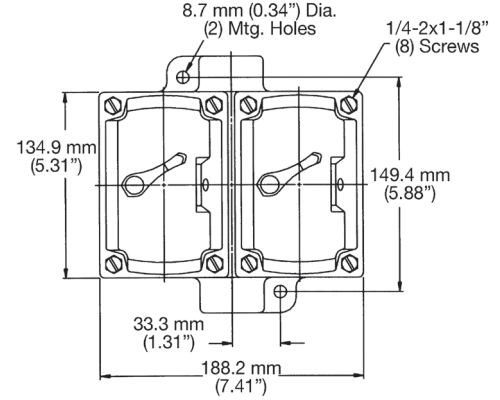

Front — 2-Gang

Hub Size (Inches)	Dimensions in Millimeters (Inches)		
	A	B	C
1/2 and 3/4	153.9 (6.06)	173.0 (6.81)	19.1 (0.88)
1	156.7 (6.17)	178.6 (7.03)	25.4 (1.00)

Dimensions in Millimeters (Inches)

NPBRKT Nameplate Mounting Bracket

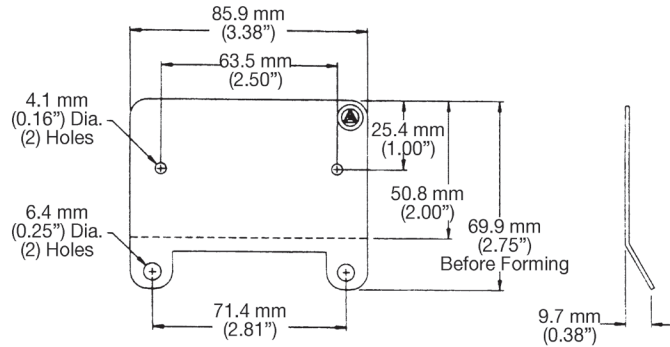

Secure bracket under cover screws of box. Torque cover screws to 35" - lbs.

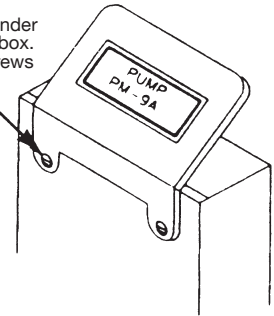

♦ Indicates items which are suitable for Class I, Division 2, Group B. See product selection pages for suitable items.