

Lamb® Performance

6.6" Bypass Tangential Vacuum Motors - High Vacuum and Pressure Performance

Model: 122754-27

MECHANICAL

DIAMETER: 6.6" (162mm)
DISCHARGE TYPE: Bypass
DISCHARGE: "True" Tangential

PERFORMANCE

STAGES: 2
SPEED: Single

DESIGN APPLICATIONS

Central vac cleaning systems
Car wash vac and blower systems
Equipment requiring separation of working air & motor ventilating air

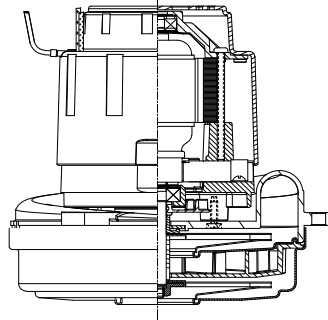

ELECTRICAL

OPERATING INPUT VOLTAGE: 240 volts AC

FEATURES

160" Sealed Suction
Under 15 Amps
High Efficiency "Galaxy" Lamination
Double Ball Bearings; 10 mm output
Improved Sound Quality
High Efficiency Performance
1000+ Hours Life
Metal Motor Bracket

REGULATORY CERTIFICATIONS

cRUus recognized, category PRGY2/8 (E47185)
Class B (E56617)

TYPICAL MOTOR PERFORMANCE.*

(At 240 volts, 60Hz, test data is corrected to standard conditions of 29.92 Hg, 68° F.)

ASTM DATA

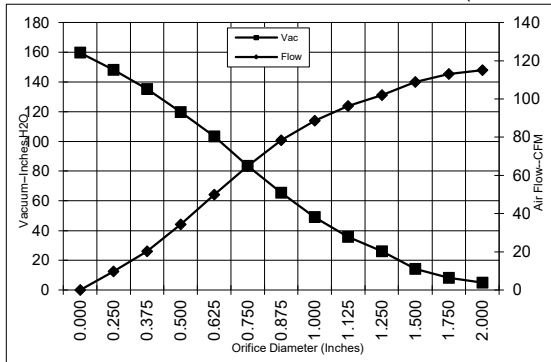

Orifice (Inches)	Amps	Watts (In)	RPM	Vac (In.H ₂ O)	Flow (CFM)	Air Watts
2.000	7.5	1696	26380	4.9	115.0	66
1.750	7.5	1697	26347	8.1	113.0	108
1.500	7.6	1702	26284	14.3	108.8	183
1.250	7.6	1713	26204	26.2	102.0	313
1.125	7.7	1722	26141	35.8	96.3	404
1.000	7.7	1731	26085	49.0	88.7	510
0.875	7.7	1733	26072	65.4	78.4	602
0.750	7.6	1717	26186	83.5	64.9	636
0.625	7.4	1664	26553	103.5	49.9	606
0.500	6.9	1551	27428	119.9	34.3	483
0.375	6.2	1399	28646	135.4	20.4	324
0.250	5.4	1242	30170	148.2	9.8	170
0.000	4.8	1110	31620	159.7	0.0	0

METRIC DATA

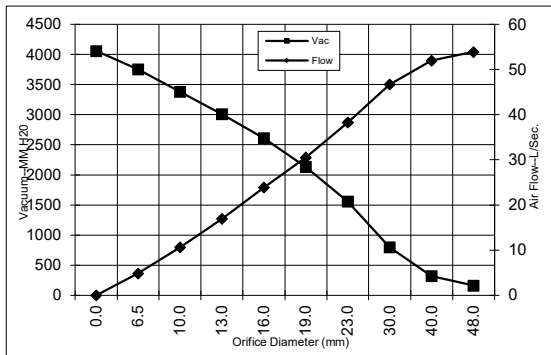

Orifice (mm)	Amps	Watts (In)	RPM	Vac (mm H ₂ O)	Flow (L/Sec)	Air Watts
48.0	7.5	1697	26366	160	53.9	84
40.0	7.6	1701	26303	317	51.9	160
30.0	7.7	1718	26169	799	46.7	363
23.0	7.7	1733	26075	1556	38.2	579
19.0	7.6	1716	26193	2132	30.5	635
16.0	7.4	1667	26539	2607	23.8	607
13.0	6.9	1562	27340	3003	16.9	495
10.0	6.3	1422	28463	3380	10.6	348
6.5	5.5	1250	30093	3749	4.9	177
0.0	4.8	1110	31620	4057	0.0	0

Note: Metric Performance data is calculated from the ASTM data above.

* Data represents performance of a typical motor sampled from a large production quantity. Individual motor data may vary due to normal manufacturing variations.

Test Specs:	240-Volts	Minimum Sealed Vacuum:	157.0	ORIFICE:	7/8"	Min. Vacuum:	57.0	Maximum Watts:	1825
-------------	-----------	------------------------	-------	----------	------	--------------	------	----------------	------

Lamb® | Nautilair® | Prestolite Motors | ROTRON® | Windjammer®

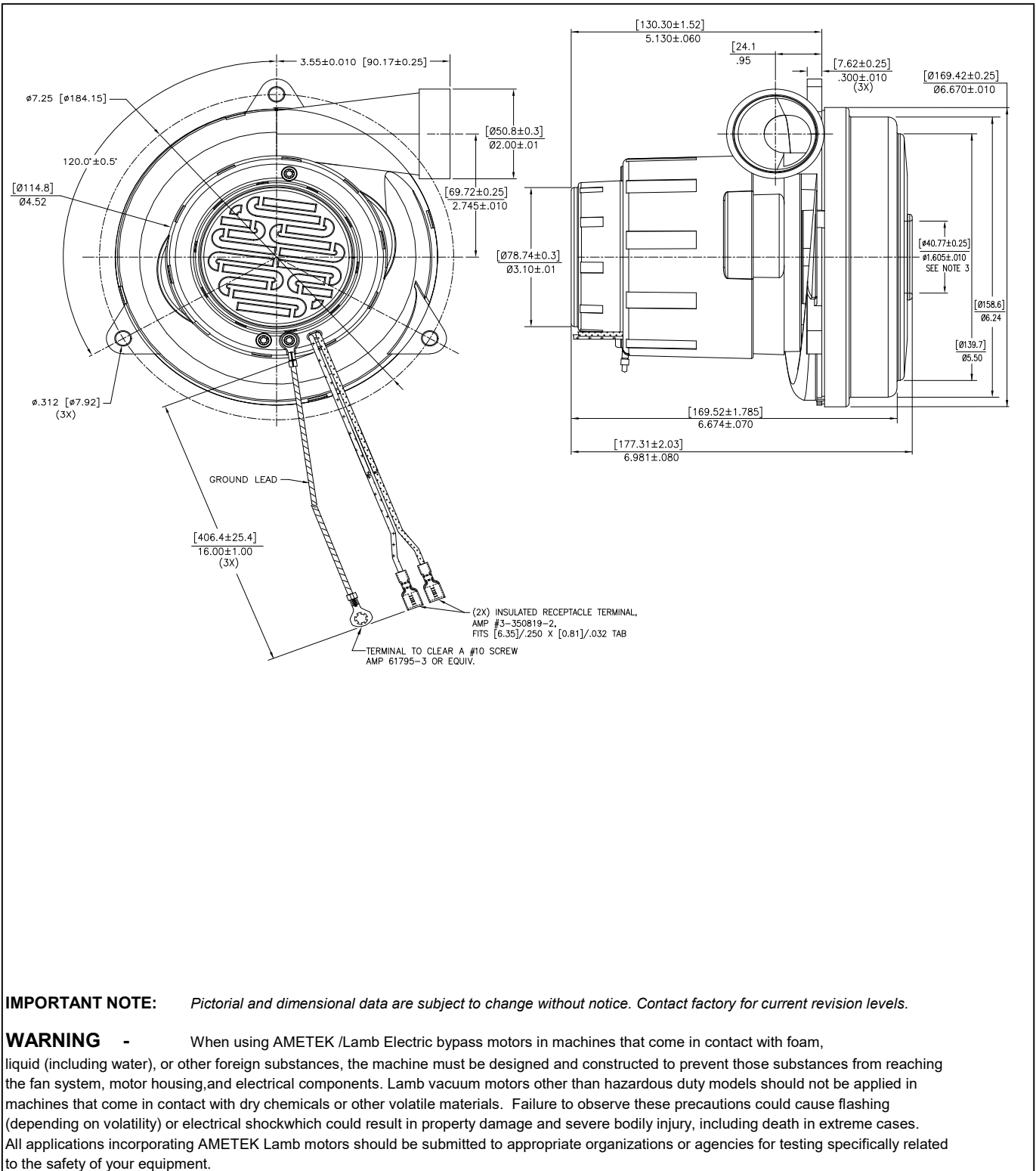

IMPORTANT NOTE: Pictorial and dimensional data are subject to change without notice. Contact factory for current revision levels.

WARNING - When using AMETEK /Lamb Electric bypass motors in machines that come in contact with foam, liquid (including water), or other foreign substances, the machine must be designed and constructed to prevent those substances from reaching the fan system, motor housing, and electrical components. Lamb vacuum motors other than hazardous duty models should not be applied in machines that come in contact with dry chemicals or other volatile materials. Failure to observe these precautions could cause flashing (depending on volatility) or electrical shock which could result in property damage and severe bodily injury, including death in extreme cases. All applications incorporating AMETEK Lamb motors should be submitted to appropriate organizations or agencies for testing specifically related to the safety of your equipment.

AMETEK Dynamic Fluid Solutions
 100 East Erie St. Suite 200
 Kent, OH USA 44240
AMETEKDFS.com