



Floorcare & Specialty Motors

Model: 122586-07

SPECIAL FEATURES

- 1500 hours avg life
- Up to 38% Overall Efficiency
- High efficient cooling system
- Lamb "Green Power Label"
- UL & cUL recognized, category PRGY2 (E47185)
- Class B insulation System

DESCRIPTION

- 42 volts DC
- Two-stage tapered fan
- 6.6" / 162 mm diameter
- Improved sound quality
- "True" tangential discharge bracket
- High-Efficiency "Galaxy" lamination
- Double ball bearings; 10mm output

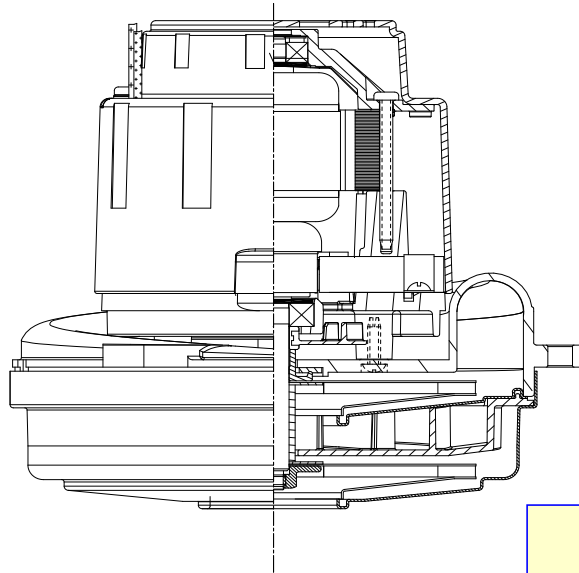

DESIGN APPLICATION

- Commercial and Residential Central Cleaning Systems
- Car wash vac and blower systems
- Equipment operating in environments requiring separation of working air from motor ventilating air
- Designed to handle clean, dry, filtered air only

PEAK AIRWATTS

282

Calculated in accordance with ASTM F2105

TYPICAL MOTOR PERFORMANCE.*

(At 42 volts DC, test data is corrected to standard conditions of 29.92 Hg, 68° F.)

ASTM DATA

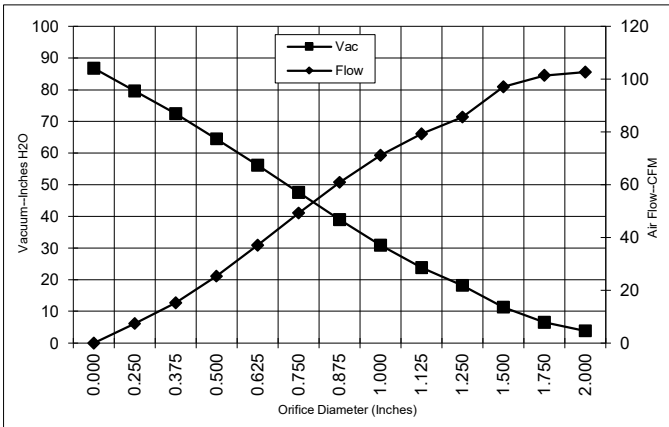

Orifice (Inches)	Amps	Watts (In)	RPM	Vac (In.H ₂ O)	Flow (CFM)	Air Watts
2.000	17.1	718	16828	3.9	102.7	47
1.750	17.2	723	16766	6.5	101.4	77
1.500	17.2	725	16679	11.3	97.1	129
1.250	17.7	746	16582	18.2	85.6	183
1.125	17.8	748	16511	23.8	79.2	221
1.000	17.8	748	16515	31.0	71.1	258
0.875	17.6	740	16580	39.0	60.9	279
0.750	17.2	723	16766	47.5	49.3	275
0.625	16.3	687	17222	56.2	37.1	244
0.500	15.1	636	17948	64.5	25.3	192
0.375	13.5	570	18980	72.5	15.2	129
0.250	12.2	515	20007	79.7	7.4	69
0.000	11.1	470	21096	86.8	0.0	0

METRIC DATA

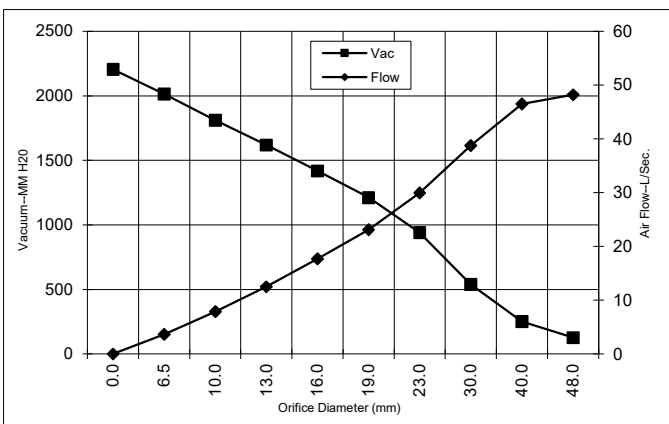

Orifice (mm)	Amps	Watts (In)	RPM	Vac (mm H ₂ O)	Flow (L/Sec)	Air Watts
48.0	17.1	720	16801	127	48.2	60
40.0	17.2	725	16705	251	46.5	114
30.0	17.8	747	16543	540	38.8	204
23.0	17.6	742	16563	940	30.0	274
19.0	17.2	722	16775	1212	23.1	274
16.0	16.3	688	17204	1418	17.7	246
13.0	15.2	641	17876	1618	12.5	197
10.0	13.8	580	18825	1810	7.9	139
6.5	12.3	518	19956	2014	3.7	72
0.0	11.1	470	21096	2204	0.0	0

Note: Metric Performance data is calculated from the ASTM data above.

* Data represents performance of a typical motor sampled from a large production quantity. Individual motor data may vary due to normal manufacturing variations.

Test Specs: 42 VDC	Minimum Sealed Vacuum: 78"	ORIFICE: 7/8"	Minimum Vacuum: 35"	Maximum Watts: 830
--------------------	----------------------------	---------------	---------------------	--------------------

DIMENSIONS

NOTES:

1. LEADS: 14GA, STRANDED, POWER LEADS BLACK.
2. MOTOR IDENTIFICATION: MANUFACTURER'S NAME, MODEL NUMBER, VOLTAGE, FREQUENCY, INSPECTORS CODE WITH "FF" SUFFIX, DATE OF MANUFACTURE, AGENCY RECOGNITION CODE, PLANT LOCATION CODE, PATENT PENDING* AND COUNTRY OF ORIGIN.
3. MOUNTING MUST NOT RESTRICT THIS DIAMETER.
4. ALLOW [0.0026 SQ M]/4.0 SQ IN. (MIN.) FOR COOLING AIR INTAKE.
5. COOLING AIR INTAKE MUST BE SEPARATED FROM COOLING AIR EXHAUST.
6. COOLING AIR EXHAUST MUST BE SEPARATED FROM VACUUM EXHAUST.

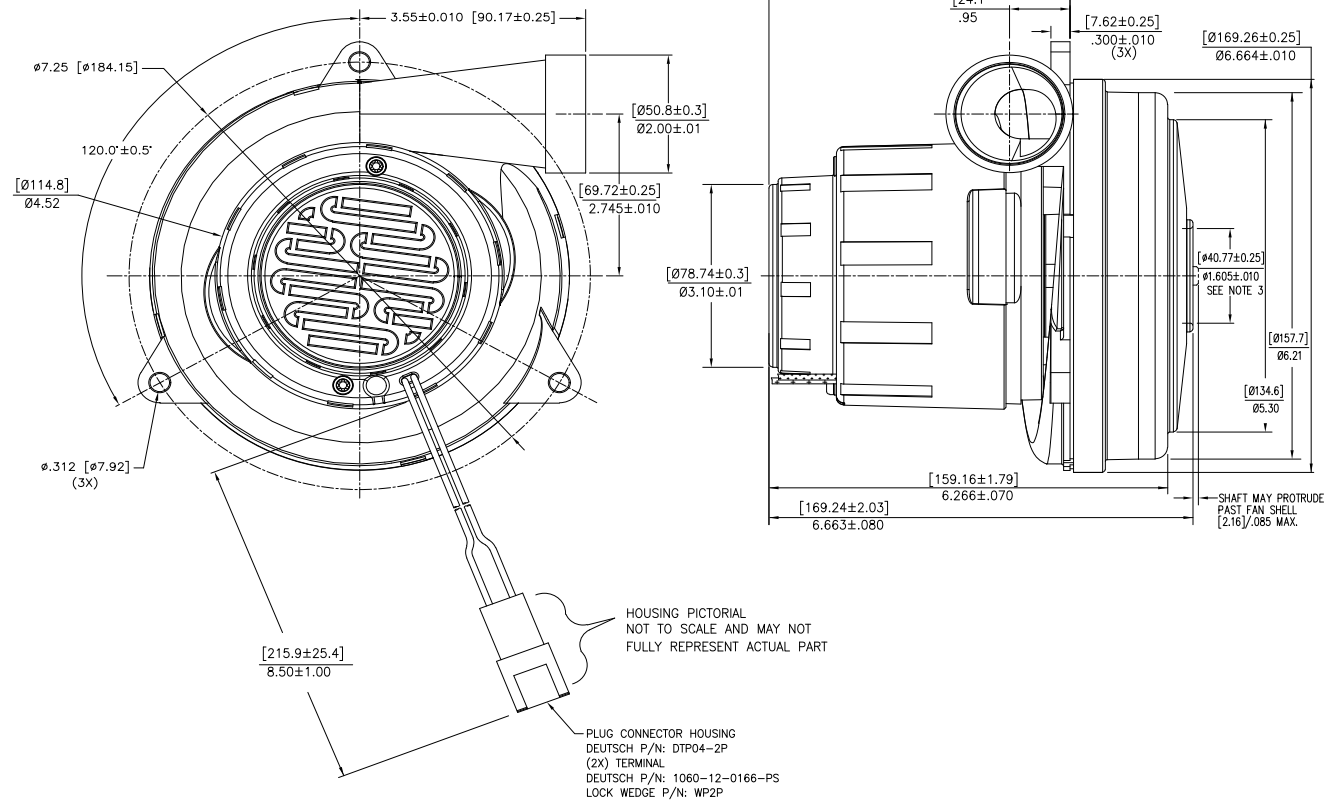

IMPORTANT NOTE: Pictorial and dimensional data are subject to change without notice. Contact factory for current revision levels.

WARNING - When using AMETEK Floorcare & Specialty Motors (F&SM) bypass motors in machines that come in contact with foam, liquid (including water), or other foreign substances, the machine must be designed and constructed to prevent those substances from reaching the fan system, motor housing, and electrical components. F&SM vacuum motors other than hazardous duty models should not be applied in machines that come in contact with dry chemicals or other volatile materials. Failure to observe these precautions could cause flashing (depending on volatility) or electrical shock which could result in property damage and severe bodily injury, including death in extreme cases. All applications incorporating F&SM motors should be submitted to appropriate organizations or agencies for testing specifically related to the safety of your equipment.

AMETEK Dynamic Fluid Solutions
www.ametekdfs.com

Revised: August 2021