



AMETEK

LAMB ELECTRIC

Product Bulletin

Model: 122557-00

DESCRIPTION

- Dual-Tapered Fan System
- 240 Volts
- 5.7" / 145 mm diameter
- Dual ball bearings
- Single speed
- Tangential bypass discharge
- Aluminum fan end bracket
- Thermoset Plastic commutator bracket

DESIGN APPLICATION

- Equipment operating in environments requiring separation of working air from motor ventilating air
- Designed to handle clean, dry, filtered air only

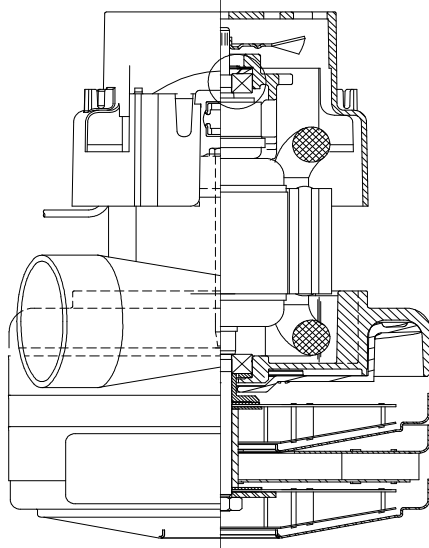

SPECIAL FEATURES

- Suitable for 240 Volts 50/60 Hz
- UL recognized, category PRGY2 (E47185)
- Provision for grounding
- Skeleton frame design
- Dual Tapered fan system
- The Lamb vacuum motor line offers a wide range of performance levels to meet design needs

TYPICAL MOTOR PERFORMANCE.*

(At 240 Volts , 60Hz, test data is corrected to standard conditions of 29.92 Hg, 68° F.)

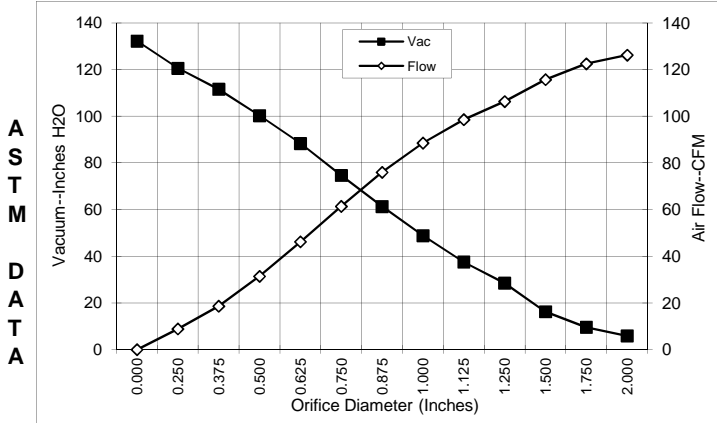

Orifice (Inches)	Amps	Watts (In)	RPM	Vac (In.H2O)	Flow (CFM)	Air Watts
2.000	7.9	1774	23745	5.9	126.2	87
1.750	7.8	1771	23721	9.6	122.5	138
1.500	7.8	1771	23700	16.3	115.7	221
1.250	7.8	1767	23713	28.5	106.3	356
1.125	7.8	1763	23737	37.6	98.6	434
1.000	7.7	1737	23942	48.9	88.5	508
0.875	7.5	1699	24214	61.3	76.0	547
0.750	7.3	1644	24599	74.7	61.4	538
0.625	6.8	1551	25337	88.4	46.2	479
0.500	6.2	1419	26258	100.3	31.4	370
0.375	5.6	1276	27579	111.6	18.6	244
0.250	5.1	1173	28915	120.6	8.9	126
0.000	4.7	1090	30091	132.2	0.0	0

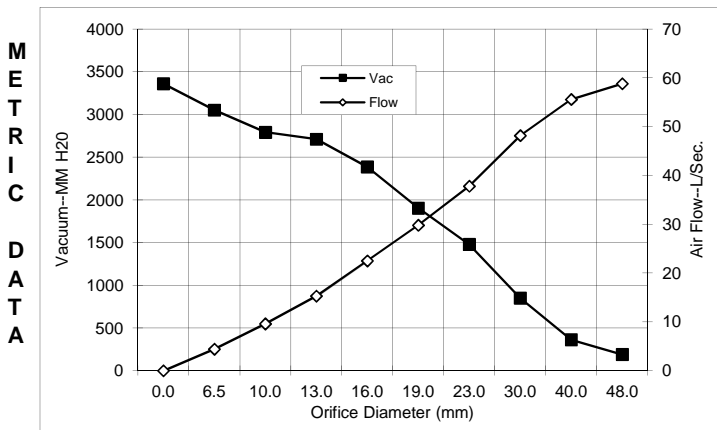

Orifice (mm)	Amps	Watts (In)	RPM	Vac (mm H2O)	Flow (L/Sec)	Air Watts
48.0	7.8	1773	23734	191	58.8	110
40.0	7.8	1771	23706	362	55.6	196
30.0	7.8	1765	23726	850	48.2	399
23.0	7.6	1709	24146	1478	37.8	537
19.0	7.3	1642	24614	1904	29.8	537
16.0	6.9	1555	25307	2385	22.5	481
13.0	6.3	1432	26166	2710	15.3	381
10.0	5.7	1298	27381	2791	9.6	263
6.5	5.1	1178	28848	3051	4.4	132
0.0	4.7	1090	30091	3359	0.0	0

Note: Metric performance data is calculated from the ASTM data above.

* Data represents performance of a typical motor sampled from a large production quantity. Individual motor data may vary to normal manufacturing variations.

Test Specs:	240 volt	Minimum Sealed Vacuum: 130"	ORIFICE: 7/8"	Minimum Vacuum: 58"	Maximum Watts:	1830
-------------	----------	-----------------------------	---------------	---------------------	----------------	------

