



LAMB ELECTRIC

Model: 122512-00

Advantek II - Plus

SPECIAL FEATURES

- Suitable for 120 volt AC operation, 60 Hz
- UL recognized, category PRGY2 (E47185)
- Provision for grounding
- Skeleton-frame construction
- **Patented Advantek II diffusion**
- **Tapered high efficiency fan system**
- **Self Hold (7AM) thermal device**
- The Lamb vacuum motor line offers a wide range of performance levels to meet design needs



DESCRIPTION

- One stage
- 120 volts
- 5.7"145 mm diameter
- Ball/ Ball bearings
- Single speed
- Thru-flow discharge
- Thermoset fan end bracket
- Steel End-bracket

DESIGN APPLICATION

- Equipment operating in environments not requiring separation of working air from motor ventilating air
- Designed to handle clean, dry, filtered air only

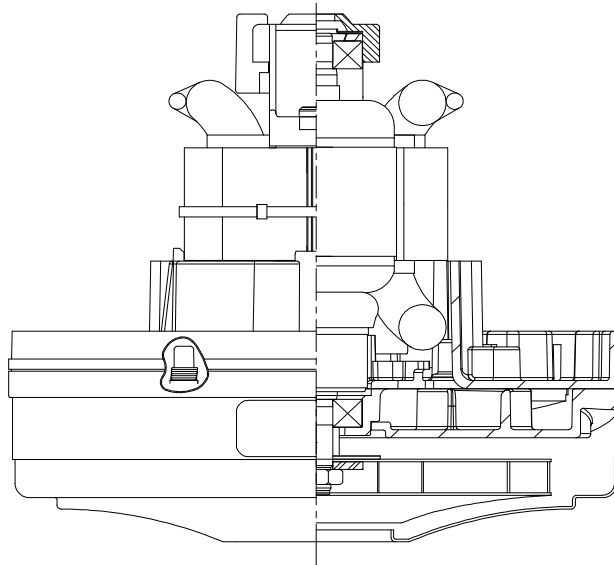

TYPICAL MOTOR PERFORMANCE.*

(At 120 volts, 60Hz, test data is corrected to standard conditions of 29.92 Hg, 68° F.)

ASTM DATA

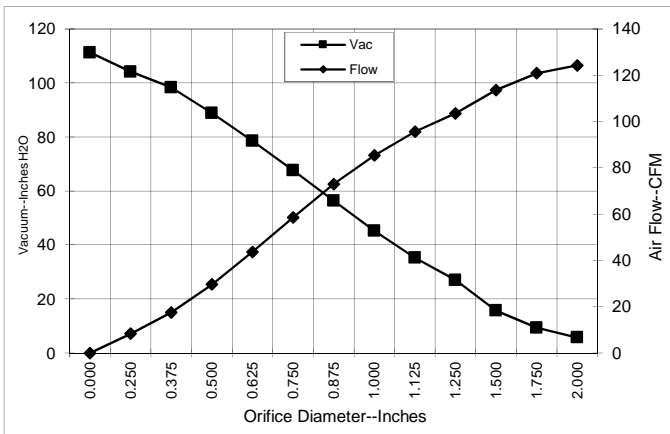

Orifice (Inches)	Amps	Watts (In)	RPM	Vac (In.H2O)	Flow (CFM)	Air Watts
2.000	10.8	1246	28641	5.7	124.3	84
1.750	10.8	1248	28617	9.3	120.9	133
1.500	10.8	1246	28605	15.7	113.6	209
1.250	10.7	1234	28639	27.0	103.5	328
1.125	10.6	1229	28780	35.3	95.6	397
1.000	10.5	1221	29045	45.3	85.3	454
0.875	10.3	1190	29418	56.4	72.9	484
0.750	9.8	1134	30037	67.6	58.5	465
0.625	9.2	1073	31033	78.6	43.6	403
0.500	8.4	983	32595	88.9	29.6	310
0.375	7.5	884	34443	98.4	17.5	203
0.250	6.9	806	35889	104.1	8.3	102
0.000	6.3	744	37482	111.2	0.0	0

METRIC DATA

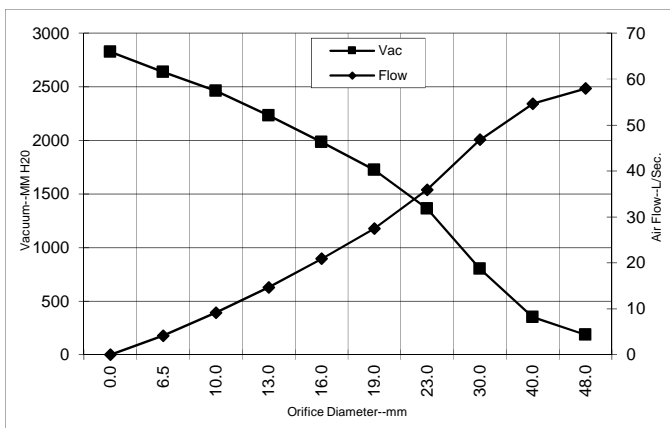

Orifice (mm)	Amps	Watts (In)	RPM	Vac (mm H2O)	Flow (L/Sec)	Air Watts
48.0	10.8	1247	28630	186	57.9	105
40.0	10.8	1247	28609	350	54.7	186
30.0	10.6	1231	28717	801	46.8	366
23.0	10.3	1198	29325	1362	35.9	476
19.0	9.8	1133	30057	1723	27.5	464
16.0	9.2	1075	30993	1984	20.9	406
13.0	8.5	992	32439	2231	14.6	319
10.0	7.7	899	34166	2462	9.1	219
6.5	6.9	810	35817	2638	4.1	107
0.0	6.3	744	37482	2825	0.0	0

Note: Metric performance data is calculated from the ASTM data above.

* Data represents performance of a typical motor sampled from a large production quantity. Individual motor data may vary due to normal manufacturing variations.

Test Specs: 120 volts	Minimum Sealed Vacuum: 108"	ORIFICE: 7/8"	Minimum Vacuum: 54"	Maximum Watts: 1260
------------------------------	------------------------------------	----------------------	----------------------------	----------------------------



DIMENSIONS

NOTES:

1. MODEL NUMBER, DATE OF MANUFACTURE, PLANT LOCATION CODE, AGENCY RECOGNITION CODE, INSPECTOR'S CODE, MANUFACTURER'S NAME, "US PATENT: US 6,703,754 B1", VOLTAGE AND FREQUENCY, AND CUSTOMER'S PART NO. TO APPEAR ON MOTOR.
2. MOUNTING MUST NOT RESTRICT THIS DIAMETER.
3. LEADS: 18GA STRANDED.
4. GROUNDING OR EARTHING PROVISIONS: USE HOLES AS INDICATED FOR GROUNDING OR EARTHING. REFER TO APPROPRIATE LISTING OR REGULATORY AGENCY FOR PROPER METHOD OF GROUNDING OR EARTHING.

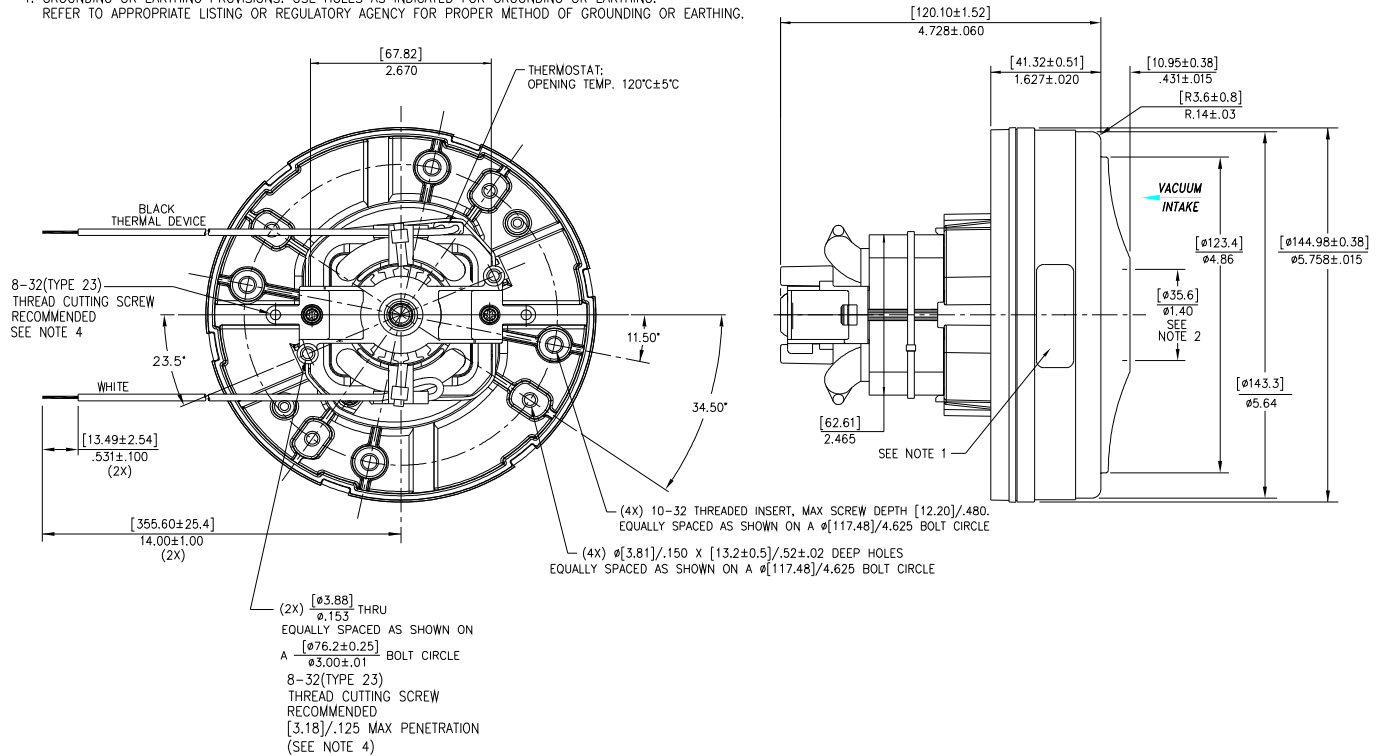

Advantek II - Plus

IMPORTANT NOTE: Pictorial and dimensional data are subject to change without notice. Contact factory for current revision levels.

WARNING - AMETEK Lamb Electric thru-flow vacuum motors must never be used in applications in which wet or moist conditions are involved, where dry chemicals or other volatile materials are present, or where airflow may be restricted or blocked. Such motors are designed to permit the vacuumed air to pass over the electrical winding to cool it. Thus any foam, liquid (including water), dry chemical, or other foreign substance coming in contact with electrical conductors could cause combustion (depending on volatility) or electrical shock. Failure to observe these precautions could result in property damage and severe personal injury, including death in extreme cases. All applications incorporating Lamb Electric motors should be submitted to Underwriters Laboratories Inc. or other appropriate organizations or agencies for testing specifically related to the safety of your equipment.

AMETEK/Floorcare & Specialty Motors
www.ametekfsm.com