



# AMETEK LAMB ELECTRIC

## Product Bulletin

Model: 122471-25

### DESCRIPTION

- Double stage
- 120 volts
- 5.7" / 145 mm diameter
- Dual ball bearings
- Single speed
- Tangential bypass discharge
- Thermoset Fan End Bracket
- Thermoset commutator bracket

### DESIGN APPLICATION

- Equipment operating in environments requiring separation of working air from motor ventilating air
- Designed to handle clean, dry, filtered air only

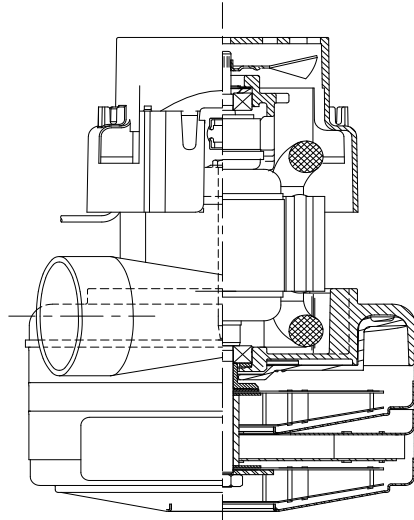

### SPECIAL FEATURES

- 1K+ Hours
- Suitable for 120 volt AC operation, 50/60 Hz
- cRUus recognized, category PRGY2/8 (E47185)
- Provision for grounding
- Skeleton frame design
- Dual Tapered fan system



**PEAK AIRWATTS**

**565**

Calculated in accordance with ASTM F2105

## Preliminary Bulletin

### TYPICAL MOTOR PERFORMANCE.\*

(At 120 volts, 60Hz, test data is corrected to standard conditions of 29.92 Hg, 68° F.)

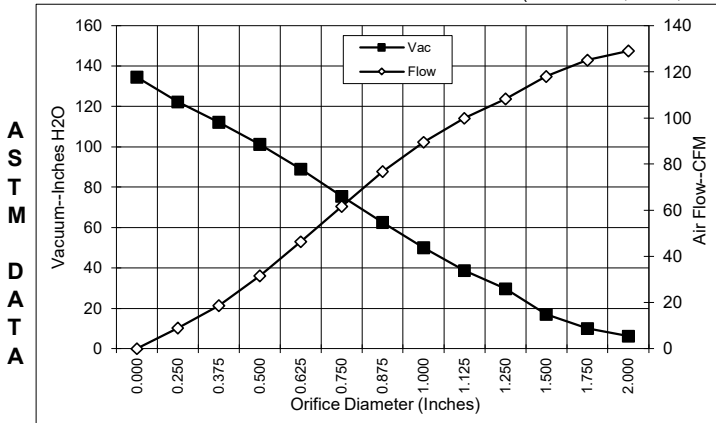

Orifice (Inches)	Amps	Watts (In)	RPM	Vac (In.H2O)	Flow (CFM)	Air Watts
2.000	15.0	1736	23460.04	6.2	129.1	94
1.750	15.1	1745	23442.25	10.0	125.1	147
1.500	15.1	1752	23389.31	17.0	118.0	235
1.250	15.1	1752	23400.54	29.6	108.3	376
1.125	15.0	1742	23486.77	38.6	99.9	453
1.000	14.8	1712	23636.84	50.0	89.5	525
0.875	14.5	1685	23833.99	62.5	76.7	563
0.750	14.0	1623	24314.8	75.4	61.7	546
0.625	13.1	1528	25131.98	88.9	46.4	484
0.500	12.1	1413	26209.96	101.1	31.5	374
0.375	10.9	1284	27616.18	112.1	18.7	246
0.250	9.8	1162	29155.78	122.2	8.9	128
0.000	9.1	1077	30404.97	134.4	0.0	0

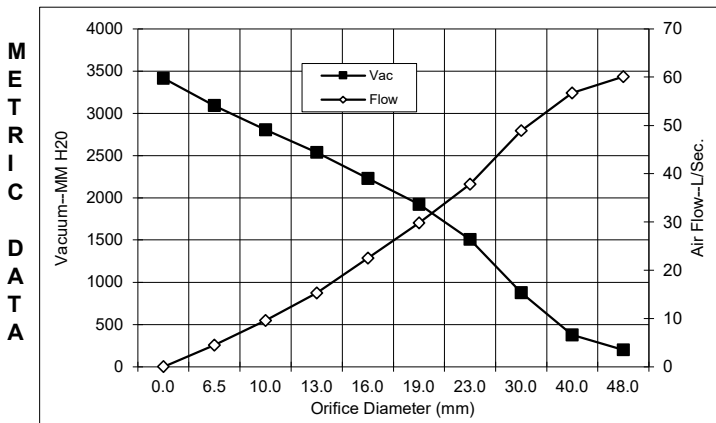

Orifice (mm)	Amps	Watts (In)	RPM	Vac (mm H2O)	Flow (L/Sec)	Air Watts
48.0	15.0	1740	23452	200	60.1	117
40.0	15.1	1750	23405	378	56.7	208
30.0	15.1	1747	23448	878	48.9	418
23.0	14.6	1692	23785	1509	37.8	515
19.0	13.9	1621	24331	1922	29.8	528
16.0	13.1	1532	25099	2230	22.5	470
13.0	12.2	1424	26102	2537	15.3	385
10.0	11.1	1304	27405	2806	9.6	265
6.5	9.9	1168	29079	3092	4.4	134
0.0	9.1	1077	30405	3414	0.0	0

Note: Metric performance data is calculated from the ASTM data above.

\* Data represents performance of a typical motor sampled from a large production quantity. Individual motor data may vary to normal manufacturing variations.

Test Specs:	120 volt	Minimum Sealed Vacuum: 134"	ORIFICE: 7/8"	Minimum Vacuum: 60"	Maximum Watts: 1850
-------------	----------	-----------------------------	---------------	---------------------	---------------------

