



LAMB ELECTRIC

Model: 122439-45

SPECIAL FEATURES

- Suitable for 120 volt AC operation, 50/ 60 Hz
- UL & cUL recognized, category PRGY2 (E47185)
- cUL equivalent to CSA
- Ground wire with terminal
- Open frame design
- 10mm shaft and bearing system
- Aluminum fan end bracket designed to dampen vibration and improve durability
- The Lamb Electric vacuum motor line offers a wide range of performance levels to meet design needs
- Thermally protected against locked rotor condition.
- 45 Includes customer specific #

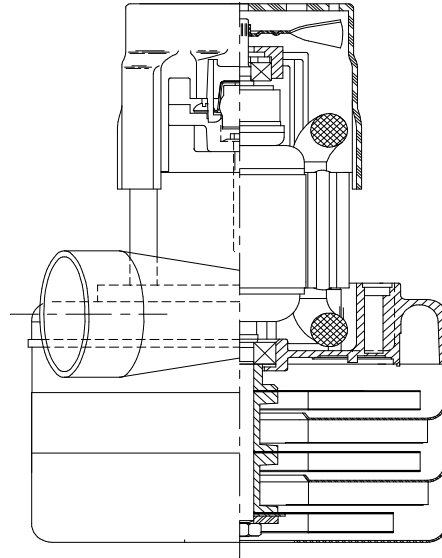

DESCRIPTION

- Three stage
- 120 Volt
- 5.7"/145 mm diameter
- Double ball bearings
- Single speed
- Tangential bypass discharge
- Aluminum fan end bracket
- Aluminum commutator bracket

DESIGN APPLICATION

- Equipment operating in environments requiring separation of working air from motor ventilating air
- Designed to handle clean, dry, filtered air only

TYPICAL MOTOR PERFORMANCE.*

(At 120 volts, 60Hz, test data is corrected to standard conditions of 29.92 Hg, 68° F.)

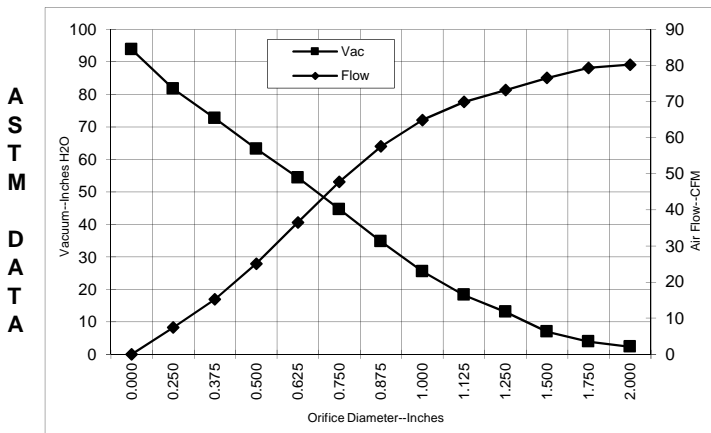

Orifice (Inches)	Amps	Watts (In)	RPM	Vac (In.H2O)	Flow (CFM)	Air Watts
2.000	6.3	722	15392	2.3	80.2	22
1.750	6.3	721	15386	3.9	79.3	36
1.500	6.4	722	15355	6.9	76.6	62
1.250	6.4	727	15312	13.1	73.2	112
1.125	6.4	731	15280	18.3	69.9	150
1.000	6.5	736	15223	25.5	64.9	195
0.875	6.5	735	15228	34.7	57.6	235
0.750	6.4	722	15367	44.6	47.8	250
0.625	6.1	691	15739	54.4	36.5	233
0.500	5.6	647	16374	63.3	25.1	186
0.375	5.2	597	17184	72.6	15.2	130
0.250	4.8	553	18019	81.7	7.5	72
0.000	4.4	520	18851	93.8	0.0	0

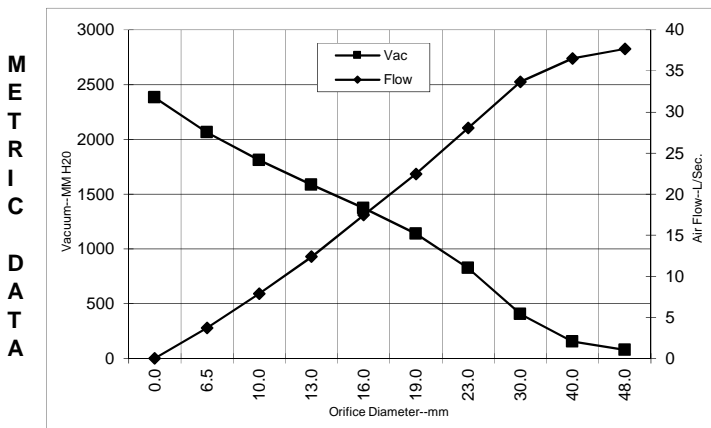

Orifice (mm)	Amps	Watts (In)	RPM	Vac (mm H2O)	Flow (L/Sec)	Air Watts
48.0	6.3	722	15389	77	37.7	28
40.0	6.4	722	15364	153	36.5	54
30.0	6.4	729	15294	404	33.7	133
23.0	6.5	735	15227	824	28.0	225
19.0	6.4	721	15374	1138	22.4	250
16.0	6.1	692	15724	1372	17.4	234
13.0	5.7	651	16310	1584	12.4	191
10.0	5.2	605	17062	1809	7.9	138
6.5	4.8	556	17977	2064	3.7	75
0.0	4.4	520	18851	2383	0.0	0

Note: Metric performance data is calculated from the ASTM data above.

* Data represents performance of a typical motor sampled from a large production quantity. Individual motor data may vary due to normal manufacturing variations.

Test Specs:	120 volts	Minimum Sealed Vacuum: 91"	ORIFICE:	7/8 "	Minimum Watts:	520	Maximum Watts:	840
--------------------	-----------	-----------------------------------	-----------------	-------	-----------------------	-----	-----------------------	-----

DIMENSIONS

NOTES:

- LEADS: 18 GA. STRANDED, LEADS CAN BE ANY COLOR EXCEPT GREEN OR GREEN WITH YELLOW STRIPE.
- GROUNDING OR EARTHING PROVISIONS: USE HOLES AS INDICATED FOR GROUNDING OR EARTHING. REFER TO APPROPRIATE LISTING OR REGULATORY AGENCY FOR PROPER METHOD OF GROUNDING OR EARTHING.

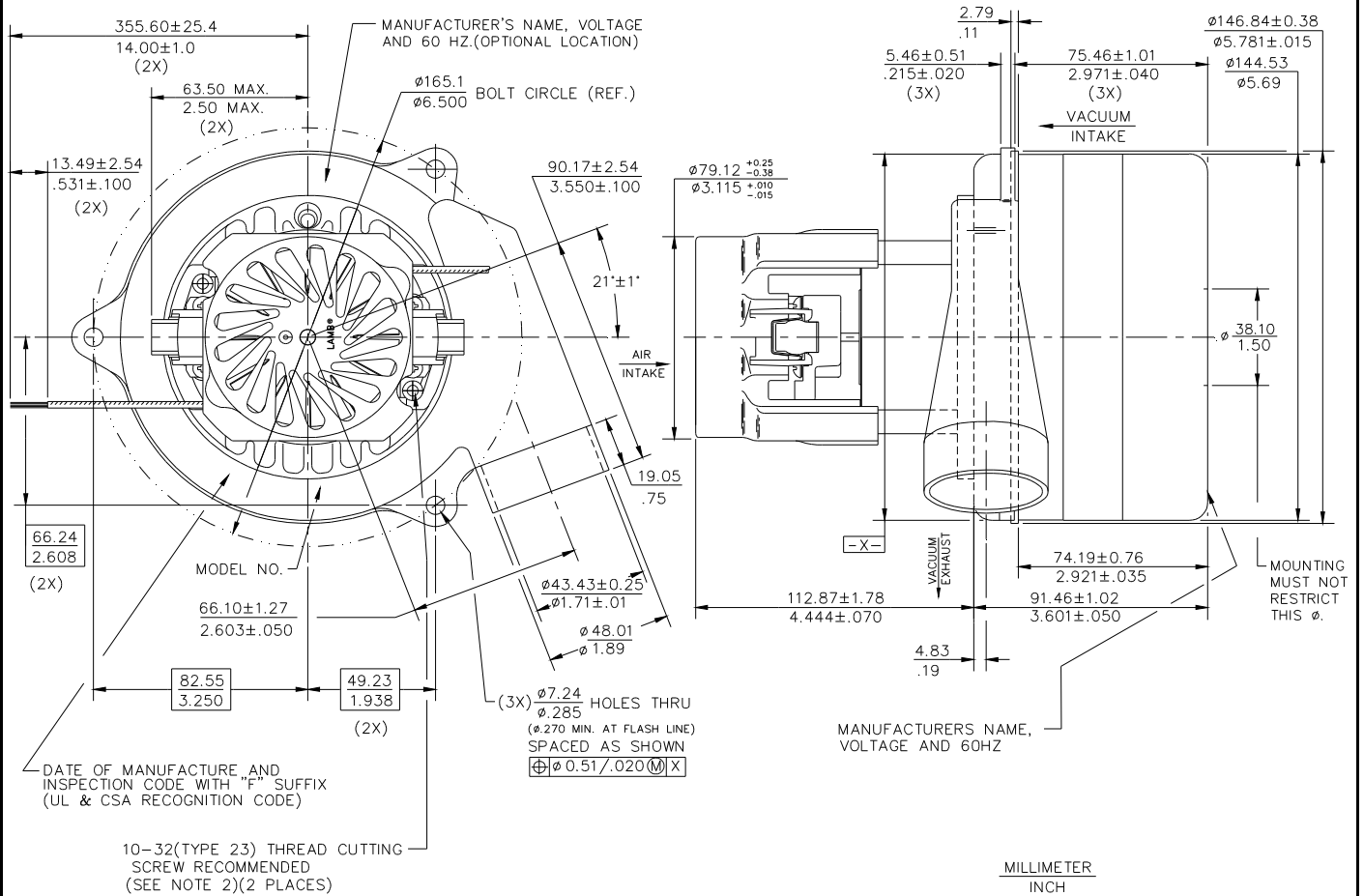

IMPORTANT NOTE: Pictorial and dimensional data are subject to change without notice. Contact factory for current revision levels.

WARNING - When using AMETEK Lamb Electric bypass motors in machines that come in contact with foam, liquid (including water), or other foreign substances, the machine must be designed and constructed to prevent those substances from reaching the fan system, motor housing, and electrical components. Lamb Electric vacuum motors other than hazardous duty models should not be applied in machines that come in contact with dry chemicals or other volatile materials. Failure to observe these precautions could cause flashing (depending on volatility) or electrical shock which could result in property damage and severe bodily injury, including death in extreme cases. All applications incorporating Lamb Electric motors should be submitted to appropriate organizations or agencies for testing specifically related to the safety of your equipment.

AMETEK/Floorcare & Specialty Motors
www.ametekfsm.com