



**LAMB ELECTRIC**

**Model: 122438-45**

**SPECIAL FEATURES**

- Suitable for 120 volt AC operation, 50/ 60 Hz
- UL & cUL recognized, category PRGY2 (E47185)
- cUL equivalent to CSA
- Ground wire with terminal
- Open frame design
- 10mm shaft and bearing system
- Aluminum fan end bracket designed to dampen vibration and improve durability
- The Lamb Electric vacuum motor line offers a wide range of performance levels to meet design needs
- Thermally protected against locked rotor condition.
- 45 Includes customer specific #
- 40 is for general usage.

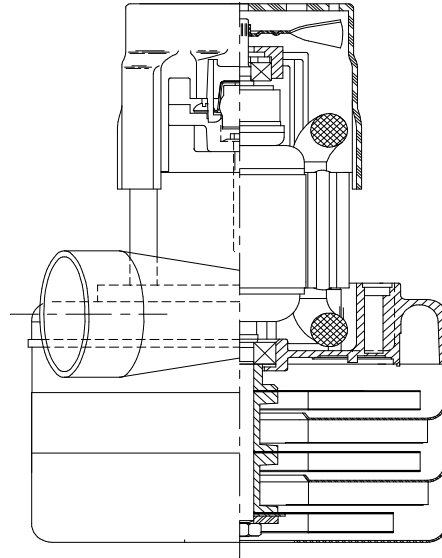

**DESCRIPTION**

- Three stage
- 120 Volt
- 5.7"/145 mm diameter
- Double ball bearings
- Single speed
- Tangential bypass discharge
- Aluminum fan end bracket
- Aluminum commutator bracket

**DESIGN APPLICATION**

- Equipment operating in environments requiring separation of working air from motor ventilating air
- Designed to handle clean, dry, filtered air only

**TYPICAL MOTOR PERFORMANCE.\***

(At 120 volts, 60Hz, test data is corrected to standard conditions of 29.92 Hg, 68° F.)

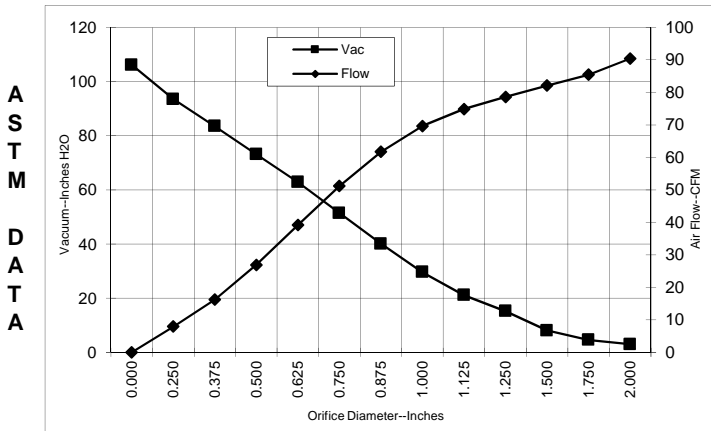

Orifice (Inches)	Amps	Watts (In)	RPM	Vac (In.H2O)	Flow (CFM)	Air Watts
2.000	8.3	927	16595	3.0	90.4	32
1.750	8.3	926	16599	4.6	85.5	46
1.500	8.3	926	16588	8.0	82.1	77
1.250	8.3	928	16555	15.2	78.6	140
1.125	8.3	933	16518	21.1	74.9	185
1.000	8.3	933	16479	29.6	69.6	242
0.875	8.3	933	16511	40.1	61.7	290
0.750	8.2	918	16646	51.4	51.2	309
0.625	7.8	877	17065	62.9	39.2	289
0.500	7.2	814	17750	73.1	26.9	231
0.375	6.5	747	18599	83.5	16.3	159
0.250	6.0	688	19513	93.5	7.9	87
0.000	5.5	641	20323	106.2	0.0	0

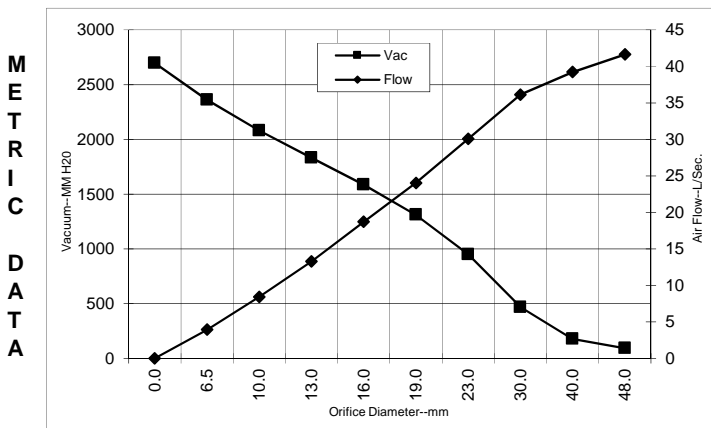

Orifice (mm)	Amps	Watts (In)	RPM	Vac (mm H2O)	Flow (L/Sec)	Air Watts
48.0	8.3	926	16597	93	41.6	38
40.0	8.3	926	16591	177	39.2	68
30.0	8.3	931	16535	469	36.1	165
23.0	8.3	933	16503	951	30.1	278
19.0	8.2	917	16654	1312	24.0	308
16.0	7.8	879	17049	1586	18.7	290
13.0	7.2	820	17681	1832	13.3	237
10.0	6.6	757	18472	2082	8.4	170
6.5	6.0	691	19467	2361	3.9	91
0.0	5.5	641	20323	2697	0.0	0

Note: Metric performance data is calculated from the ASTM data above.

\* Data represents performance of a typical motor sampled from a large production quantity. Individual motor data may vary due to normal manufacturing variations.

<b>Test Specs:</b>	120 volts	<b>Minimum Sealed Vacuum:</b> 102"	<b>ORIFICE:</b>	7/8 "	<b>Minimum Vacuum:</b> 37.5"	<b>Maximum Watts:</b>	1050
--------------------	-----------	------------------------------------	-----------------	-------	------------------------------	-----------------------	------

**DIMENSIONS**

NOTES:

- LEADS: 18 GA. STRANDED, LEADS CAN BE ANY COLOR EXCEPT GREEN OR GREEN WITH YELLOW STRIPE.
- GROUNDING OR EARTHING PROVISIONS: USE HOLES AS INDICATED FOR GROUNDING OR EARTHING. REFER TO APPROPRIATE LISTING OR REGULATORY AGENCY FOR PROPER METHOD OF GROUNDING OR EARTHING.

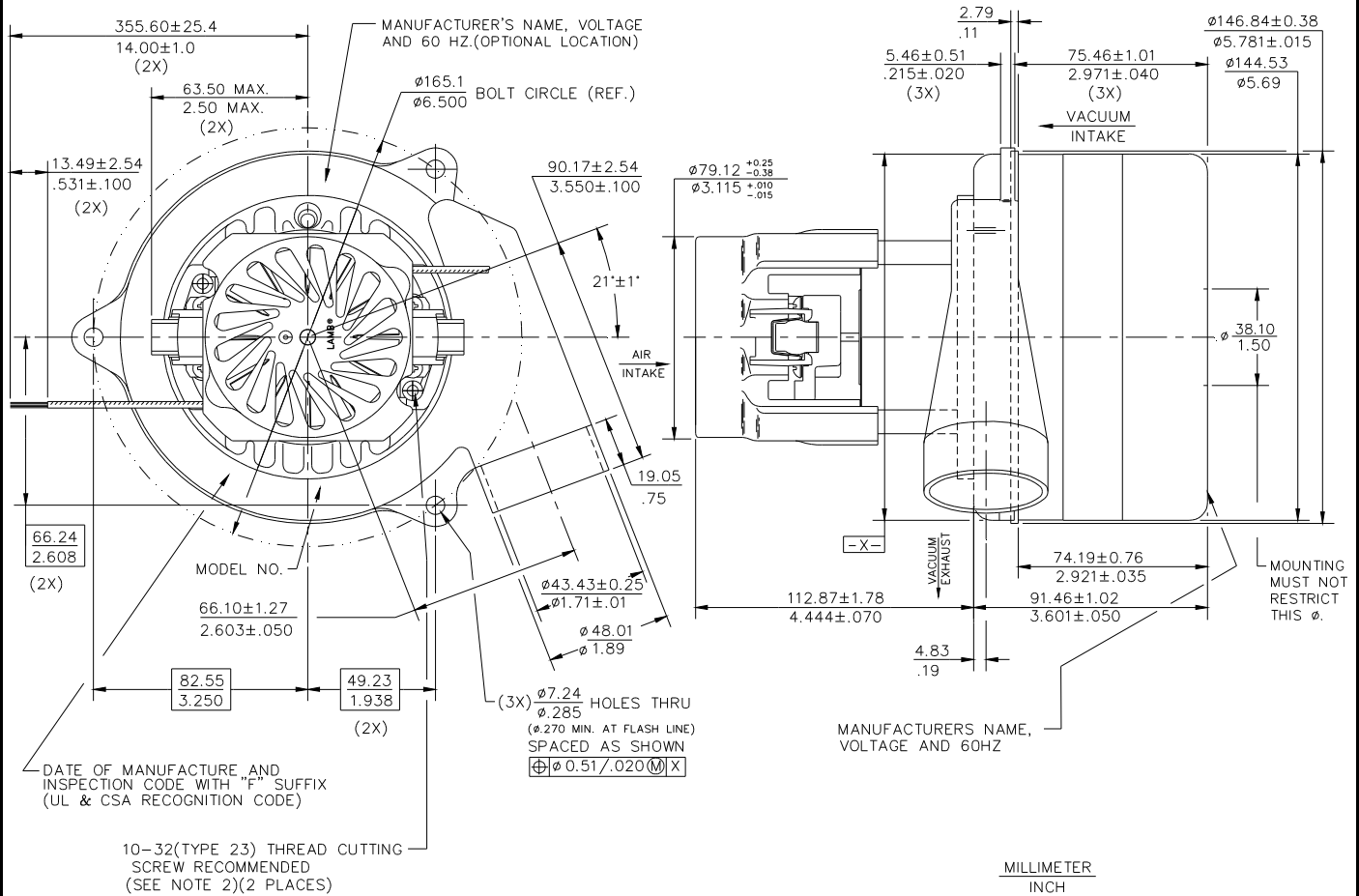

**IMPORTANT NOTE:** Pictorial and dimensional data are subject to change without notice. Contact factory for current revision levels.

**WARNING** - When using AMETEK Lamb Electric bypass motors in machines that come in contact with foam, liquid (including water), or other foreign substances, the machine must be designed and constructed to prevent those substances from reaching the fan system, motor housing, and electrical components. Lamb Electric vacuum motors other than hazardous duty models should not be applied in machines that come in contact with dry chemicals or other volatile materials. Failure to observe these precautions could cause flashing (depending on volatility) or electrical shock which could result in property damage and severe bodily injury, including death in extreme cases. All applications incorporating Lamb Electric motors should be submitted to appropriate organizations or agencies for testing specifically related to the safety of your equipment.

**AMETEK/Floorcare & Specialty Motors**  
[www.ametekfsm.com](http://www.ametekfsm.com)