



**LAMB ELECTRIC**

**Advantek II - Ultra**

**Model: 122287-08**

**DESCRIPTION**

- Two stage
- 120 volts
- 5.7"/145 mm diameter
- Double ball bearings
- Single speed
- Thru-flow discharge
- Thermoset fan end bracket
- Stamped steel top end bracket

**DESIGN APPLICATION**

- Equipment operating in environments not requiring separation of working air from motor ventilating air
- Designed to handle clean, dry, filtered air only

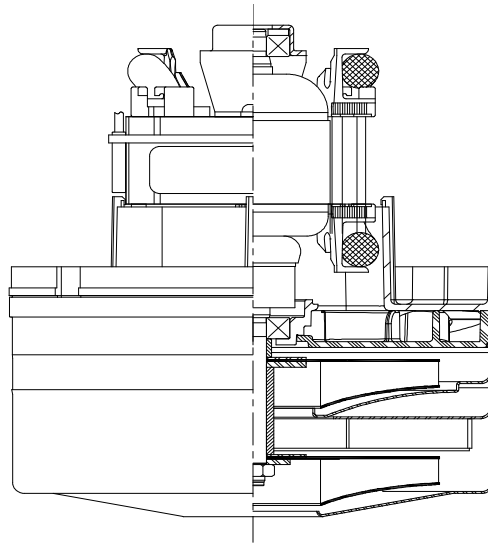

**SPECIAL FEATURES**

- Suitable for 120 volt AC operation, 60 Hz
- UL recognized, category PRGY2 (E47185)
- Provision for grounding
- Skeleton-frame construction
- Tapered High efficiency fan system
- Thermal Device
- The Lamb Electric vacuum motor line offers a wide range of performance levels to meet design needs
- Class B insulation
- The -08 version includes leads



**TYPICAL MOTOR PERFORMANCE.\***

(At 120 volts, 60Hz, test data is corrected to standard conditions of 29.92 Hg, 68° F.)

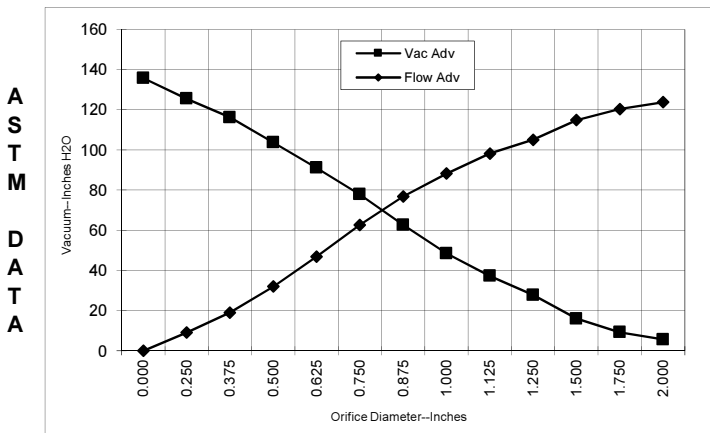

Orifice (Inches)	Amps	Watts (In)	RPM	Vac (In.H2O)	Flow (CFM)	Air Watts
2.000	13.2	1542	23960	5.7	123.8	83
1.750	13.2	1529	23945	9.1	119.5	128
1.500	13.1	1517	23950	15.4	112.7	204
1.250	12.8	1489	23955	27.0	103.8	330
1.125	12.8	1489	23975	35.7	96.3	404
1.000	12.7	1475	24220	47.6	87.5	490
0.875	12.5	1451	24465	61.9	76.3	555
0.750	11.9	1390	25050	76.4	62.1	557
0.625	11.2	1305	26040	90.1	46.7	494
0.500	10.1	1173	27095	101.4	31.6	376
0.375	8.9	1046	28680	112.8	18.7	248
0.250	8.1	958	30400	123.2	9.0	130
0.000	7.5	891	31900	133.6	0.0	0

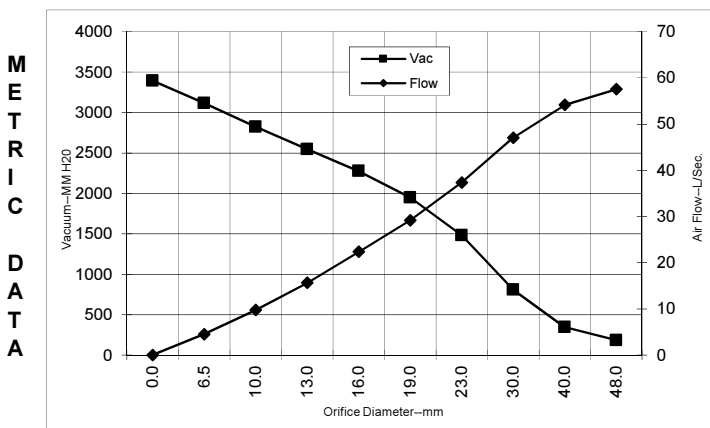

Orifice (mm)	Amps	Watts (In)	RPM	Vac (mm H2O)	Flow (L/Sec)	Air Watts
48.0	13.2	1536	23953	182	57.5	103
40.0	13.1	1521	23949	343	54.2	181
30.0	12.8	1489	23966	807	47.0	371
23.0	12.5	1457	24404	1481	37.3	539
19.0	11.9	1388	25070	1948	29.2	556
16.0	11.2	1308	26000	2275	22.3	497
13.0	10.2	1186	26990	2547	15.6	388
10.0	9.1	1065	28442	2822	9.7	267
6.5	8.2	962	30314	3116	4.5	136
0.0	7.5	891	31900	3393	0.0	0

Note: Metric Performance data is calculated from the ASTM data above.

\* Data represents performance of a typical motor sampled from a large production quantity. Individual motor data may vary due to normal manufacturing variations.

<b>Test Specs:</b>	120 volts	<b>Minimum Sealed Vacuum:</b>	123.0	<b>ORIFICE:</b>	7/8 "	<b>Minimum Vacuum:</b>	59"	<b>Maximum Watts:</b>	1470
--------------------	-----------	-------------------------------	-------	-----------------	-------	------------------------	-----	-----------------------	------

