



LAMB ELECTRIC

Model: 12221-00

DESCRIPTION

- Four stage
- 120 volts
- 5.7"/145 mm diameter
- Double ball bearings
- Single speed
- Tangential bypass discharge
- Aluminum fan end bracket
- Aluminum commutator bracket

DESIGN APPLICATION

- Equipment operating in environments requiring separation of working air from motor ventilating air
- Designed to handle clean, dry, filtered air only

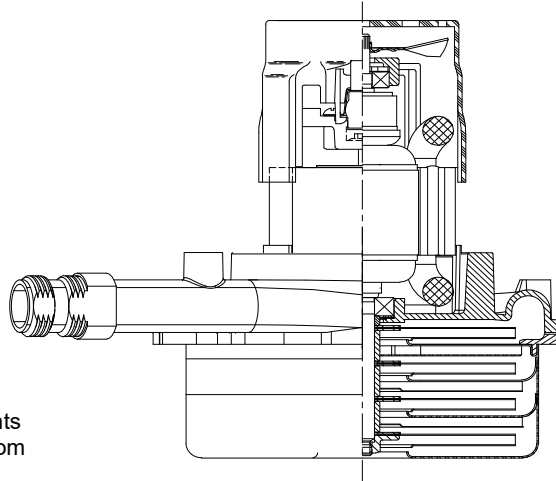

SPECIAL FEATURES

- Suitable for 120 volt AC operation, 50/ 60 Hz
- RU recognized, category PRGY2 (E47185)
- Class B Insulation
- Provision for grounding
- 10mm shaft and bearing system
- Aluminum fan end bracket designed to dampen vibration and improve durability
- The Lamb Electric vacuum motor line offers a wide range of performance levels to meet design needs

**Confidential Information
Proprietary to Ametek**

TYPICAL MOTOR PERFORMANCE.*

(At 120 volts, 60Hz, test data is corrected to standard conditions of 29.92 Hg, 68° F.)

ASTM DATA

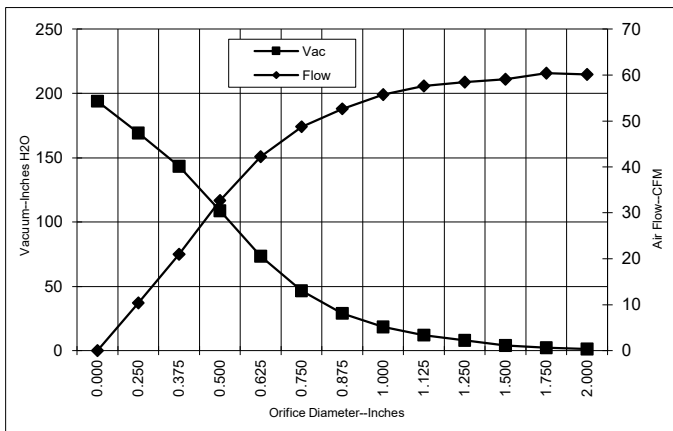

Orifice (Inches)	Amps	Watts (In)	RPM	Vac (In.H2O)	Flow (CFM)	Air Watts
2.000	14.9	1689	21852	1.3	60.1	9.1
1.750	14.8	1676	21801	2.2	60.4	15.8
1.500	14.8	1677	21785	4.1	59.1	28.1
1.250	14.8	1681	21786	8.1	58.4	55.7
1.125	14.8	1673	21815	12.1	57.6	81.9
1.000	14.8	1680	21834	18.5	55.7	120.9
0.875	14.7	1669	21883	28.9	52.7	178.6
0.750	14.7	1667	21967	46.5	48.8	266.4
0.625	14.5	1642	22105	73.5	42.2	364.2
0.500	14.1	1601	22470	108.7	32.7	417.1
0.375	12.9	1474	23403	143.3	21.0	352.4
0.250	11.4	1309	24957	169.2	10.4	205.7
0.000	9.6	1117	27097	194.0	0.0	0.0

METRIC DATA

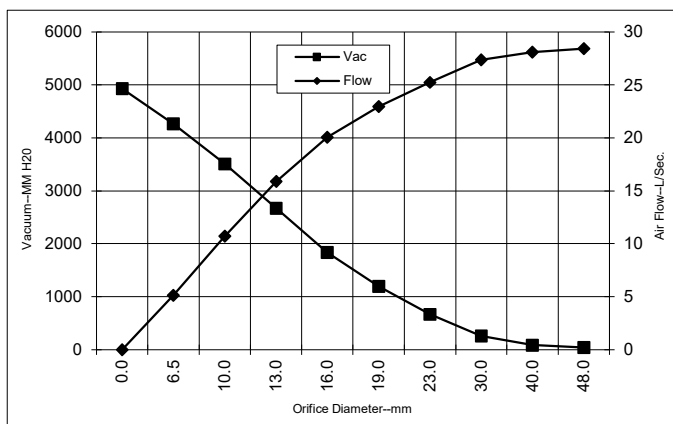

Orifice (mm)	Amps	Watts (In)	RPM	Vac (mm H2O)	Flow (L/Sec)	Air Watts
48.0	14.9	1683	21830	43.3	28.4	12.1
40.0	14.8	1677	21790	89.1	28.1	24.4
30.0	14.8	1676	21802	262.1	27.4	70.1
23.0	14.8	1672	21871	667.8	25.2	164.2
19.0	14.7	1666	21969	1196.0	23.0	268.3
16.0	14.5	1643	22100	1839.0	20.1	360.3
13.0	14.1	1605	22434	2671.8	15.9	411.8
10.0	13.1	1493	23263	3508.3	10.7	362.1
6.5	11.5	1317	24879	4265.1	5.1	213.0
0.0	9.6	1117	27097	4927.2	0.0	0.0

Note: Metric performance data is calculated from the ASTM data above.

* Data represents performance of a typical motor sampled from a large production quantity. Individual motor data may vary due to normal manufacturing variations.

Test Specs:	120 volts	Minimum Sealed Vacuum:	180"	ORIFICE:	3/8"	Minimum Vacuum:	125"	Maximum Watts:	1611
--------------------	-----------	-------------------------------	------	-----------------	------	------------------------	------	-----------------------	------

