



AMETEK LAMB ELECTRIC

Product Bulletin

Model: 119710-00

DESCRIPTION

- Two stage
- 230 volts
- 5.7" / 145 mm diameter
- Dual ball bearings
- Single speed
- Tangential bypass discharge
- Aluminum fan end bracket
- Aluminum commutator bracket

DESIGN APPLICATION

- Equipment operating in environments requiring separation of working air from motor ventilating air
- Designed to handle clean, dry, filtered air only

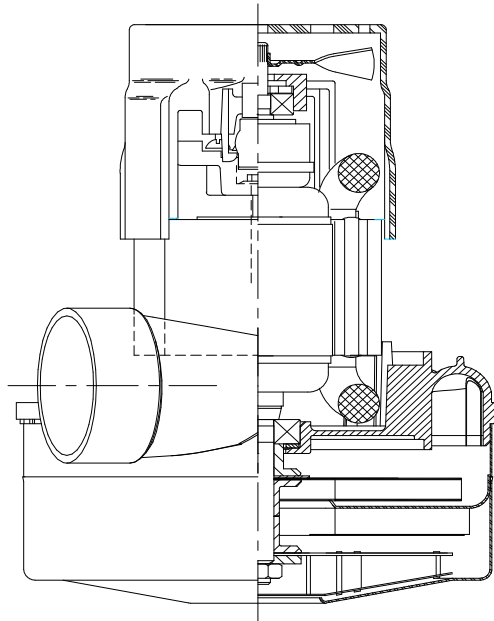

SPECIAL FEATURES

- Suitable for 230 volt AC operation, 50/60 Hz
 - UL recognized, category PRGY2 (E47185)
 - Provision for grounding
 - Skeleton frame design
 - Tapered fan system
- The Lamb vacuum motor line offers a wide range of performance levels to meet design needs



TYPICAL MOTOR PERFORMANCE.*

(At 230 volts, 60Hz, test data is corrected to standard conditions of 29.92 Hg, 68° F.)

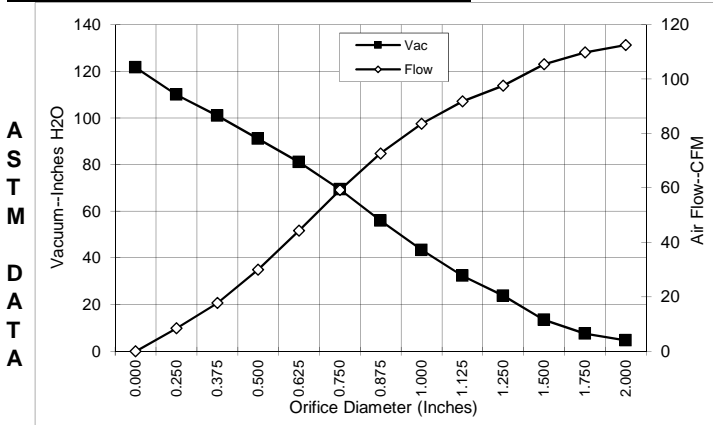

Orifice (Inches)	Amps	Watts (In)	RPM	Vac (In.H ₂ O)	Flow (CFM)	Air Watts
2.000	6.9	1529	22,083	4.7	112.5	62
1.750	6.9	1530	22,073	7.6	109.8	98
1.500	6.9	1532	22,060	13.4	105.4	166
1.250	6.9	1533	22,040	23.8	97.6	273
1.125	6.9	1532	22,026	32.4	91.8	349
1.000	6.9	1520	22,126	43.4	83.6	426
0.875	6.8	1496	22,310	56.0	72.7	478
0.750	6.5	1442	22,690	69.4	59.2	483
0.625	6.1	1362	23,370	81.1	44.3	422
0.500	5.7	1265	24,263	91.0	30.0	321
0.375	5.2	1161	25,426	100.9	17.8	211
0.250	4.7	1063	26,450	110.0	8.5	110
0.000	4.4	989	27,650	121.6	0.0	0

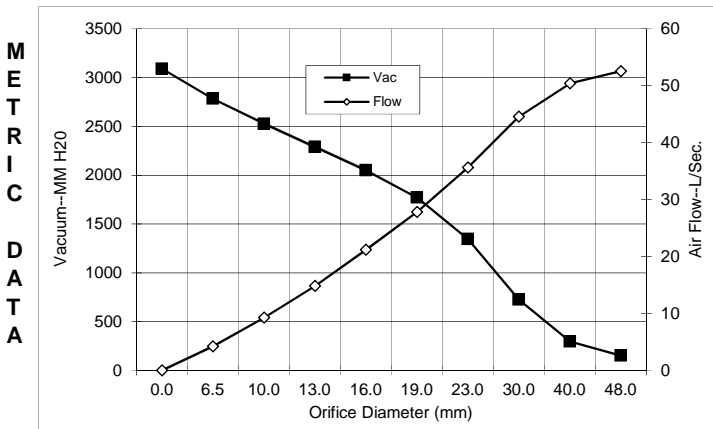

Orifice (mm)	Amps	Watts (In)	RPM	Vac (mm H ₂ O)	Flow (L/Sec)	Air Watts
48.0	6.9	1529	22079	151	52.5	78
40.0	6.9	1531	22064	296	50.4	146
30.0	6.9	1532	22032	725	44.6	315
23.0	6.8	1502	22264	1342	35.6	465
19.0	6.5	1440	22704	1769	27.8	482
16.0	6.2	1365	23343	2048	21.2	424
13.0	5.7	1275	24174	2286	14.8	331
10.0	5.3	1177	25252	2525	9.3	228
6.5	4.8	1068	26399	2782	4.2	115
0.0	4.4	989	27650	3089	0.0	0

Note: Metric performance data is calculated from the ASTM data above.

* Data represents performance of a typical motor sampled from a large production quantity. Individual motor data may vary to normal manufacturing variations.

Test Specs:	230 Volts	Minimum Sealed Vacuum:	111.0"	ORIFICE: 7/8"	Minimum Vacuum:	52.0"	Maximum Watts:	1600
-------------	-----------	------------------------	--------	---------------	-----------------	-------	----------------	------

DIMENSIONS

NOTES:

1. LEADS: 18GA STRANDED, LEADS CAN BE ANY COLOR EXCEPT GREEN OR GREEN WITH YELLOW STRIPE.
2. GROUNDING OR EARTHING PROVISIONS: USE HOLES AS INDICATED FOR GROUNDING OR EARTHING. REFER TO APPROPRIATE LISTING OR REGULATORY AGENCY FOR PROPER METHOD OF GROUNDING OR EARTHING.
3. MOTOR IDENTIFICATION: MANUFACTURER'S NAME, MODEL NUMBER, VOLTAGE, FREQUENCY, INSPECTORS CODE, DATE OF MANUFACTURE. AGENCY RECOGNITION CODE, PLANT LOCATION CODE, PATENT INFORMATION, "ONE OR MORE OF THE FOLLOWING PATENTS APPLY TO THIS MOTOR: 5482378; 5736805; 4669952; 4684835". AND MADE IN THE USA.
4. ALLOW 10.0016 SQ MM/2.5 SQ IN. MIN. FOR COOLING AIR INTAKE.
5. COOLING AIR INTAKE MUST BE SEPERATED FROM COOLING AIR EXHAUST.
6. VACUUM EXHAUST MUST BE SEPERATED FROM COOLING EXHAUST.
7. MOUNTING MUST NOT RESTRICT THIS DIAMETER.

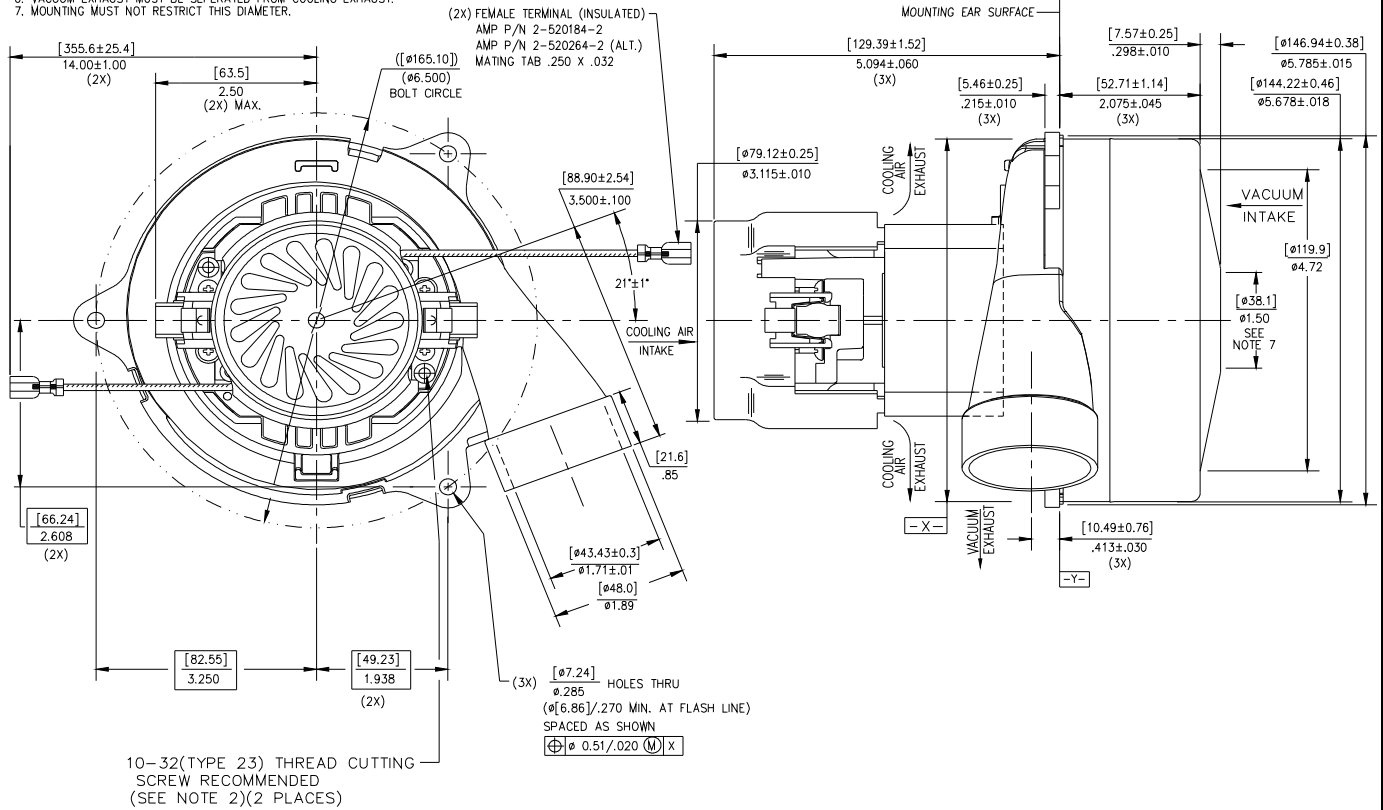

IMPORTANT NOTE: Pictorial and dimensional data are subject to change without notice. Contact factory for current revision levels.

WARNING - When using AMETEK/Lamb Electric bypass motors in machines that come in contact with foam, liquid (including water) of other foreign substances, the machine must be designed and constructed to prevent those substances from reaching the fan system, motor housing and electrical components. Lamb vacuum motors other than hazardous duty models should not be applied in machines that come in contact with dry chemicals or other volatile materials. Failure to observe these precautions could cause flashing (depending on volatility) or electrical shock which could result in property damage and severe bodily injury, including death in extreme cases. All applications incorporating Lamb motors should be submitted to appropriate organizations or agencies for testing specifically related to the safety of your equipment.

AMETEK/Floorcare & Specialty Motors
www.ametekfsm.com